

GROVE GEAR

Stainless Steel Worm Gear Reducers

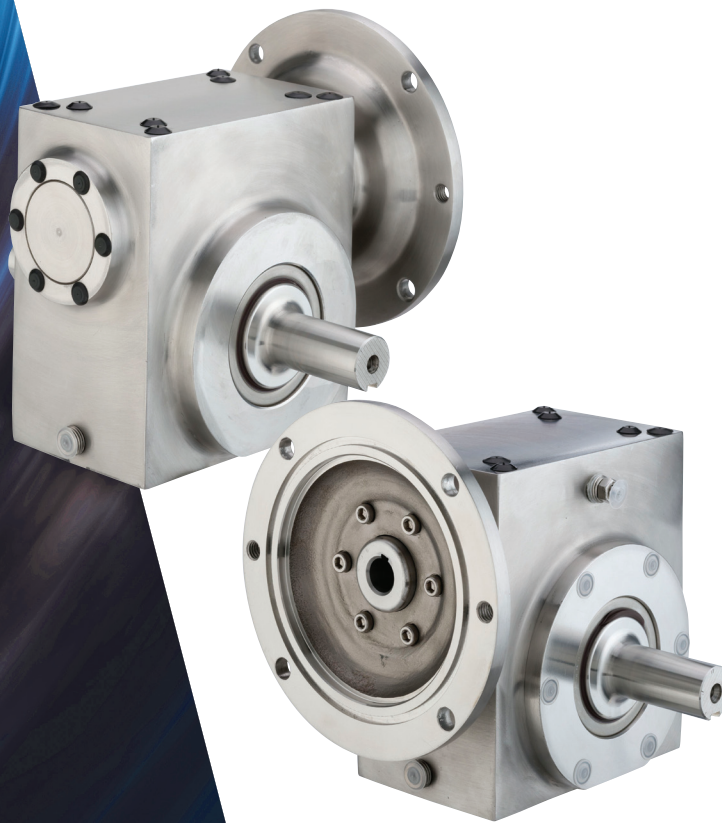

A Regal Brand

REGAL

Stainless Steel Worm Gear Reducers

Benefits

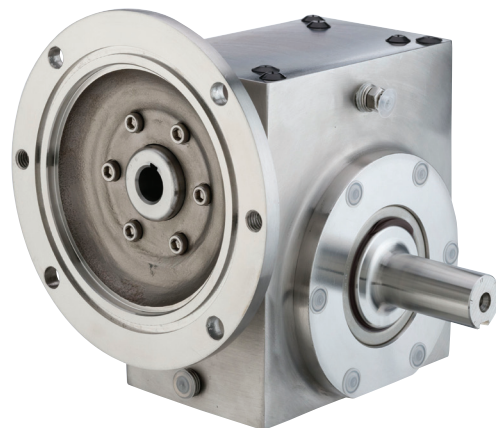

- Polished, 316 stainless steel housing, flange and cover to withstand extreme environments
- Rounded cover and flange to prevent debris accumulation and improve washdown performance
- Two mounting patterns for easy interchangeability to standard worm gear reducer footprints
- O-ring on face of input flange provides a positive seal against moisture intrusion
- 303 stainless steel output shaft
- Stainless steel hardware, including square-head pipe plugs to eliminate entrapment in vent locations
- O-ring seal on the output cover eliminate gaskets, sealants and leaks
- Food grade synthetic lubricant, USDA class H1
- Etched housing stops entrapment caused by traditional nameplates
- Plastic screw and hole covers prevent entrapment



Stainless Steel Maximum Rating Tables

Size 13

13 Series

							Style SBMQ			Style SHMQ	Style SHMQ
											
Ratio	Input RPM	Output RPM	Input HP	Output HP	Output Torque (lb-in)	NEMA C Input Frame	L Assembly Catalog No.	R Assembly Catalog No.	D Assembly Catalog No.	H1 Assembly Catalog No.*	H2 Assembly Catalog No.*
5	2500	500.0	1.528	1.429	180	56C	S133003700	S133004900	S133006100	S133045710	S133046910
	1750	350.0	1.248	1.158	209						
	1170	234.0	0.952	0.872	235						
	100	20.0	0.140	0.095	298						
7.5	2500	333.3	1.281	1.178	223	56C	S133003800	S133005000	S133006200	S133045810	S133047010
	1750	233.3	1.025	0.933	252						
	1170	156.0	0.770	0.689	278						
	870	116.0	0.615	0.540	293						
10	100	13.3	0.118	0.072	339	56C	S133003900	S133005100	S133006300	S133045910	S133047110
	2500	250.0	1.016	0.912	230						
	1750	175.0	0.823	0.729	263						
	1170	117.0	0.626	0.543	293						
15	100	10.0	0.103	0.058	363	56C	S133004000	S133005200	S133006400	S133046010	S133047210
	2500	166.7	0.790	0.678	257						
	1750	116.7	0.642	0.541	292						
	1170	78.0	0.491	0.402	325						
20	100	6.7	0.090	0.042	401	56C	S133004100	S133005300	S133006500	S133046110	S133047310
	2500	125.0	0.681	0.562	283						
	1750	87.5	0.551	0.445	320						
	1170	58.5	0.422	0.328	354						
25	100	5.0	0.084	0.034	431	56C	S133004200	S133005400	S133006600	S133046210	S133047410
	2500	100.0	0.544	0.431	272						
	1750	70.0	0.445	0.344	309						
	1170	46.8	0.344	0.255	344						
30	100	4.0	0.074	0.027	423	56C	S133004300	S133005500	S133006700	S133046310	S133047510
	2500	83.3	0.481	0.364	276						
	1750	58.3	0.395	0.290	314						
	1170	39.0	0.308	0.215	348						
40	100	3.3	0.071	0.023	429	56C	S133004400	S133005600	S133006800	S133046410	S133047610
	2500	62.5	0.400	0.283	285						
	1750	43.8	0.329	0.223	322						
	1170	29.3	0.258	0.165	355						
50	100	2.5	0.066	0.017	432	56C	S133004500	S133005700	S133006900	S133046510	S133047710
	2500	50.0	0.346	0.232	292						
	1750	35.0	0.285	0.182	327						
	1170	23.4	0.224	0.133	359						
60	100	2.0	0.061	0.014	431	56C	S133004600	S133005800	S133007000	S133046610	S133047810
	2500	41.7	0.297	0.184	279						
	1750	29.2	0.246	0.145	313						
	1170	19.5	0.195	0.107	345						
80	100	1.7	0.058	0.011	415	56C	S133004700	S133005900	S133007100	S133046710	S133047910
	2500	31.3	0.144	0.081	163						
	1750	21.9	0.121	0.064	183						
	1170	14.6	0.096	0.047	201						
100	100	1.3	0.014	0.005	237	56C	S133004800	S133006000	S133007200	S133046810	S133048010
	2500	25.0	0.100	0.051	128						
	1750	17.5	0.084	0.040	143						
	1170	11.7	0.067	0.029	156						
	100	1.0	0.010	0.003	184						

Consult Factory for other available styles and motor flanges.

* Catalog numbers are for hollow output shaft reducers.

When ordering, substitute the XX suffix with the required output bore code.



Hollow Shaft Bore Sizes

Fraction Size	5/8"
Decimal Size	0.625"
Output Bore Code	10

Stainless Steel Maximum Rating Tables

Size 15

15 Series

							Style SBMQ			Style SHMQ	Style SHMQ
											
Ratio	Input RPM	Output RPM	Input HP	Output HP	Output Torque (lb-in)	NEMA C Input Frame	L Assembly Catalog No.	R Assembly Catalog No.	D Assembly Catalog No.	H1 Assembly Catalog No.*	H2 Assembly Catalog No.*
5	2500	500.0	2.310	2.151	271	56C	S153003700	S153004900	S153006100	S153045710	S153046910
	1750	350.0	1.939	1.794	323						
	1170	234.0	1.537	1.408	379						
7.5	100	20.0	0.235	0.167	526	143-5TC	S153007300	S153008500	S153009700	S153048110	S153049310
	2500	333.3	1.785	1.619	306						
	1750	233.3	1.522	1.368	370						
10	1170	156.0	1.205	1.068	431	56C	S153003800	S153005000	S153006200	S153045810	S153047010
	100	13.3	0.196	0.125	591						
	2500	250.0	1.500	1.324	334						
15	1750	175.0	1.279	1.116	402	143-5TC	S153007400	S153008600	S153009800	S153048210	S153049410
	1170	117.0	1.014	0.869	468						
	100	10.0	0.176	0.101	639						
20	2500	166.7	1.174	0.982	371	56C	S153003900	S153005100	S153006300	S153045910	S153047110
	1750	116.7	1.003	0.826	446						
	1170	78.0	0.800	0.643	519						
25	100	6.7	0.155	0.075	706	143-5TC	S153004000	S153005200	S153006400	S153046010	S153047210
	2500	125.0	1.077	0.860	434						
	1750	87.5	0.919	0.719	518						
30	1170	58.5	0.734	0.557	600	56C	S153007600	S153008800	S153010000	S153048410	S153049610
	100	5.0	0.155	0.064	807						
	2500	100.0	0.881	0.670	422						
40	1750	70.0	0.752	0.559	503	143-5TC	S153004100	S153005300	S153006500	S153046110	S153047310
	1170	46.8	0.602	0.431	580						
	100	4.0	0.137	0.049	775						
50	2500	83.3	0.729	0.526	398	56C	S153007700	S153008900	S153010100	S153048510	S153049710
	1750	58.3	0.630	0.442	478						
	1170	39.0	0.510	0.344	555						
60	100	3.3	0.124	0.040	754	143-5TC	S153004200	S153005400	S153006600	S153046210	S153047410
	2500	62.5	0.649	0.432	435						
	1750	43.8	0.560	0.361	520						
80	1170	29.3	0.456	0.279	601	56C	S153007800	S153009000	S153010200	S153048610	S153049810
	100	2.5	0.122	0.032	808						
	2500	50.0	0.536	0.329	415						
100	1750	35.0	0.464	0.274	494	143-5TC	S153004300	S153005500	S153006700	S153046310	S153047510
	1170	23.4	0.379	0.211	569						
	100	2.0	0.110	0.024	760						
120	2500	41.7	0.451	0.257	389	56C	S153007900	S153009100	S153010300	S153048710	S153049910
	1750	29.2	0.391	0.214	462						
	1170	19.5	0.321	0.165	532						
150	100	1.7	0.099	0.019	707	143-5TC	S153004400	S153005600	S153006800	S153046410	S153047610
	2500	31.3	0.219	0.109	220						
	1750	21.9	0.204	0.093	269						
200	1170	14.6	0.176	0.073	314	56C	S153008000	S153009200	S153010400	S153048810	S153050010
	100	1.3	0.032	0.008	418						
	2500	25.0	0.155	0.069	175						
250	1750	17.5	0.145	0.059	213	143-5TC	S153004500	S153005700	S153006900	S153046510	S153047710
	1170	11.7	0.126	0.046	248						
	100	1.0	0.024	0.005	328						

Consult Factory for other available styles and motor flanges.

* Catalog numbers are for hollow output shaft reducers.

When ordering, substitute the XX suffix with the required output bore code.



Hollow Shaft Bore Sizes

Fraction Size	5/8"
Decimal Size	0.625"
Output Bore Code	10

Stainless Steel Maximum Rating Tables

Size 18

18 Series

							Style SBMQ			Style SHMQ	Style SHMQ
											
Ratio	Input RPM	Output RPM	Input HP	Output HP	Output Torque (lb-in)	NEMA C Input Frame	L Assembly Catalog No.	R Assembly Catalog No.	D Assembly Catalog No.	H1 Assembly Catalog No.*	H2 Assembly Catalog No.*
5	2500	500.0	3.095	2.900	366	56C	S183003700	S183004900	S183006100	S1830457XX	S1830469XX
	1750	350.0	2.600	2.422	436						
	1170	234.0	2.066	1.906	513						
	100	20.0	0.312	0.228	717						
7.5	2500	333.3	2.307	2.127	402	56C	S183003800	S183005000	S183006200	S1830458XX	S1830470XX
	1750	233.3	1.909	1.745	471						
	1170	156.0	1.473	1.328	537						
	100	13.3	0.227	0.147	697						
10	2500	250.0	1.996	1.820	459	56C	S183003900	S183005100	S183006300	S1830459XX	S1830471XX
	1750	175.0	1.625	1.466	528						
	1170	117.0	1.239	1.099	592						
	100	10.0	0.196	0.118	744						
15	2500	166.7	1.485	1.301	492	56C	S183004000	S183005200	S183006400	S1830460XX	S1830472XX
	1750	116.7	1.224	1.058	571						
	1170	78.0	0.945	0.799	645						
	100	6.7	0.165	0.087	823						
20	2500	125.0	1.283	1.093	551	56C	S183004100	S183005300	S183006500	S1830461XX	S1830473XX
	1750	87.5	1.046	0.875	630						
	1170	58.5	0.803	0.652	702						
	100	5.0	0.150	0.069	872						
25	2500	100.0	1.088	0.900	567	56C	S183004200	S183005400	S183006600	S1830462XX	S1830474XX
	1750	70.0	0.884	0.715	644						
	1170	46.8	0.678	0.530	713						
	100	4.0	0.135	0.055	874						
30	2500	83.3	0.892	0.702	531	56C	S183004300	S183005500	S183006700	S1830463XX	S1830475XX
	1750	58.3	0.741	0.569	614						
	1170	39.0	0.580	0.428	692						
	100	3.3	0.126	0.047	880						
40	2500	62.5	0.739	0.551	556	56C	S183004400	S183005600	S183006800	S1830464XX	S1830476XX
	1750	43.8	0.609	0.440	634						
	1170	29.3	0.476	0.328	706						
	100	2.5	0.113	0.035	874						
50	2500	50.0	0.625	0.444	559	56C	S183004500	S183005700	S183006900	S1830465XX	S1830477XX
	1750	35.0	0.515	0.352	634						
	1170	23.4	0.404	0.260	701						
	100	2.0	0.103	0.027	857						
60	2500	41.7	0.542	0.363	550	56C	S183004600	S183005800	S183007000	S1830466XX	S1830478XX
	1750	29.2	0.449	0.288	623						
	1170	19.5	0.354	0.213	689						
	100	1.7	0.097	0.022	842						
80	2500	31.3	0.247	0.156	314	56C	S183004700	S183005900	S183007100	S1830467XX	S1830479XX
	1750	21.9	0.208	0.124	356						
	1170	14.6	0.164	0.091	392						
	100	1.3	0.023	0.009	470						
100	2500	25.0	0.167	0.097	245	56C	S183004800	S183006000	S183007200	S1830468XX	S1830480XX
	1750	17.5	0.141	0.077	277						
	100	1.0	0.016	0.006	362						

Consult Factory for other available styles and motor flanges.

* Catalog numbers are for hollow output shaft reducers.

When ordering, substitute the XX suffix with the required output bore code.



Hollow Shaft Bore Sizes

Fraction Size	5/8"	11/16"	3/4"	7/8"	1"
Decimal Size	0.625"	0.688"	0.750"	0.875"	1.000"
Output Bore Code	10	11	12	14	16

Stainless Steel Maximum Rating Tables

Size 21

21 Series

							Style SBMQ			Style SHMQ	Style SHMQ
											
Ratio	Input RPM	Output RPM	Input HP	Output HP	Output Torque (lb-in)	NEMA C Input Frame	L Assembly Catalog No.	R Assembly Catalog No.	D Assembly Catalog No.	H1 Assembly Catalog No.*	H2 Assembly Catalog No.*
5	2500	500.0	4.305	4.043	510	56C	S213003700	S213004900	S213006100	S2130457XX	S2130469XX
	1750	350.0	3.653	3.410	614						
	1170	234.0	2.873	2.657	716						
	100	20.0	0.433	0.310	977						
7.5	2500	333.3	3.300	3.051	577	56C	S213003800	S213005000	S213006200	S2130458XX	S2130470XX
	1750	233.3	2.793	2.562	692						
	1170	156.0	2.194	1.989	804						
	100	13.3	0.341	0.230	1089						
10	2500	250.0	2.973	2.722	686	56C	S213003900	S213005100	S213006300	S2130459XX	S2130471XX
	1750	175.0	2.464	2.235	805						
	1170	117.0	1.905	1.702	917						
	100	10.0	0.300	0.189	1192						
15	2500	166.7	2.284	2.035	769	56C	S213004000	S213005200	S213006400	S2130460XX	S2130472XX
	1750	116.7	1.887	1.661	897						
	1170	78.0	1.459	1.259	1017						
	100	6.7	0.245	0.138	1309						
20	2500	125.0	1.914	1.642	828	56C	S213004100	S213005300	S213006500	S2130461XX	S2130473XX
	1750	87.5	1.584	1.338	964						
	1170	58.5	1.229	1.012	1090						
	100	5.0	0.226	0.111	1397						
25	2500	100.0	1.623	1.359	857	56C	S213004200	S213005400	S213006600	S2130462XX	S2130474XX
	1750	70.0	1.333	1.094	985						
	1170	46.8	1.030	0.820	1104						
	100	4.0	0.200	0.088	1386						
30	2500	83.3	1.359	1.102	833	56C	S213004300	S213005500	S213006700	S2130463XX	S2130475XX
	1750	58.3	1.129	0.896	968						
	1170	39.0	0.882	0.677	1095						
	100	3.3	0.181	0.074	1399						
40	2500	62.5	1.096	0.829	836	56C	S213004400	S213005600	S213006800	S2130464XX	S2130476XX
	1750	43.8	0.916	0.674	971						
	1170	29.3	0.722	0.509	1097						
	100	2.5	0.167	0.056	1401						
50	2500	50.0	0.925	0.670	845	56C	S213004500	S213005700	S213006900	S2130465XX	S2130477XX
	1750	35.0	0.769	0.539	970						
	1170	23.4	0.606	0.403	1086						
	100	2.0	0.149	0.043	1359						
60	2500	41.7	0.799	0.535	809	56C	S213004600	S213005800	S213007000	S2130466XX	S2130478XX
	1750	29.2	0.674	0.435	940						
	1170	19.5	0.539	0.328	1061						
	100	1.7	0.145	0.036	1354						
80	2500	31.3	0.357	0.236	476	56C	S213004700	S213005900	S213007100	S2130467XX	S2130479XX
	1750	21.9	0.304	0.190	547						
	1170	14.6	0.241	0.141	609						
	100	1.3	0.034	0.015	743						
100	2500	25.0	0.251	0.150	379	56C	S213004800	S213006000	S213007200	S2130468XX	S2130480XX
	1750	17.5	0.217	0.122	439						
	100	1.0	0.026	0.010	605						

Consult Factory for other available styles and motor flanges.

* Catalog numbers are for hollow output shaft reducers.

When ordering, substitute the XX suffix with the required output bore code.



Hollow Shaft Bore Sizes

Fraction Size	1"	1-1/8"	1-3/16"	1-1/4"	1-7/16"
Decimal Size	1.000"	1.125"	1.188"	1.250"	1.438"
Output Bore Code	16	18	19	20	23

Stainless Steel Maximum Rating Tables

Size 24

24 Series

							Style SBMQ			Style SHMQ	Style SHMQ
											
Ratio	Input RPM	Output RPM	Input HP	Output HP	Output Torque (lb-in)	NEMA C Input Frame	L Assembly Catalog No.	R Assembly Catalog No.	D Assembly Catalog No.	H1 Assembly Catalog No.*	H2 Assembly Catalog No.*
5	2500	500.0	6.322	5.950	750	143-5TC	S243003700	S243004900	S243006100	S2430457XX	S2430469XX
	1750	350.0	5.323	4.985	898						
	1170	234.0	4.280	3.976	1071						
	100	20.0	0.655	0.489	1540						
7.5	2500	333.3	4.739	4.401	832	143-5TC	S243003800	S243005000	S243006200	S2430458XX	S2430470XX
	1750	233.3	3.992	3.685	995						
	1170	156.0	3.204	2.929	1183						
	100	13.3	0.502	0.357	1689						
10	2500	250.0	4.199	3.862	974	143-5TC	S243003900	S243005100	S243006300	S2430459XX	S2430471XX
	1750	175.0	3.564	3.253	1172						
	1170	117.0	2.808	2.531	1364						
	100	10.0	0.442	0.295	1857						
15	2500	166.7	3.268	2.913	1102	56C	S243000400	S243001600	S243002800	S2430436XX	S2430448XX
	1750	116.7	2.765	2.439	1318						
	1170	78.0	2.178	1.888	1526						
	100	6.7	0.369	0.217	2056						
20	2500	125.0	2.750	2.365	1192	56C	S243000500	S243001700	S243002900	S2430437XX	S2430449XX
	1750	87.5	2.326	1.972	1421						
	1170	58.5	1.835	1.522	1640						
	100	5.0	0.337	0.174	2193						
25	2500	100.0	2.335	1.949	1228	56C	S243000600	S243001800	S243003000	S2430438XX	S2430450XX
	1750	70.0	1.967	1.615	1454						
	1170	46.8	1.551	1.239	1669						
	100	4.0	0.302	0.140	2205						
30	2500	83.3	1.945	1.579	1194	56C	S243000700	S243001900	S243003100	S2430439XX	S2430451XX
	1750	58.3	1.653	1.317	1423						
	1170	39.0	1.314	1.016	1642						
	100	3.3	0.270	0.116	2197						
40	2500	62.5	1.574	1.195	1205	56C	S243000800	S243002000	S243003200	S2430440XX	S2430452XX
	1750	43.8	1.342	0.994	1433						
	1170	29.3	1.074	0.766	1650						
	100	2.5	0.245	0.087	2198						
50	2500	50.0	1.335	0.961	1211	56C	S243000900	S243002100	S243003300	S2430441XX	S2430453XX
	1750	35.0	1.137	0.795	1432						
	1170	23.4	0.911	0.609	1641						
	100	2.0	0.224	0.069	2163						
60	2500	41.7	1.149	0.806	1219	56C	S243001000	S243002200	S243003400	S2430442XX	S2430454XX
	1750	29.2	0.967	0.656	1418						
	1170	19.5	0.770	0.496	1604						
	100	1.7	0.197	0.054	2054						
80	2500	31.3	0.520	0.348	701	56C	S243001100	S243002300	S243003500	S2430443XX	S2430455XX
	1750	21.9	0.455	0.288	830						
	1170	14.6	0.370	0.219	946						
	100	1.3	0.056	0.024	1202						
100	2500	25.0	0.351	0.219	551	56C	S243001200	S243002400	S243003600	S2430444XX	S2430456XX
	1750	17.5	0.307	0.180	648						
	100	1.0	0.039	0.015	926						

Consult Factory for other available styles and motor flanges.

* Catalog numbers are for hollow output shaft reducers.

When ordering, substitute the XX suffix with the required output bore code.



Hollow Shaft Bore Sizes

Fraction Size	1"	1-1/8"	1-3/16"	1-1/4"	1-7/16"
Decimal Size	1.000"	1.125"	1.188"	1.250"	1.438"
Output Bore Code	16	18	19	20	23

Stainless Steel
Maximum Rating Tables

Size 26

26 Series

							Style SBMQ			Style SHMQ	Style SHMQ
											
Ratio	Input RPM	Output RPM	Input HP	Output HP	Output Torque (lb-in)	NEMA C Input Frame	L Assembly Catalog No.	R Assembly Catalog No.	D Assembly Catalog No.	H1 Assembly Catalog No.*	H2 Assembly Catalog No.*
5 (5.17 actual)	2500	500.0	7.946	7.486	944	143-5TC	S263003700	S263004900	S263006100	S2630457XX	S2630469XX
	1750	350.0	6.693	6.276	1130						
	1170	234.0	5.439	5.061	1363	182-4TC	S263007300	S263008500	S263009700	S2630481XX	S2630493XX
7.5	100	20.0	0.844	0.638	2010						
	2500	333.3	5.877	5.453	1031	143-5TC	S263003800	S263005000	S263006200	S2630458XX	S2630470XX
	1750	233.3	4.956	4.571	1235						
10	1170	156.0	4.018	3.671	1483	182-4TC	S263007400	S263008600	S263009800	S2630482XX	S2630494XX
	100	13.3	0.640	0.458	2166						
	2500	250.0	5.338	4.904	1236	143-5TC	S263003900	S263005100	S263006300	S2630459XX	S2630471XX
15	1750	175.0	4.492	4.097	1475						
	1170	117.0	3.579	3.226	1738	182-4TC	S263007500	S263008700	S263009900	S2630483XX	S2630495XX
	100	10.0	0.572	0.386	2431						
20	2500	166.7	4.316	3.881	1468	143-5TC	S263004000	S263005200	S263006400	S2630460XX	S2630472XX
	1750	116.7	3.614	3.216	1737						
	1170	78.0	2.821	2.468	1994	182-4TC	S263007600	S263008800	S263010000	S2630484XX	S2630496XX
25	100	6.7	0.467	0.279	2637						
	2500	125.0	3.503	3.050	1538	56C	S263000500	S263001700	S263002900	S2630437XX	S2630449XX
	1750	87.5	2.965	2.549	1836						
30	1170	58.5	2.339	1.970	2123	143-5TC	S263004100	S263005300	S263006500	S2630461XX	S2630473XX
	100	5.0	0.419	0.226	2849	182-4TC	S263007700	S263008900	S263010100	S2630485XX	S2630497XX
	2500	100.0	2.955	2.505	1579	56C	S263000600	S263001800	S263003000	S2630438XX	S2630450XX
40	1750	70.0	2.487	2.076	1869						
	1170	46.8	1.957	1.594	2146	143-5TC	S263004200	S263005400	S263006600	S2630462XX	S2630474XX
	100	4.0	0.370	0.180	2837						
50	2500	83.3	2.556	2.115	1600	56C	S263000700	S263001900	S263003100	S2630439XX	S2630451XX
	1750	58.3	2.145	1.743	1883						
	1170	39.0	1.687	1.332	2152	143-5TC	S263004300	S263005500	S263006700	S2630463XX	S2630475XX
60	100	3.3	0.335	0.149	2816						
	2500	62.5	1.989	1.545	1558	56C	S263000800	S263002000	S263003200	S2630440XX	S2630452XX
	1750	43.8	1.695	1.287	1854						
80	1170	29.3	1.354	0.993	2139	143-5TC	S263004400	S263005600	S263006800	S2630464XX	S2630476XX
	100	2.5	0.299	0.113	2857						
	2500	50.0	1.672	1.237	1560	56C	S263000900	S263002100	S263003300	S2630441XX	S2630453XX
100	1750	35.0	1.420	1.023	1843						
	1170	23.4	1.135	0.784	2112	143-5TC	S263004500	S263005700	S263006900	S2630465XX	S2630477XX
	100	2.0	0.269	0.088	2783						
120	2500	41.7	1.433	1.015	1536	56C	S263001000	S263002200	S263003400	S2630442XX	S2630454XX
	1750	29.2	1.216	0.835	1805						
	1170	19.5	0.973	0.637	2060	143-5TC	S263004600	S263005800	S263007000	S2630466XX	S2630478XX
150	100	1.7	0.245	0.071	2689						
	2500	31.3	0.659	0.456	919	56C	S263001100	S263002300	S263003500	S2630443XX	S2630455XX
	1750	21.9	0.577	0.379	1092						
200	1170	14.6	0.469	0.289	1247	143-5TC	S263004700	S263005900	S263007100	S2630467XX	S2630479XX
	100	1.3	0.070	0.032	1593						
	2500	25.0	0.441	0.286	721						
250	1750	17.5	0.386	0.236	851	56C	S263001200	S263002400	S263003600	S2630444XX	S2630456XX
	1170	11.7	0.314	0.179	966						
	100	1.0	0.048	0.019	1222						

Consult Factory for other available styles and motor flanges.

* Catalog numbers are for hollow output shaft reducers.
When ordering, substitute the XX suffix with the required output bore code.



Hollow Shaft Bore Sizes

Fraction Size	1"	1-1/8"	1-3/16"	1-1/4"	1-7/16"	1-1/2"
Decimal Size	1.000"	1.125"	1.188"	1.250"	1.438"	1.500"
Output Bore Code	16	18	19	20	23	24

Stainless Steel Maximum Rating Tables

Size 32

32 Series

							Style SBMQ			Style SHMQ	Style SHMQ
											
Ratio	Input RPM	Output RPM	Input HP	Output HP	Output Torque (lb-in)	NEMA C Input Frame	L Assembly Catalog No.	R Assembly Catalog No.	D Assembly Catalog No.	H1 Assembly Catalog No.*	H2 Assembly Catalog No.*
5 (5.17 actual)	2500	500.0	10.56	10.03	1306	182-4TC	S323007300	S323008500	S323009700	S3230625XX	S3230637XX
	1750	350.0	9.135	8.611	1602						
	1170	234.0	7.694	7.172	1995						
7.5	100	20.0	1.289	1.097	3571	213-5TC	S323010900	S323012100	S323013300	S3230649XX	S3230661XX
	2500	333.3	9.053	8.527	1612						
	1750	233.3	7.844	7.317	1976	182-4TC	S323007400	S323008600	S323009800	S3230626XX	S3230638XX
10	1170	156.0	6.642	6.114	2469	213-5TC	S323011000	S323012200	S323013400	S3230650XX	S3230662XX
	100	13.3	1.136	0.949	4075						
	2500	250.0	8.232	7.701	1941	143-5TC	S323003900	S323005100	S323006300	S3230603XX	S3230615XX
15	1750	175.0	7.034	6.507	2343						
	1170	117.0	5.974	5.446	2932	182-4TC	S323007500	S323008700	S323009900	S3230627XX	S3230639XX
	100	10.0	0.857	0.704	4437	213-5TC	S323011100	S323012300	S323013500	S3230651XX	S3230663XX
20	2500	166.7	6.161	5.603	2118	143-5TC	S323004000	S323005200	S323006400	S3230604XX	S3230616XX
	1750	116.7	5.277	4.724	2551						
	1170	78.0	4.531	3.971	3207	182-4TC	S323007600	S323008800	S323010000	S3230628XX	S3230640XX
25	100	6.7	0.682	0.518	4895						
	2500	125.0	4.836	4.306	2170	143-5TC	S323004100	S323005300	S323006500	S3230605XX	S3230617XX
	1750	87.5	4.188	3.658	2633						
30	1170	58.5	3.547	3.020	3253	182-4TC	S323007700	S323008900	S323010100	S3230629XX	S3230641XX
	100	5.0	0.528	0.381	4802						
	2500	100.0	3.977	3.468	2185	143-5TC	S323004200	S323005400	S323006600	S3230606XX	S3230618XX
40	1750	70.0	3.465	2.953	2658						
	1170	46.8	2.914	2.413	3248	182-4TC	S323007800	S323009000	S323010200	S3230630XX	S3230642XX
	100	4.0	0.434	0.298	4701						
50	2500	83.3	3.452	2.903	2195	143-5TC	S323004300	S323005500	S323006700	S3230607XX	S3230619XX
	1750	58.3	3.003	2.454	2651						
	1170	39.0	2.604	2.052	3315	182-4TC	S323007900	S323009100	S323010300	S3230631XX	S3230643XX
60	100	3.3	0.425	0.265	5007						
	2500	62.5	2.669	2.157	2174	56C	S323000800	S323002000	S323003200	S3230584XX	S3230596XX
	1750	43.8	2.348	1.834	2641						
80	1170	29.3	2.019	1.509	3251	143-5TC	S323004400	S323005600	S323006800	S3230608XX	S3230620XX
	100	2.5	0.330	0.189	4769	182-4TC	S323008000	S323009200	S323010400	S3230632XX	S3230644XX
	2500	50.0	2.152	1.674	2110	56C	S323000900	S323002100	S323003300	S3230585XX	S3230597XX
100	1750	35.0	1.907	1.426	2568						
	1170	23.4	1.634	1.163	3130	143-5TC	S323004500	S323005700	S323006900	S3230609XX	S3230621XX
	100	2.0	0.270	0.143	4510	182-4TC	S323008100	S323009300	S323010500	S3230633XX	S3230645XX
125	2500	41.7	1.764	1.323	2001	56C	S323001000	S323002200	S323003400	S3230586XX	S3230598XX
	1750	29.2	1.573	1.128	2437						
	1170	19.5	1.346	0.913	2951	143-5TC	S323004600	S323005800	S323007000	S3230610XX	S3230622XX
150	100	1.7	0.225	0.111	4201	182-4TC	S323008200	S323009400	S323010600	S3230634XX	S3230646XX
	2500	31.3	1.122	0.796	1605	56C	S323001100	S323002300	S323003500	S3230587XX	S3230599XX
	1750	21.9	1.030	0.695	2000						
200	1170	14.6	0.869	0.551	2371	143-5TC	S323004700	S323005900	S323007100	S3230611XX	S3230623XX
	100	1.3	0.143	0.064	3246						
	2500	25.0	0.754	0.503	1268						
250	1750	17.5	0.691	0.435	1567	56C	S323001200	S323002400	S323003600	S3230588XX	S3230600XX
	1170	11.7	0.584	0.343	1846						
	100	1.0	0.097	0.040	2496						

Consult Factory for other available styles and motor flanges.

* Catalog numbers are for hollow output shaft reducers.
When ordering, substitute the XX suffix with the required output bore code.

Hollow Shaft Bore Sizes

Fraction Size	1-3/16"	1-1/4"	1-7/16"	1-1/2"	1-5/8"	1-11/16"	1-3/4"	1-7/8"	1-15/16"	2"	2-3/16"
Decimal Size	1.188"	1.250"	1.438"	1.500"	1.625"	1.688"	1.75"	1.875"	1.938"	2.000"	2.188"
Output Bore Code	19	20	23	24	26	27	28	30	31	32	35

Dimensions

HMQ Style

	A	AD	B	C	D	E	F1	F2	H1	H2	I	J1	J2	LQ (56C/ 140TC)	LQ (180TC)	T MAX	T KWY	V	AG
13	2.82	3.69	3.80	4.66	1.72	1.333	2.00	N/A	5/16-18	N/A	2.38	3.25	N/A	3.48	N/A	0.625	3/16 x 3/32	1.00	4.75
15	3.44	4.40	4.88	5.38	1.91	1.540	2.75	N/A	5/16-18	N/A	2.91	4.19	N/A	4.01	N/A	0.625	3/16 x 3/32	1.00	5.42
18	3.32	4.40	5.06	5.75	2.06	1.750	2.75	1.63	5/16-18	1/4-20	3.01	4.19	3.13	4.11	N/A	1.000	1/4 x 1/8	1.44	5.50
21	3.60	4.78	5.80	6.38	2.28	2.063	3.00	2.00	5/16-18	5/16-18	3.38	4.75	4.00	4.48	N/A	1.500	3/8 x 3/16	1.94	6.00
24	4.06	4.97	6.12	6.94	2.50	2.375	2.88	N/A	3/8-16	N/A	3.69	5.00	N/A	4.63	5.24	1.500	3/8 x 3/16	1.94	6.00
26	4.54	5.80	7.25	8.00	2.94	2.625	3.38	2.69	3/8-16	3/8-16	4.25	6.38	4.88	5.19	5.80	1.500	3/8 x 3/16	1.94	7.00
32	5.45	6.80	8.50	9.38	3.50	3.250	4.00	2.75	7/16-14	1/2-13	4.94	7.50	6.25	5.88	6.49	2.188	1/2 x 1/4	2.75	7.88

BMQ Style

	A	AD	B	C	D	E	F1	F2	H1	H2	I	J1	J2	LQ (56C/ 140TC)	LQ (180TC)	N	O/P Key	T
13	2.82	3.69	3.80	4.66	1.72	1.333	2.00	N/A	5/16-18	N/A	2.38	3.25	N/A	3.48	N/A	4.00	3/16 x 1.75	0.625
15	3.44	4.40	4.88	5.38	1.91	1.540	2.75	N/A	5/16-18	N/A	2.91	4.19	N/A	4.01	N/A	4.31	3/16 x 1.75	0.750
18	3.32	4.40	5.06	5.75	2.06	1.750	2.75	1.63	5/16-18	1/4-20	3.01	4.19	3.13	4.11	N/A	4.31	3/16 x 1.38	0.875
21	3.60	4.78	5.80	6.38	2.28	2.063	3.00	2.00	5/16-18	5/16-8	3.38	4.75	4.00	4.48	N/A	4.68	1/4 x 1.45	1.000
24	4.06	4.97	6.12	6.94	2.50	2.375	2.88	N/A	3/8-16	N/A	3.69	5.00	N/A	4.63	5.24	5.14	1/4 x 1.75	1.125
26	4.54	5.80	7.25	8.00	2.94	2.625	3.38	2.69	3/8-16	3/8-16	4.25	6.38	4.88	5.19	5.80	5.63	1/4 x 2.00	1.250
32	5.45	6.80	8.50	9.38	3.50	3.250	4.00	2.75	7/16-14	1/2-13	4.94	7.50	6.25	5.88	6.49	7.06	3/8 x 2.63	1.500

HMQ Style

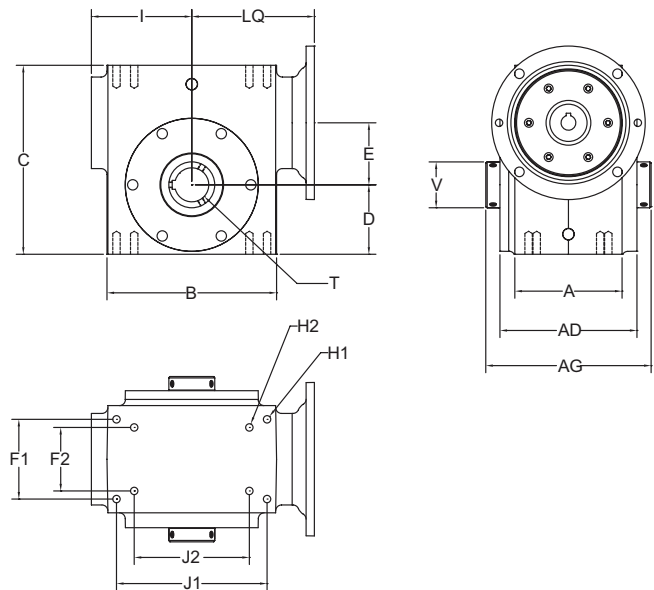

BMQ Style

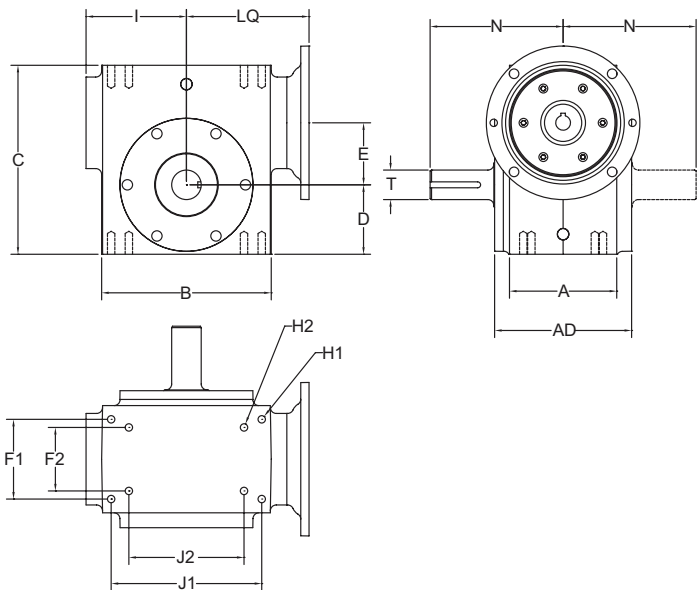

Chemical Compatibility Summary

Material	Reaction Level to Material		
	Cast Iron	Aluminum	316 Stainless
Ammonia Anhydrous	D	B	A
Acetic Acid	D	B	B
Arsenic Acid	D	D	A
Barium Chloride	C	D	A
Barium Sulfate	B	B	B
Beer	D	A	A
Butter	D	A	A
Butyl Alcohol	A	B	C
Calcium Chloride	C	D	B
Carbonic Acid	D	B	A
Catsup	D	D	A
Citric Acid	D	C	A
Chlorine (Dry)	A	C	A
Detergents	N/A	B	A
Diethylene Glycol	A	B	A
Formaldehyde	D	A	A
Grape Juice	D	N/A	A
Lactic Acid	D	B	B
Mayonaise	D	A	A
Nitric Acid (50%)	D	D	A
Salad Dressing	D	B	A
Soap Solutions	A	C	A
Sodium Hydroxide (80%)	D	D	B
Sodium Hypochlorite (<20%)	D	D	C
Sodium Sulfide	A	C	B
Soy Sauce	D	A	A
Sulfuric Acid (<10%)	C	D	B
Sulfur Dioxide	N/A	C	A
Tannic Acid	C	C	A
Turpentine	A	C	B
Vegetable Juice	D	D	A
Vinegar	D	D	A
Water, Fresh	D	B	A
Water, Salt	D	B	B
Whey	N/A	B	A
Whiskey and Wines	D	C	A
Zinc Chloride	D	D	B
Zinc Sulfate	D	D	A

A = Excellent
B = Good, minor effect
C = Fair, moderate affect (not recommended for continuous use)
D = Severe effect, not recommended
 N/A = Information not available

Applications

- Washdown • Meat & Poultry Processing • Food Processing
- Chemical Processing • Pharmaceutical



GROVE GEAR

Grove Gear
Union Grove, Wisconsin 53182
PH: 262-878-1221
FAX: 262-878-1968

grovegear.com

© 2012 Regal-Beloit Corporation 7462G-SK-BH/01-13/2.5K/TRAVER

A Regal Brand

The Regal logo consists of the word "REGAL" in a bold, italicized, sans-serif font, set against a dark gray parallelogram background.

REGAL

www.regalbeloit.com