

Find Drive Selection Tables at www.martinsprocket.com

ROLLER CHAIN SPROCKETS

| PRODUCT | PAGE |
|---|-------------------|
| INDEX | E-1 - E-2 |
| MADE-TO-ORDER CAPABILITIES | E-3 |
| SECTION I — STANDARD SPROCKETS | E-4 - E-112 |
| Shear Pin Sprockets, Bolt-On | E-4 - E-6 |
| Type D Sprockets, Detachable Hubs Split and Solid | E-7 |
| Instant Split® Sprockets | E-8 |
| Torque Limiter | E-9 - E-10 |
| Double Pitch Sprockets | E-11 - E-15 |
| Double Single Sprockets | (See Pitch Below) |
| Sprockets, Stock | E-16 - E-112 |
| No. 25 — ¼" pitch | E-16 - E-17 |
| No. 35 — ⅜" pitch | E-18 - E-26 |
| No. 41 — ½" pitch | E-27 - E-29 |
| No. 40 — ½" pitch | E-30 - E-42 |
| No. 50 — ⅝" pitch | E-43 - E-55 |
| No. 60 — ¾" pitch | E-56 - E-68 |
| No. 80 — 1" pitch | E-69 - E-81 |
| No. 100 — 1¼" pitch | E-82 - E-91 |
| No. 120 — 1½" pitch | E-92 - E-97 |
| No. 140 — 1¾" pitch | E-98 - E-102 |
| No. 160 — 2" pitch | E-103 - E-107 |
| No. 180 — 2¼" pitch | E-108 |
| No. 200 — 2½" pitch | E-109 - E-111 |
| No. 240 — 3" pitch | E-112 |
| SECTION II — METRIC SPROCKETS | E-113 - E-151 |
| ISO - 06B-1, Metric 35 - 0.375 in. (9.525mm) Pitch, Simplex | E-114 - E-115 |
| ISO - 06B-2, Metric 35-2 - 0.375 in. (9.525mm) Pitch, Duplex | E-116 - E-117 |
| ISO - 06B-3, Metric 35-3 - 0.375 in. (9.525mm) Pitch, Triplex | E-118 |
| ISO - 08B-1, Metric 40 - 0.500 in. (12.70mm) Pitch, Simplex | E-119 - E-120 |
| ISO - 08B-2, Metric 40-2 - 0.500 in. (12.70mm) Pitch, Duplex | E-121 - E-122 |
| ISO - 08B-3, Metric 40-3 - 0.500 in. (12.70mm) Pitch, Triplex | E-123 |
| ISO - 10B-1, Metric 50 - 0.625 in. (15.88mm) Pitch, Simplex | E-124 - E-125 |
| ISO - 10B-2, Metric 50-2 - 0.625 in. (15.88mm) Pitch, Duplex | E-126 - E-127 |
| ISO - 10B-3, Metric 50-3 - 0.625 in. (15.88mm) Pitch, Triplex | E-128 |
| ISO - 12B-1, Metric 60 - 0.750 in. (19.05mm) Pitch, Simplex | E-129 - E-130 |
| ISO - 12B-2, Metric 60-2 - 0.750 in. (19.05mm) Pitch, Duplex | E-131 - E-132 |
| ISO - 12B-3, Metric 60-3 - 0.750 in. (19.05mm) Pitch, Triplex | E-133 |
| ISO - 16B-1, Metric 80 - 1.000 in. (25.40mm) Pitch, Simplex | E-134 - E-135 |

Metric Sprockets ISO STANDARDS

Types A - B & C Stock Sprockets



**TYPE A
SIMPLEX**



**TYPE B
SIMPLEX**



**TYPE C
TRIPLEX**



**TYPE B
DUPLEX**



**Taper Bushed
SIMPLEX**



**Taper Bushed
DUPLEX**



**INSTANT
SPLIT® SPROCKET**

Made-to-Order



**Taper Bushed
DOUBLE-SIMPLEX
HARDENED TEETH
Double Simplex**



**QD
SIMPLEX
“QD” Sprockets**



**IDLER
BALL BEARING
Idler Sprockets**



**TYPE B
SIMPLEX
STAINLESS
Stainless Steel**

Metric Sprockets

Martin

ISO **06B-1**
METRIC **35**

0.375 INCH (9.525mm) PITCH **SIMPLEX**

CHAIN DATA:

BS 228/3

ISO 06B-1

PITCH: 9.53mm (0.375 in.)

ROLLER DIAMETER: 6.35mm (0.250 in.)

ROLLER WIDTH: 5.72mm (0.225 in.)

TENSILE: 910 kilos (2000 lbs.)

Simplex-Type B — Steel

Simplex-Type A — Steel

| No. Teeth | Pitch Diameter MM | Catalog Number | Bore | | Hub | | Weight (Approx.) Kilos | Catalog Number | Bore Stock MM | Weight (Approx.) Kilos |
|-----------|----------------------|----------------|-------------|------------|------------|------------|------------------------------|----------------|------------------|------------------------------|
| | | | Stock MM | Max. MM | Dia. MM | Thru MM | | | | |
| 8 | 24.89 | 06B8 | 8 | 9 | 13 | 22 | 0.03 | | | |
| 9 | 27.85 | 06B9 | 8 | 11 | 16 | 22 | 0.04 | | | |
| 10 | 30.82 | 06B10 | 8 | 12 | 20 | 22 | 0.06 | | | |
| 11 | 33.81 | 06B11 | 8 | 14 | 23 | 25 | 0.09 | | | |
| 12 | 36.80 | 06B12 | 8 | 16 | 26 | 25 | 0.10 | | | |
| 13 | 39.80 | 06B13 | 10 | 18 | 29 | 25 | 0.11 | | | |
| 14 | 42.80 | 06B14 | 10 | 16 | 31 | 25 | 0.12 | | | |
| 15 | 45.81 | 06B15 | 10 | 20 | 34 | 25 | 0.14 | 06A15 | 8 | 0.07 |
| 16 | 48.82 | 06B16 | 10 | 22 | 37 | 25 | 0.18 | 06A16 | 10 | 0.08 |
| 17 | 51.84 | 06B17 | 10 | 25 | 40 | 28 | 0.20 | 06A17 | 10 | 0.18 |
| 18 | 54.85 | 06B18 | 10 | 25 | 43 | 28 | 0.23 | 06A18 | 10 | 0.11 |
| 19 | 57.87 | 06B19 | 10 | 28 | 46 | 28 | 0.25 | 06A19 | 10 | 0.12 |
| 20 | 60.89 | 06B20 | 10 | 30 | 49 | 28 | 0.31 | 06A20 | 10 | 0.13 |
| 21 | 63.91 | 06B21 | 12 | 30 | 50 | 28 | 0.36 | 06A21 | 10 | 0.14 |
| 22 | 66.93 | 06B22 | 12 | 32 | 51 | 28 | 0.37 | 06A22 | 10 | 0.15 |
| 23 | 69.95 | 06B23 | 12 | 32 | 52 | 28 | 0.39 | 06A23 | 10 | 0.17 |
| 24 | 72.97 | 06B24 | 12 | 32 | 54 | 28 | 0.40 | 06A24 | 10 | 0.19 |
| 25 | 76.00 | 06B25 | 12 | 35 | 57 | 28 | 0.41 | 06A25 | 10 | 0.20 |
| 26 | 79.02 | 06B26 | 12 | 38 | 60 | 28 | 0.42 | 06A26 | 10 | 0.21 |
| 27 | 82.05 | 06B27 | 12 | 38 | 60 | 28 | 0.44 | 06A27 | 10 | 0.22 |
| 28 | 85.07 | 06B28 | 12 | 38 | 60 | 28 | 0.45 | 06A28 | 10 | 0.23 |
| 29 | 88.10 | 06B29 | 12 | 38 | 60 | 28 | 0.47 | 06A29 | 10 | 0.25 |
| 30 | 91.12 | 06B30 | 12 | 38 | 60 | 30 | 0.48 | 06A30 | 10 | 0.27 |
| 32 | 97.18 | 06B32 | 14 | 40 | 65 | 30 | 0.56 | 06A32 | 12 | 0.20 |
| 35 | 106.26 | 06B35 | 14 | 40 | 65 | 30 | 0.68 | 06A35 | 12 | 0.27 |
| 36 | 109.29 | 06B36 | 16 | 45 | 70 | 30 | 0.71 | 06A36 | 12 | 0.28 |
| 38 | 115.35 | 06B38 | 16 | 45 | 70 | 30 | 0.77 | 06A38 | 14 | 0.43 |
| 40 | 121.40 | 06B40 | 16 | 45 | 70 | 30 | 0.81 | 06A40 | 14 | 0.45 |
| 42 | 127.46 | 06B42 | 16 | 45 | 70 | 30 | 0.85 | 06A42 | 14 | 0.48 |
| 45 | 136.55 | 06B45 | 16 | 45 | 75 | 30 | 0.91 | 06A45 | 14 | 0.51 |
| 48 | 145.64 | 06B48 | 16 | 45 | 75 | 30 | 0.97 | 06A48 | 14 | 0.54 |
| 54 | 163.82 | 06B54 | 16 | 45 | 75 | 30 | 1.09 | 06A54 | 14 | 0.61 |
| 57 | 172.91 | 06B57 | 19 | 45 | 75 | 30 | 1.27 | 06A57 | 18 | 0.86 |
| 60 | 182.00 | 06B60 | 19 | 45 | 75 | 30 | 1.34 | 06A60 | 18 | 0.91 |
| 64 | 194.12 | 06B64 | 19 | 45 | 75 | 30 | 1.43 | 06A64 | 18 | 0.97 |
| 70 | 212.30 | 06B70 | 19 | 45 | 75 | 30 | 1.56 | 06A70 | 18 | 1.06 |
| 72 | 218.37 | 06B72 | 19 | 45 | 75 | 30 | 1.60 | 06A72 | 18 | 1.09 |
| 76 | 230.49 | 06B76 | 19 | 45 | 75 | 30 | 1.91 | 06A76 | 18 | 1.45 |
| 80 | 242.61 | 06B80 | 19 | 45 | 75 | 30 | 2.01 | 06A80 | 18 | 1.53 |
| 84 | 254.74 | 06B84 | 19 | 45 | 75 | 30 | 2.11 | 06A84 | 18 | 1.60 |
| 90 | 272.93 | 06B90 | 19 | 52 | 75 | 30 | 2.26 | 06A90 | 18 | 1.72 |
| 95 | 288.08 | 06B95 | 19 | 52 | 75 | 30 | 2.61 | 06A95 | 18 | 2.18 |
| 96 | 291.11 | 06B96 | 19 | 52 | 75 | 30 | 2.64 | 06A96 | 18 | 2.20 |
| 114 | 345.68 | 06B114 | 19 | 52 | 75 | 30 | 3.63 | 06A114 | 18 | 3.13 |

Maximum bores shown will accommodate standard keyseat and setscrew over keyseat. Slightly larger bores are possible with no keyseat, shallow keyseat, or setscrew at angle to keyseat.

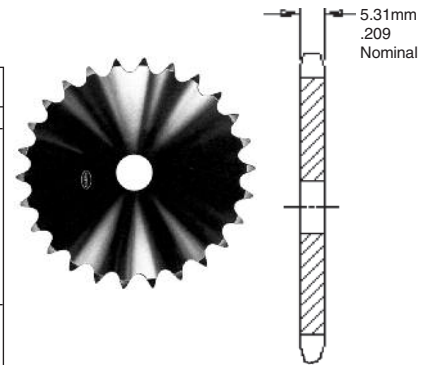

TYPE A

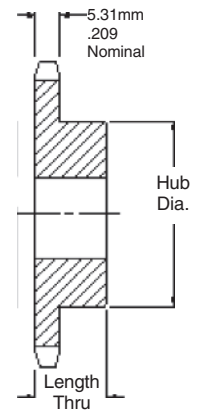

TYPE B



0.375 INCH (9.525mm) PITCH **SIMPLEX**

ISO **06B-1**
METRIC **35**

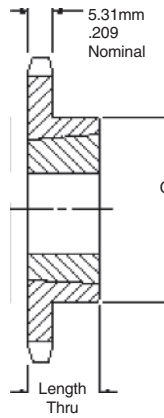

TYPE B

CHAIN DATA:
BS 228/3
ISO 06B-1
PITCH: 9.53mm (0.375 in.)
ROLLER DIAMETER: 6.35mm (0.250 in.)
ROLLER WIDTH: 5.72mm (0.225 in.)
TENSILE: 910 kilos (2000 lbs.)

Simplex-Taper Bushed — Steel

| No. Teeth | Pitch Diameter | Catalog Number | Bushing Number | Bore Max. | Dimension | | Weight | |
|-----------|----------------|----------------|----------------|-----------|-----------|--------|--------|---------|
| | MM | | | | L | C | Rim | Bushing |
| 18 | 54.85 | 06BTB18H | 1008 | 25.40 | 22.23 | 47.63* | 0.18 | 0.14 |
| 19 | 57.87 | 06BTB19H | 1008 | 25.40 | 22.23 | 46.04 | 0.23 | 0.14 |
| 20 | 60.89 | 06BTB20H | 1008 | 25.40 | 22.23 | 49.20 | 0.27 | 0.14 |
| 21 | 63.91 | 06BTB21H | 1008 | 25.40 | 22.23 | 52.39 | 0.32 | 0.14 |
| 22 | 66.93 | 06BTB22H | 1210 | 31.75 | 25.40 | 60.33 | 0.36 | 0.27 |
| 23 | 69.95 | 06BTB23H | 1210 | 31.75 | 25.40 | 61.91 | 0.41 | 0.27 |
| 24 | 72.97 | 06BTB24H | 1210 | 31.75 | 25.40 | 61.91 | 0.41 | 0.27 |
| 25 | 76.00 | 06BTB25H | 1210 | 31.75 | 25.40 | 61.91 | 0.54 | 0.27 |
| 26 | 79.02 | 06BTB26H | 1610 | 41.28 | 25.40 | 73.03* | 0.50 | 0.41 |
| 28 | 85.07 | 06BTB28H | 1610 | 41.28 | 25.40 | 73.03 | 0.54 | 0.41 |
| 30 | 91.12 | 06BTB30H | 1610 | 41.28 | 25.40 | 79.38 | 0.54 | 0.41 |
| 32 | 97.18 | 06BTB32 | 1610 | 41.28 | 25.40 | 82.55 | 0.59 | 0.41 |
| 35 | 106.26 | 06BTB35 | 1610 | 41.28 | 25.40 | 82.55 | 0.64 | 0.41 |
| 36 | 109.29 | 06BTB36 | 1610 | 41.28 | 25.40 | 82.55 | 0.64 | 0.41 |
| 38 | 115.35 | 06BTB38 | 1610 | 41.28 | 25.40 | 82.55 | 0.68 | 0.41 |
| 40 | 121.40 | 06BTB40 | 1610 | 41.28 | 25.40 | 82.55 | 0.86 | 0.41 |
| 45 | 136.55 | 06BTB45 | 1610 | 41.28 | 25.40 | 82.55 | 0.95 | 0.41 |
| 48 | 145.65 | 06BTB48 | 1610 | 41.28 | 25.40 | 82.55 | 1.04 | 0.41 |
| 54 | 163.82 | 06BTB54 | 1610 | 41.28 | 25.40 | 82.55 | 1.18 | 0.41 |
| 57 | 172.91 | 06BTB57 | 1610 | 41.28 | 25.40 | 82.55 | 1.25 | 0.41 |
| 60 | 182.00 | 06BTB60 | 1610 | 41.28 | 25.40 | 82.55 | 1.36 | 0.41 |
| 70 | 212.30 | 06BTB70 | 1610 | 41.28 | 25.40 | 82.55 | 1.68 | 0.41 |
| 76 | 230.49 | 06BTB76 | 1610 | 41.28 | 25.40 | 82.55 | 1.82 | 0.41 |
| 95 | 288.08 | 06BTB95 | 1610 | 41.28 | 25.40 | 82.55 | 2.28 | 0.41 |

*Has recessed groove in hub for chain clearance.
Sprockets with "H" suffix have hardened teeth.

Metric Sprockets

Martin

ISO **06B-2**
METRIC **35-2**

0.375 INCH (9.525mm) PITCH DUPLEX WIDTH CHAIN

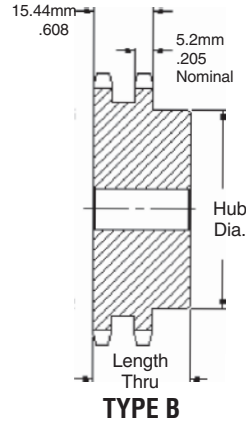

CHAIN DATA:

BS 228/3
ISO 06B-2
PITCH: 9.53mm (0.375 in.)
ROLLER DIAMETER: 6.35mm (0.250 in.)
ROLLER WIDTH: 5.72mm (0.225 in.)
TENSILE: 1730 kilos (3800 lbs.)

SPROCKETS

Duplex-Type B — Steel

| No. Teeth | Pitch Diameter | Catalog Number | Bore | | Hub | | Weight (Approx.) Kilos |
|-----------|----------------|----------------|----------|---------|---------|---------|------------------------|
| | MM | | Stock MM | Max. MM | Dia. MM | Thru MM | |
| 12 | 36.80 | D06B12 | 10 | 16 | 25 | 25 | 0.16 |
| 13 | 39.79 | D06B13 | 10 | 18 | 28 | 25 | 0.20 |
| 14 | 42.80 | D06B14 | 10 | 18 | 31 | 25 | 0.25 |
| 15 | 45.81 | D06B15 | 10 | 20 | 34 | 25 | 0.29 |
| 16 | 48.82 | D06B16 | 12 | 20 | 37 | 30 | 0.34 |
| 17 | 51.83 | D06B17 | 12 | 24 | 40 | 30 | 0.39 |
| 18 | 54.85 | D06B18 | 12 | 25 | 43 | 30 | 0.45 |
| 19 | 57.87 | D06B19 | 12 | 28 | 46 | 30 | 0.52 |
| 20 | 60.89 | D06B20 | 12 | 30 | 49 | 30 | 0.59 |
| 21 | 63.91 | D06B21 | 12 | 30 | 52 | 30 | 0.68 |
| 22 | 66.93 | D06B22 | 12 | 35 | 55 | 30 | 0.75 |
| 23 | 69.95 | D06B23 | 12 | 38 | 58 | 30 | 0.80 |
| 24 | 72.97 | D06B24 | 12 | 39 | 61 | 30 | 0.84 |
| 25 | 76.00 | D06B25 | 12 | 40 | 64 | 30 | 0.89 |
| 26 | 79.02 | D06B26 | 12 | 42 | 67 | 30 | 0.91 |
| 27 | 82.05 | D06B27 | 12 | 45 | 70 | 30 | 1.00 |
| 28 | 85.07 | D06B28 | 12 | 48 | 73 | 30 | 1.07 |
| 29 | 88.10 | D06B29 | 12 | 50 | 76 | 30 | 1.14 |
| 30 | 91.12 | D06B30 | 12 | 52 | 80 | 30 | 1.22 |
| 32 | 98.18 | D06B32 | 16 | 52 | 80 | 30 | 1.30 |
| 35 | 106.26 | D06B35 | 16 | 52 | 80 | 30 | 1.42 |
| 36 | 109.29 | D06B36 | 16 | 60 | 90 | 30 | 1.58 |
| 38 | 115.35 | D06B38 | 16 | 60 | 90 | 30 | 1.72 |
| 40 | 121.40 | D06B40 | 16 | 52 | 80 | 35 | 1.81 |
| 42 | 127.46 | D06B42 | 19 | 60 | 90 | 35 | 2.05 |
| 45 | 136.55 | D06B45 | 19 | 60 | 90 | 35 | 2.35 |
| 48 | 145.64 | D06B48 | 19 | 60 | 90 | 35 | 2.75 |
| 52 | 157.75 | D06B52 | 19 | 60 | 90 | 35 | 3.13 |
| 57 | 172.91 | D06B57 | 19 | 60 | 90 | 35 | 3.47 |
| 60 | 182.00 | D06B60 | 19 | 60 | 90 | 35 | 3.78 |
| 68 | 206.24 | D06B68 | 19 | 60 | 90 | 35 | 4.43 |
| 70 | 212.30 | D06B70 | 19 | 60 | 90 | 35 | 4.56 |
| 72 | 218.37 | D06B72 | 19 | 60 | 90 | 35 | 4.89 |
| 76 | 230.49 | D06B76 | 19 | 60 | 90 | 38 | 5.67 |
| 84 | 254.74 | D06B84 | 19 | 60 | 90 | 38 | 7.10 |
| 95 | 288.08 | D06B95 | 25 | 62 | 95 | 38 | 8.64 |
| 96 | 291.11 | D06B96 | 25 | 62 | 95 | 38 | 8.75 |
| 114 | 345.68 | D06B114 | 25 | 62 | 95 | 38 | 11.12 |

Maximum bores shown will accommodate standard keyseat and setscrew over keyseat. Slightly larger bores are possible with no keyseat, shallow keyseat, or setscrew at angle to keyseat.

0.375 INCH (9.525mm) PITCH DUPLEX WIDTH CHAINS

ISO 06B-2
METRIC 35-2

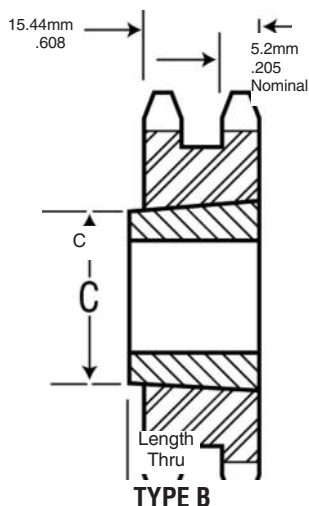

CHAIN DATA:

BS 228/3
ISO 06B-2
PITCH: 9.53mm (0.375 in.)
ROLLER DIAMETER: 6.35mm (0.250 in.)
ROLLER WIDTH: 5.72mm (0.225 in.)
TENSILE: 1730 kilos (3800 lbs.)

Duplex-Taper Bushed — Steel

| No. Teeth | Pitch Diameter | Catalog Number | Bushing Number | Bore Max. | Dimension | | Weight | |
|-----------|----------------|----------------|----------------|-----------|-----------|-------|--------|---------|
| | MM | | | | L | C | Rim | Bushing |
| | | | | MM | MM | MM | Kilos | Kilos |
| 19 | 57.87 | D06BTB19 | 1008 | 25.40 | 22.23 | 46.43 | 0.6 | 0.14 |
| 20 | 60.89 | D06BTB20 | 1008 | 25.40 | 22.23 | 49.20 | 0.8 | 0.14 |
| 21 | 63.91 | D06BTB21 | 1008 | 25.40 | 22.23 | 52.39 | 1.4 | 0.14 |
| 22 | 66.93 | D06BTB22 | 1008 | 25.40 | 22.23 | 55.56 | 1.7 | 0.14 |
| 24 | 72.97 | D06BTB24 | 1210 | 31.75 | 25.40 | 61.91 | 1.8 | 0.27 |
| 25 | 76.00 | D06BTB25 | 1210 | 31.75 | 25.40 | 61.91 | 1.9 | 0.27 |
| 26 | 79.02 | D06BTB26 | 1210 | 31.75 | 25.40 | 66.68 | 2.0 | 0.27 |
| 30 | 91.12 | D06BTB30 | 1610 | 41.28 | 25.40 | 79.38 | 1.8 | 0.41 |
| 32 | 97.18 | D06BTB32 | 1610 | 41.28 | 25.40 | 82.55 | 2.0 | 0.41 |
| 35 | 106.26 | D06BTB35 | 1610 | 41.28 | 25.40 | 82.55 | 2.3 | 0.41 |
| 38 | 115.34 | D06BTB38 | 1610 | 41.28 | 25.40 | 82.55 | 2.5 | 0.41 |
| 40 | 121.40 | D06BTB40 | 1610 | 41.28 | 25.40 | 82.55 | 2.9 | 0.41 |
| 45 | 136.55 | D06BTB45 | 1610 | 41.28 | 25.40 | 82.55 | 3.2 | 0.41 |
| 48 | 145.65 | D06BTB48 | 1610 | 41.28 | 25.40 | 92.08 | 3.5 | 0.41 |
| 54 | 163.82 | D06BTB54 | 1610 | 41.28 | 25.40 | 92.08 | 3.9 | 0.41 |
| 57 | 172.91 | D06BTB57 | 1610 | 41.28 | 25.40 | 92.08 | 4.1 | 0.41 |
| 60 | 182.00 | D06BTB60 | 1610 | 41.28 | 25.40 | 92.08 | 4.9 | 0.41 |
| 70 | 212.30 | D06BTB70 | 1610 | 41.28 | 25.40 | 92.08 | 6.3 | 0.41 |
| 76 | 230.49 | D06BTB76 | 1610 | 41.28 | 25.40 | 92.08 | 6.8 | 0.41 |
| 95 | 288.08 | D06BTB95 | 1610 | 41.28 | 25.40 | 92.08 | 6.9 | 0.41 |

Metric Sprockets

Martin

ISO **06B-3**
METRIC **35-3**

0.375 INCH (9.525mm) PITCH TRIPLEX

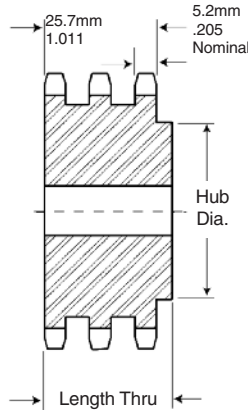

TYPE B

CHAIN DATA:

BS 228/3
ISO 06B-3
PITCH: 9.53mm (0.375 in.)
ROLLER DIAMETER: 6.35mm (0.250 in.)
ROLLER WIDTH: 5.72mm (0.225 in.)
TENSILE: 2540 kilos (5600 lbs.)

SPROCKETS

Triplex-Type B — Steel

| No. Teeth | Pitch Diameter | Catalog Number | Bore | | Hub | | Weight (Approx.) Kilos |
|-----------|----------------|----------------|-------|------|------|------|------------------------|
| | | | Stock | Max. | Dia. | Thru | |
| | MM | | MM | MM | MM | MM | |
| 12 | 36.80 | E06B12 | 12 | 16 | 25 | 35 | 0.23 |
| 13 | 39.80 | E06B13 | 12 | 18 | 28 | 35 | 0.27 |
| 14 | 42.80 | E06B14 | 12 | 18 | 31 | 35 | 0.32 |
| 15 | 45.81 | E06B15 | 12 | 20 | 34 | 35 | 0.36 |
| 16 | 48.82 | E06B16 | 12 | 20 | 37 | 35 | 0.45 |
| 17 | 51.84 | E06B17 | 12 | 24 | 40 | 35 | 0.54 |
| 18 | 54.85 | E06B18 | 12 | 25 | 43 | 35 | 0.64 |
| 19 | 57.87 | E06B19 | 12 | 28 | 46 | 35 | 0.72 |
| 20 | 60.89 | E06B20 | 12 | 30 | 49 | 35 | 0.77 |
| 21 | 63.91 | E06B21 | 14 | 30 | 52 | 40 | 0.86 |
| 22 | 66.93 | E06B22 | 14 | 35 | 54 | 40 | 0.95 |
| 23 | 69.95 | E06B23 | 14 | 38 | 58 | 40 | 1.04 |
| 24 | 72.97 | E06B24 | 14 | 39 | 61 | 40 | 1.18 |
| 25 | 76.00 | E06B25 | 14 | 40 | 64 | 40 | 1.27 |
| 26 | 79.02 | E06B26 | 14 | 42 | 67 | 40 | 1.31 |
| 27 | 82.05 | E06B27 | 14 | 45 | 70 | 40 | 1.36 |
| 28 | 85.07 | E06B28 | 14 | 48 | 73 | 40 | 1.50 |
| 29 | 88.10 | E06B29 | 14 | 50 | 76 | 40 | 1.68 |
| 30 | 91.12 | E06B30 | 14 | 52 | 80 | 40 | 1.72 |
| 32 | 97.18 | E06B32 | 16 | 52 | 80 | 48 | 2.00 |
| 35 | 106.26 | E06B35 | 16 | 52 | 80 | 48 | 2.25 |
| 36 | 109.29 | E06B36 | 16 | 60 | 90 | 40 | 2.33 |
| 38 | 115.34 | E06B38 | 16 | 60 | 90 | 40 | 2.49 |
| 40 | 121.40 | E06B40 | 16 | 52 | 80 | 48 | 2.65 |
| 42 | 127.46 | E06B42 | 19 | 60 | 90 | 48 | 2.81 |
| 45 | 136.55 | E06B45 | 19 | 60 | 90 | 48 | 3.00 |
| 48 | 145.64 | E06B48 | 19 | 60 | 90 | 48 | 3.20 |
| 52 | 157.75 | E06B52 | 19 | 60 | 90 | 48 | 3.46 |
| 57 | 172.91 | E06B57 | 19 | 60 | 90 | 48 | 4.77 |
| 60 | 182.00 | E06B60 | 19 | 60 | 80 | 48 | 5.02 |
| 68 | 206.24 | E06B68 | 19 | 60 | 90 | 48 | 5.69 |
| 72 | 218.37 | E06B72 | 19 | 60 | 90 | 48 | 6.02 |
| 76 | 230.49 | E06B76 | 19 | 64 | 100 | 48 | 8.48 |
| 84 | 254.74 | E06B84 | 19 | 64 | 100 | 48 | 9.37 |
| 95 | 288.08 | E06B95 | 25 | 64 | 100 | 54 | 13.61 |
| 96 | 291.11 | E06B96 | 25 | 64 | 100 | 54 | 13.75 |
| 114 | 345.68 | E06B114 | 25 | 64 | 100 | 54 | 17.48 |

0.500 INCH (12.70mm) PITCH SIMPLEX

ISO **08B-1**
METRIC **40**

CHAIN DATA:

BS 228/7

ISO 08B-1

PITCH: 12.70mm (0.500 in.)

ROLLER DIAMETER: 8.51mm (0.335 in.)

ROLLER WIDTH: 7.75mm (0.305 in.)

TENSILE: 1820 kilos (4000 lbs.)

Simplex-Type B — Steel

Simplex-Type A — Steel

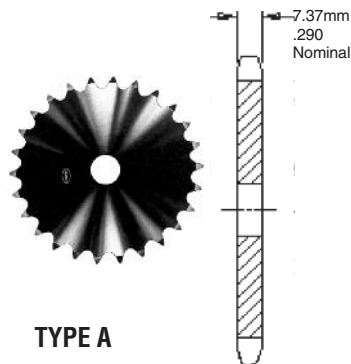

TYPE A

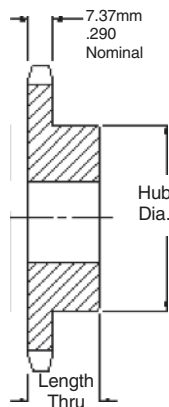

TYPE B

| No. Teeth | Pitch Diameter MM | Catalog Number | Bore | | Hub | | Weight (Approx.) Kilos | Catalog Number | Bore Stock MM | Weight (Approx.) Kilos |
|-----------|----------------------|----------------|-------------|------------|------------|------------|------------------------------|----------------|---------------------|------------------------------|
| | | | Stock MM | Max. MM | Dia. MM | Thru MM | | | | |
| 9 | 37.13 | 08B9 | 10 | 15 | 21 | 25 | 0.14 | 08A12 | 10 | 0.08 |
| 10 | 41.10 | 08B10 | 10 | 20 | 26 | 25 | 0.15 | | 10 | 0.1 |
| 11 | 45.08 | 08B11 | 10 | 22 | 30 | 25 | 0.17 | | 10 | 0.12 |
| 12 | 49.07 | 08B12 | 10 | 22 | 34 | 28 | 0.24 | | 10 | 0.14 |
| 13 | 53.07 | 08B13 | 10 | 25 | 38 | 28 | 0.25 | 08A13 | 10 | 0.15 |
| 14 | 57.07 | 08B14 | 10 | 28 | 42 | 28 | 0.31 | 08A14 | 10 | 0.16 |
| 15 | 61.08 | 08B15 | 10 | 30 | 46 | 28 | 0.33 | 08A15 | 10 | 0.2 |
| 16 | 65.10 | 08B16 | 12 | 32 | 50 | 28 | 0.37 | 08A16 | 10 | 0.21 |
| 17 | 69.12 | 08B17 | 12 | 35 | 54 | 28 | 0.51 | 08A17 | 10 | 0.25 |
| 18 | 73.14 | 08B18 | 12 | 38 | 57 | 28 | 0.54 | 08A18 | 10 | 0.26 |
| 19 | 77.16 | 08B19 | 12 | 40 | 64 | 28 | 0.65 | 08A19 | 10 | 0.3 |
| 20 | 81.18 | 08B20 | 12 | 42 | 67 | 28 | 0.76 | 08A20 | 10 | 0.33 |
| 21 | 85.21 | 08B21 | 12 | 45 | 70 | 28 | 0.82 | 08A21 | 12 | 0.37 |
| 22 | 89.24 | 08B22 | 12 | 48 | 73 | 28 | 0.88 | 08A22 | 12 | 0.4 |
| 23 | 93.27 | 08B23 | 12 | 51 | 78 | 28 | 1.05 | 08A23 | 12 | 0.43 |
| 24 | 97.30 | 08B24 | 14 | 53 | 82 | 28 | 1.05 | 08A24 | 12 | 0.44 |
| 25 | 101.33 | 08B25 | 14 | 53 | 82 | 28 | 1.13 | 08A25 | 12 | 0.55 |
| 26 | 105.36 | 08B26 | 16 | 53 | 82 | 30 | 1.15 | 08A26 | 16 | 0.57 |
| 27 | 109.40 | 08B27 | 16 | 53 | 82 | 30 | 1.19 | 08A27 | 16 | 0.64 |
| 28 | 113.43 | 08B28 | 16 | 53 | 82 | 30 | 1.30 | 08A28 | 16 | 0.67 |
| 29 | 117.46 | 08B29 | 16 | 53 | 82 | 30 | 1.33 | 08A29 | 16 | 0.71 |
| 30 | 121.50 | 08B30 | 16 | 53 | 89 | 30 | 1.36 | 08A30 | 15 | 0.74 |
| 31 | 125.53 | 08B31 | 16 | 60 | 89 | 30 | 1.41 | 08A31 | 15 | 0.77 |
| 32 | 129.57 | 08B32 | 16 | 60 | 89 | 30 | 1.46 | 08A32 | 15 | 0.83 |
| 33 | 133.61 | 08B33 | 16 | 60 | 89 | 30 | 1.51 | 08A33 | 15 | 0.87 |
| 34 | 137.64 | 08B34 | 16 | 60 | 89 | 30 | 1.56 | 08A34 | 15 | 0.91 |
| 35 | 141.68 | 08B35 | 16 | 60 | 89 | 30 | 1.61 | 08A35 | 15 | 0.92 |
| 36 | 145.72 | 08B36 | 16 | 60 | 89 | 35 | 1.69 | 08A36 | 15 | 1.01 |
| 37 | 149.75 | 08B37 | 16 | 60 | 89 | 35 | 1.74 | 08A37 | 15 | 1.13 |
| 38 | 153.79 | 08B38 | 16 | 60 | 89 | 35 | 1.78 | 08A38 | 15 | 1.43 |
| 39 | 157.83 | 08B39 | 19 | 60 | 89 | 35 | 1.83 | 08A39 | 18 | 1.46 |
| 40 | 161.87 | 08B40 | 19 | 60 | 89 | 35 | 1.88 | 08A40 | 18 | 2.01 |
| 42 | 169.94 | 08B42 | 19 | 60 | 89 | 35 | 1.97 | 08A42 | 18 | 2.27 |
| 45 | 182.06 | 08B45 | 19 | 60 | 89 | 35 | 2.11 | 08A45 | 18 | 2.03 |
| 48 | 194.18 | 08B48 | 19 | 64 | 100 | 35 | 2.76 | 08A48 | 18 | 2.17 |
| 54 | 218.42 | 08B54 | 19 | 64 | 100 | 35 | 3.11 | 08A54 | 18 | 3.28 |
| 57 | 230.54 | 08B57 | 19 | 64 | 100 | 35 | 3.28 | 08A57 | 18 | 3.51 |
| 60 | 242.66 | 08B60 | 19 | 64 | 100 | 35 | 3.45 | 08A60 | 18 | 3.70 |
| 64 | 258.83 | 08B64 | 19 | 64 | 100 | 35 | 3.68 | 08A64 | 18 | 4.63 |
| 70 | 283.07 | 08B70 | 19 | 64 | 100 | 35 | 4.02 | 08A70 | 18 | 4.57 |
| 72 | 291.15 | 08B72 | 19 | 64 | 100 | 35 | 4.13 | 08A72 | 18 | 5.45 |
| 76 | 307.32 | 08B76 | 19 | 64 | 100 | 35 | 5.73 | 08A76 | 18 | 5.51 |
| 80 | 323.49 | 08B80 | 19 | 64 | 100 | 35 | 6.03 | 08A80 | 18 | 6.54 |
| 84 | 339.65 | 08B84 | 19 | 64 | 100 | 35 | 6.33 | 08A84 | 18 | |
| 95 | 384.11 | 08B95 | 25 | 64 | 100 | 35 | 8.90 | 08A95 | 24 | |
| 96 | 388.15 | 08B96 | 25 | 64 | 100 | 35 | 8.99 | 08A96 | 24 | |
| 114 | 460.91 | 08B114 | 25 | 64 | 100 | 35 | 11.17 | 08A114 | 24 | |

Maximum bores shown will accommodate standard keyseat and setscrew over keyseat. Slightly larger bores are possible with no keyseat, shallow keyseat, or setscrew at angle to keyseat.

Metric Sprockets

Martin

ISO **08B-1**
METRIC **40**

0.500 INCH (12.70mm) PITCH **SIMPLEX**

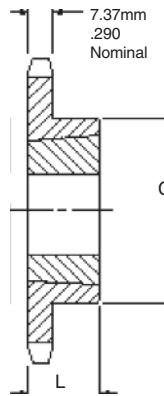

TYPE B

CHAIN DATA:

BS 228/7

ISO 08B-1

PITCH: 12.70mm (0.500 in.)

ROLLER DIAMETER: 8.51mm (0.335 in.)

ROLLER WIDTH: 7.75mm (0.305 in.)

TENSILE: 1820 kilos (4000 lbs.)

SPROCKETS

Simplex-Taper Bushed — Steel

| No. Teeth | Pitch Diameter | Catalog Number | Bushing Number | Bore Max. MM | Dimension | | Weight | |
|-----------|----------------|----------------|----------------|-----------------|-----------|---------|--------------|------------------|
| | MM | | | | L MM | C MM | Rim Kilos | Bushing Kilos |
| 14 | 57.07 | 08BTB14H | 1008 | 25.40 | 22.23 | 46* | 0.18 | 0.14 |
| 15 | 61.08 | 08BTB15H | 1008 | 25.40 | 22.23 | 46 | 0.18 | 0.14 |
| 16 | 65.10 | 08BTB16H | 1008 | 25.40 | 22.23 | 46 | 0.23 | 0.14 |
| 17 | 69.12 | 08BTB17H | 1210 | 31.75 | 25.40 | 60* | 0.23 | 0.14 |
| 18 | 73.14 | 08BTB18H | 1210 | 31.75 | 25.40 | 62* | 0.27 | 0.27 |
| 19 | 77.16 | 08BTB19H | 1210 | 31.75 | 25.40 | 62 | 0.32 | 0.27 |
| 20 | 81.18 | 08BTB20H | 1610 | 41.28 | 25.40 | 70* | 0.41 | 0.41 |
| 21 | 85.21 | 08BTB21H | 1610 | 41.28 | 25.40 | 70 | 0.45 | 0.41 |
| 22 | 89.24 | 08BTB22H | 1610 | 41.28 | 25.40 | 70 | 0.50 | 0.41 |
| 23 | 93.27 | 08BTB23H | 1610 | 41.28 | 25.40 | 76 | 0.59 | 0.41 |
| 24 | 97.30 | 08BTB24H | 1610 | 41.28 | 25.40 | 82 | 0.73 | 0.41 |
| 25 | 101.33 | 08BTB25H | 1610 | 41.28 | 25.40 | 82 | 0.73 | 0.41 |
| 26 | 105.36 | 08BTB26H | 1610 | 41.28 | 25.40 | 82 | 0.73 | 0.41 |
| 27 | 109.40 | 08BTB27H | 1610 | 41.28 | 25.40 | 76 | 0.70 | 0.41 |
| 28 | 113.43 | 08BTB28H | 1610 | 41.28 | 25.40 | 76 | 0.73 | 0.41 |
| 29 | 117.46 | 08BTB29H | 1610 | 41.28 | 25.40 | 76 | 0.76 | 0.41 |
| 30 | 121.50 | 08BTB30H | 1610 | 41.28 | 25.40 | 73 | 0.82 | 0.41 |
| 32 | 129.57 | 08BTB32 | 1610 | 41.28 | 25.40 | 76 | 0.87 | 0.41 |
| 35 | 141.68 | 08BTB35 | 1610 | 41.28 | 25.40 | 76 | 0.96 | 0.41 |
| 36 | 145.72 | 08BTB36 | 1610 | 41.28 | 25.40 | 76 | 0.98 | 0.41 |
| 38 | 153.79 | 08BTB38 | 1610 | 41.28 | 25.40 | 76 | 1.23 | 0.41 |
| 40 | 161.87 | 08BTB40 | 1610 | 41.28 | 25.40 | 76 | 1.29 | 0.41 |
| 42 | 169.94 | 08BTB42 | 1610 | 41.28 | 25.40 | 76 | 1.36 | 0.41 |
| 45 | 182.06 | 08BTB45 | 1610 | 41.28 | 25.40 | 76 | 1.46 | 0.41 |
| 48 | 194.18 | 08BTB48 | 1610 | 41.28 | 25.40 | 76 | 1.55 | 0.41 |
| 54 | 218.42 | 08BTB54 | 1610 | 41.28 | 25.40 | 76 | 1.75 | 0.41 |
| 57 | 230.54 | 08BTB57 | 1610 | 41.28 | 25.40 | 76 | 2.63 | 0.41 |
| 60 | 242.66 | 08BTB60 | 1610 | 41.28 | 25.40 | 76 | 2.77 | 0.41 |
| 70 | 283.07 | 08BTB70 | 2012 | 50.80 | 31.75 | 90 | 3.93 | 0.41 |
| 72 | 291.15 | 08BTB72 | 2012 | 50.80 | 31.75 | 90 | 4.05 | 0.41 |
| 76 | 307.32 | 08BTB76 | 2012 | 50.80 | 31.75 | 90 | 4.27 | 0.77 |
| 80 | 323.49 | 08BTB80 | 2012 | 50.80 | 31.75 | 90 | 4.49 | 0.77 |
| 84 | 339.65 | 08BTB84 | 2012 | 50.80 | 31.75 | 90 | 4.72 | 0.77 |
| 95 | 384.11 | 08BTB95 | 2012 | 50.80 | 31.75 | 90 | 6.81 | 0.77 |
| 96 | 388.15 | 08BTB96 | 2012 | 50.80 | 31.75 | 90 | 6.88 | 0.77 |
| 114 | 460.91 | 08BTB114 | 2517 | 63.50 | 44.45 | 108 | 10.44 | 0.77 |

* Has recessed groove in hub for chain clearance.
Sprockets with "H" suffix have hardened teeth.

0.500 INCH (12.70mm) PITCH DUPLEX

ISO 08B-2
METRIC 40-2

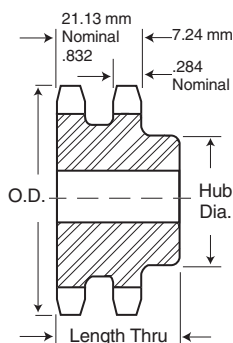

TYPE B

CHAIN DATA:

BS 228/7

ISO 08B-2

PITCH: 12.70mm (0.500 in.)

ROLLER DIAMETER: 8.51mm (0.335 in.)

ROLLER WIDTH: 7.75mm (0.305 in.)

TENSILE: 3180 kilos (7000 lbs.)

Duplex-Type B — Steel

| No. Teeth | Pitch Diameter MM | Catalog Number | Bore | | Hub | | Weight (Approx.) Kilos |
|-----------|----------------------|----------------|-------|------|------|------|---------------------------|
| | | | Stock | Max. | Dia. | Thru | |
| | | | MM | MM | MM | MM | |
| 10 | 41.10 | D08B10 | 10 | 18 | 26 | 32 | 0.22 |
| 11 | 45.08 | D08B11 | 11 | 21 | 30 | 35 | 0.22 |
| 12 | 49.07 | D08B12 | 12 | 23 | 34 | 35 | 0.26 |
| 13 | 53.07 | D08B13 | 12 | 25 | 38 | 35 | 0.28 |
| 14 | 57.07 | D08B14 | 12 | 28 | 42 | 35 | 0.34 |
| 15 | 61.08 | D08B15 | 12 | 30 | 46 | 35 | 0.36 |
| 16 | 65.10 | D08B16 | 14 | 33 | 50 | 35 | 0.35 |
| 17 | 69.12 | D08B17 | 14 | 36 | 54 | 35 | 0.44 |
| 18 | 73.14 | D08B18 | 14 | 38 | 58 | 35 | 0.49 |
| 19 | 77.16 | D08B19 | 14 | 40 | 62 | 35 | 0.57 |
| 20 | 81.18 | D08B20 | 14 | 40 | 66 | 35 | 0.65 |
| 21 | 85.21 | D08B21 | 16 | 45 | 70 | 40 | 0.72 |
| 22 | 89.24 | D08B22 | 16 | 45 | 70 | 40 | 0.73 |
| 23 | 93.27 | D08B23 | 16 | 45 | 70 | 40 | 0.83 |
| 24 | 97.30 | D08B24 | 16 | 50 | 75 | 40 | 0.94 |
| 25 | 101.33 | D08B25 | 16 | 52 | 80 | 40 | 0.98 |
| 26 | 105.36 | D08B26 | 20 | 56 | 85 | 40 | 1.04 |
| 27 | 109.40 | D08B27 | 20 | 56 | 85 | 40 | 1.08 |
| 28 | 113.43 | D08B28 | 20 | 60 | 90 | 40 | 1.10 |
| 29 | 117.46 | D08B29 | 20 | 62 | 95 | 40 | 1.14 |
| 30 | 121.50 | D08B30 | 20 | 64 | 100 | 40 | 1.16 |
| 32 | 129.57 | D08B32 | 20 | 64 | 100 | 40 | 1.24 |
| 35 | 141.68 | D08B35 | 20 | 64 | 100 | 40 | 1.35 |
| 36 | 145.72 | D08B36 | 20 | 73 | 110 | 40 | 2.05 |
| 38 | 153.79 | D08B38 | 20 | 73 | 110 | 45 | 2.17 |
| 40 | 161.87 | D08B40 | 20 | 73 | 110 | 45 | 2.28 |
| 42 | 169.94 | D08B42 | 20 | 73 | 110 | 45 | 2.32 |
| 45 | 182.06 | D08B45 | 20 | 73 | 110 | 45 | 2.49 |
| 48 | 194.18 | D08B48 | 20 | 73 | 110 | 45 | 2.65 |
| 54 | 218.42 | D08B54 | 25 | 73 | 110 | 45 | 2.98 |
| 57 | 230.54 | D08B57 | 25 | 73 | 110 | 45 | 3.88 |
| 60 | 242.66 | D08B60 | 25 | 73 | 110 | 45 | 4.08 |
| 68 | 283.07 | D08B68 | 25 | 73 | 110 | 45 | 4.63 |
| 72 | 291.16 | D08B72 | 25 | 73 | 110 | 45 | 4.90 |
| 76 | 307.32 | D08B76 | 30 | 80 | 120 | 45 | 6.60 |
| 84 | 339.65 | D08B84 | 30 | 80 | 120 | 45 | 7.29 |
| 95 | 384.11 | D08B95 | 30 | 80 | 120 | 45 | 9.89 |
| 96 | 388.15 | D08B96 | 30 | 80 | 120 | 45 | 9.99 |
| 114 | 460.90 | D08B114 | 30 | 80 | 120 | 45 | 12.88 |

Maximum bores shown will accommodate standard keyseat and setscrew over keyseat. Slightly larger bores are possible with no keyseat, shallow keyseat, or setscrew at angle to keyseat.

Metric Sprockets

Martin

ISO **08B-2**
METRIC **40-2**

0.500 INCH (12.70mm) PITCH **DUPLEX**

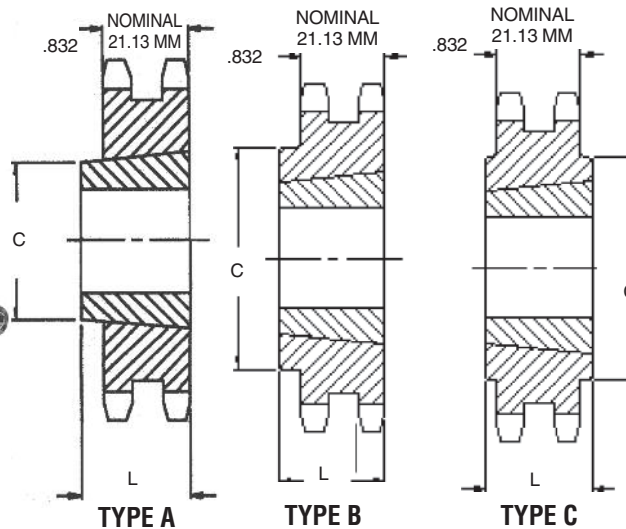

CHAIN DATA:
BS 228/7
ISO 08B-2
PITCH: 12.70mm (0.500 in.)
ROLLER DIAMETER: 8.51mm (0.335 in.)
ROLLER WIDTH: 7.75mm (0.305 in.)
TENSILE: 3180 kilos (7000 lbs.)

SPROCKETS

Duplex-Taper Bushed — Steel

| No. Teeth | Pitch Diameter | Catalog Number | Bushing Number | Bore Max. | Dimension | | Weight | |
|-----------|----------------|----------------|----------------|-----------|-----------|-----|--------|---------|
| | MM | | | | L | C | Rim | Bushing |
| | | | | MM | MM | MM | Kilos | Kilos |
| 15 | 61.08 | D08ATB15 | 1008 | 25.40 | 22.22 | | 0.18 | 0.13 |
| 16 | 65.10 | D08ATB16 | 1008 | 25.40 | 22.22 | | 0.22 | 0.13 |
| 17 | 69.12 | D08ATB17 | 1008 | 25.40 | 22.22 | | 0.27 | 0.13 |
| 18 | 73.14 | D08BTB18 | 1210 | 31.75 | 25.40 | 58 | 0.27 | 0.27 |
| 19 | 77.16 | D08BTB19 | 1210 | 31.75 | 25.40 | 63 | 0.36 | 0.27 |
| 20 | 81.18 | D08BTB20 | 1610 | 41.27 | 25.40 | 70 | 0.37 | 0.41 |
| 21 | 85.21 | D08BTB21 | 1610 | 41.27 | 25.40 | 70 | 0.46 | 0.41 |
| 22 | 89.24 | D08BTB22 | 1610 | 41.27 | 25.40 | 74 | 0.55 | 0.41 |
| 23 | 93.27 | D08BTB23 | 1610 | 41.27 | 25.40 | 78 | 0.59 | 0.41 |
| 24 | 97.30 | D08BTB24 | 2012 | 41.27 | 25.40 | 83 | 0.70 | 0.41 |
| 25 | 101.33 | D08BTB25 | 2012 | 50.80 | 31.75 | 87 | 0.77 | 0.77 |
| 26 | 105.36 | D08BTB26 | 2012 | 50.80 | 31.75 | 87 | 0.80 | 0.77 |
| 28 | 113.43 | D08BTB28 | 2012 | 50.80 | 31.75 | 99 | 1.06 | 0.77 |
| 30 | 121.50 | D08BTB30 | 2012 | 50.80 | 31.75 | 108 | 1.59 | 0.77 |
| 35 | 141.68 | D08BTB35 | 2012 | 50.80 | 31.75 | 108 | 1.86 | 0.77 |
| 36 | 145.72 | D08BTB36 | 2012 | 50.80 | 31.75 | 108 | 1.91 | 0.77 |
| 38 | 153.79 | D08BTB38 | 2012 | 50.80 | 31.75 | 108 | 3.18 | 0.77 |
| 42 | 169.94 | D08CTB42 | 2517 | 50.80 | 44.45 | 108 | 5.57 | 1.59 |
| 45 | 182.06 | D08CTB45 | 2517 | 63.50 | 44.45 | 108 | 5.97 | 1.59 |
| 48 | 194.18 | D08CTB48 | 2517 | 63.50 | 44.45 | 108 | 6.37 | 1.59 |
| 54 | 218.42 | D08CTB54 | 2517 | 63.50 | 44.45 | 108 | 7.17 | 1.59 |
| 57 | 230.54 | D08CTB57 | 2517 | 63.50 | 44.45 | 108 | 7.56 | 1.59 |
| 60 | 242.66 | D08CTB60 | 2517 | 63.50 | 44.45 | 108 | 12.05 | 1.59 |
| 68 | 274.99 | D08CTB68 | 2517 | 63.50 | 44.45 | 108 | 13.66 | 1.59 |
| 70 | 283.07 | D08CTB70 | 2517 | 63.50 | 44.45 | 108 | 14.06 | 1.59 |
| 72 | 291.15 | D08CTB72 | 2517 | 63.50 | 44.45 | 108 | 14.46 | 1.59 |
| 76 | 307.32 | D08CTB76 | 2517 | 63.50 | 44.45 | 108 | 15.26 | 1.59 |
| 84 | 339.65 | D08CTB84 | 2517 | 63.50 | 44.45 | 108 | 16.87 | 1.59 |
| 95 | 384.11 | D08CTB95 | 2517 | 63.50 | 44.45 | 108 | 19.08 | 1.59 |
| 96 | 388.15 | D08CTB96 | 2517 | 63.50 | 44.45 | 108 | 19.28 | 1.59 |
| 114 | 460.91 | D08CTB114 | 2517 | 63.50 | 44.45 | 108 | 22.90 | 1.59 |

0.500 INCH (12.70mm) PITCH TRIPLEX

ISO **08B-3**
METRIC **40-3**

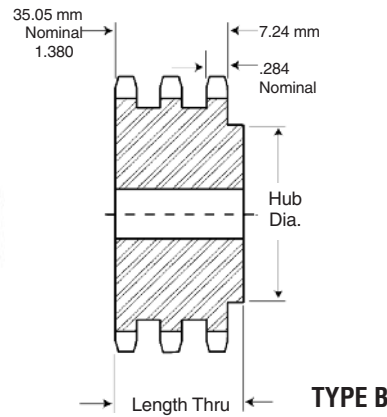

CHAIN DATA:

BS 228/7

ISO 08B-3

PITCH: 12.70mm (0.500 in.)

ROLLER DIAMETER: 8.51mm (0.335 in.)

ROLLER WIDTH: 7.75mm (0.305 in.)

TENSILE: 4540 kilos (10,000 lbs.)

Triplex-Type B — Steel

| No. Teeth | Pitch Diameter | Catalog Number | Bore | | Hub | | Weight (Approx.) Kilos |
|-----------|----------------|----------------|-------|------|------|------|------------------------|
| | MM | | Stock | Max. | Dia. | Thru | |
| | MM | | MM | MM | MM | MM | |
| 11 | 45.08 | E08B11 | 14 | 22 | 30 | 50 | 0.32 |
| 12 | 49.07 | E08B12 | 14 | 24 | 34 | 50 | 0.45 |
| 13 | 53.06 | E08B13 | 14 | 25 | 38 | 50 | 0.59 |
| 14 | 57.07 | E08B14 | 14 | 28 | 42 | 50 | 0.72 |
| 15 | 61.08 | E08B15 | 14 | 31 | 46 | 50 | 0.81 |
| 16 | 65.10 | E08B16 | 16 | 35 | 50 | 50 | 0.90 |
| 17 | 69.12 | E08B17 | 16 | 36 | 54 | 50 | 1.04 |
| 18 | 73.14 | E08B18 | 16 | 38 | 58 | 50 | 1.22 |
| 19 | 77.16 | E08B19 | 16 | 40 | 62 | 50 | 1.41 |
| 20 | 81.18 | E08B20 | 16 | 40 | 66 | 50 | 1.58 |
| 21 | 85.21 | E08B21 | 20 | 45 | 70 | 55 | 1.81 |
| 22 | 89.24 | E08B22 | 20 | 45 | 70 | 55 | 2.03 |
| 23 | 93.27 | E08B23 | 20 | 45 | 70 | 55 | 2.27 |
| 24 | 97.30 | E08B24 | 20 | 50 | 75 | 55 | 2.44 |
| 25 | 101.33 | E08B25 | 20 | 52 | 80 | 55 | 2.54 |
| 26 | 105.36 | E08B26 | 20 | 56 | 85 | 55 | 2.85 |
| 27 | 109.40 | E08B27 | 20 | 56 | 85 | 55 | 2.85 |
| 28 | 113.43 | E08B28 | 20 | 60 | 90 | 55 | 3.16 |
| 29 | 117.46 | E08B29 | 20 | 62 | 95 | 55 | 3.34 |
| 30 | 121.50 | E08B30 | 20 | 64 | 100 | 55 | 3.48 |
| 35 | 141.68 | E08B35 | 20 | 73 | 110 | 55 | 4.79 |
| 36 | 145.72 | E08B36 | 25 | 80 | 120 | 55 | 5.43 |
| 38 | 153.79 | E08B38 | 25 | 80 | 120 | 60 | 6.49 |
| 42 | 169.94 | E08B42 | 25 | 80 | 120 | 60 | 7.17 |
| 45 | 182.06 | E08B45 | 25 | 80 | 120 | 60 | 7.69 |
| 48 | 194.18 | E08B48 | 25 | 80 | 120 | 60 | 8.20 |
| 52 | 210.34 | E08B52 | 25 | 80 | 120 | 60 | 8.88 |
| 54 | 218.43 | E08B54 | 25 | 80 | 120 | 60 | 9.22 |
| 57 | 230.54 | E08B57 | 25 | 80 | 120 | 60 | 12.62 |
| 60 | 242.66 | E08B60 | 25 | 85 | 130 | 65 | 13.84 |
| 68 | 274.99 | E08B68 | 25 | 85 | 130 | 65 | 15.69 |
| 72 | 291.15 | E08B72 | 25 | 85 | 130 | 65 | 16.61 |
| 76 | 307.32 | E08B76 | 30 | 85 | 130 | 65 | 22.23 |
| 84 | 339.65 | E08B84 | 30 | 85 | 130 | 65 | 24.57 |
| 95 | 384.11 | E08B95 | 30 | 85 | 130 | 65 | 33.11 |
| 114 | 460.91 | E08B114 | 30 | 85 | 130 | 65 | 41.90 |

Maximum bores shown will accommodate standard keyseat and setscrew over keyseat. Slightly larger bores are possible with no keyseat, shallow keyseat, or setscrew at angle to keyseat.

Metric Sprockets

Martin

ISO **10B-1**
METRIC **50**

0.625 INCH (15.88mm) PITCH **SIMPLEX**

Simplex-Type B — Steel

Simplex-Type A — Steel

| No. Teeth | Pitch Diameter MM | Catalog Number | Bore | | Hub | | Weight (Approx.) Kilos | Catalog Number | Bore Stock MM | Weight (Approx.) Kilos |
|-----------|----------------------|----------------|-------------|------------|------------|------------|------------------------------|----------------|---------------------|------------------------------|
| | | | Stock MM | Max. MM | Dia. MM | Thru MM | | | | |
| 8 | 41.48 | 10B8 | 12 | 16 | 22 | 25 | 0.09 | | | |
| 9 | 46.42 | 10B9 | 12 | 19 | 27 | 25 | 0.14 | | | |
| 10 | 51.37 | 10B10 | 12 | 22 | 32 | 25 | 0.23 | | | |
| 11 | 56.35 | 10B11 | 12 | 25 | 37 | 25 | 0.27 | | | |
| 12 | 61.34 | 10B12 | 12 | 32 | 43 | 25 | 0.32 | 10A12 | 12 | 0.15 |
| 13 | 66.33 | 10B13 | 12 | 33 | 48 | 25 | 0.36 | 10A13 | 12 | 0.19 |
| 14 | 71.34 | 10B14 | 12 | 36 | 53 | 25 | 0.45 | 10A14 | 12 | 0.23 |
| 15 | 76.36 | 10B15 | 12 | 38 | 57 | 25 | 0.59 | 10A15 | 12 | 0.25 |
| 16 | 81.37 | 10B16 | 12 | 44 | 63 | 25 | 0.68 | 10A16 | 12 | 0.31 |
| 17 | 86.39 | 10B17 | 12 | 47 | 67 | 25 | 0.82 | 10A17 | 12 | 0.35 |
| 18 | 91.42 | 10B18 | 12 | 48 | 73 | 25 | 0.91 | 10A18 | 12 | 0.39 |
| 19 | 96.45 | 10B19 | 16 | 51 | 76 | 25 | 1.04 | 10A19 | 16 | 0.43 |
| 20 | 101.48 | 10B20 | 16 | 51 | 76 | 25 | 1.13 | 10A20 | 16 | 0.48 |
| 21 | 106.51 | 10B21 | 16 | 51 | 76 | 25 | 1.18 | 10A21 | 16 | 0.51 |
| 22 | 111.55 | 10B22 | 16 | 51 | 76 | 25 | 1.27 | 10A22 | 16 | 0.59 |
| 23 | 116.59 | 10B23 | 16 | 51 | 76 | 25 | 1.45 | 10A23 | 16 | 0.65 |
| 24 | 121.62 | 10B24 | 16 | 51 | 76 | 32 | 1.50 | 10A24 | 15 | 0.68 |
| 25 | 126.66 | 10B25 | 16 | 51 | 76 | 32 | 1.59 | 10A25 | 15 | 0.73 |
| 26 | 131.70 | 10B26 | 16 | 51 | 76 | 32 | 1.63 | 10A26 | 15 | 0.78 |
| 27 | 136.74 | 10B27 | 19 | 51 | 76 | 32 | 1.68 | 10A27 | 18 | 0.89 |
| 28 | 141.79 | 10B28 | 19 | 51 | 76 | 32 | 1.72 | 10A28 | 18 | 0.93 |
| 29 | 146.83 | 10B29 | 19 | 51 | 76 | 32 | 1.91 | 10A29 | 18 | 1.07 |
| 30 | 151.87 | 10B30 | 19 | 57 | 82 | 32 | 2.04 | 10A30 | 18 | 1.15 |
| 31 | 156.92 | 10B31 | 19 | 57 | 82 | 32 | 2.13 | 10A31 | 18 | 1.27 |
| 32 | 161.96 | 10B32 | 19 | 57 | 82 | 32 | 2.27 | 10A32 | 18 | 1.23 |
| 33 | 167.01 | 10B33 | 19 | 57 | 82 | 32 | 2.33 | 10A33 | 18 | 1.42 |
| 34 | 172.05 | 10B34 | 19 | 57 | 82 | 32 | 2.36 | 10A34 | 18 | 1.45 |
| 35 | 177.10 | 10B35 | 19 | 57 | 82 | 32 | 2.48 | 10A35 | 18 | 1.51 |
| 36 | 182.15 | 10B36 | 19 | 57 | 82 | 32 | 2.56 | 10A36 | 18 | 1.73 |
| 37 | 187.19 | 10B37 | 19 | 57 | 82 | 32 | 2.68 | 10A37 | 18 | 1.81 |
| 38 | 192.24 | 10B38 | 19 | 57 | 82 | 32 | 2.72 | 10A38 | 18 | 1.88 |
| 39 | 197.29 | 10B39 | 19 | 57 | 82 | 32 | 2.86 | 10A39 | 18 | 2.00 |
| 40 | 202.33 | 10B40 | 19 | 57 | 82 | 32 | 2.95 | 10A40 | 18 | 2.02 |
| 41 | 207.38 | 10B41 | 19 | 57 | 82 | 32 | 3.01 | 10A41 | 18 | 2.20 |
| 42 | 212.43 | 10B42 | 19 | 57 | 82 | 32 | 3.16 | 10A42 | 18 | 2.26 |
| 43 | 217.48 | 10B43 | 19 | 57 | 82 | 32 | 3.20 | 10A43 | 18 | 2.38 |
| 44 | 222.53 | 10B44 | 19 | 57 | 82 | 32 | 3.44 | 10A44 | 18 | 2.46 |
| 45 | 227.58 | 10B45 | 19 | 64 | 95 | 32 | 3.73 | 10A45 | 18 | 2.69 |
| 46 | 232.63 | 10B46 | 19 | 64 | 95 | 32 | 3.85 | 10A46 | 18 | 2.91 |
| 47 | 237.68 | 10B47 | 19 | 64 | 95 | 32 | 3.89 | 10A47 | 18 | 2.95 |
| 48 | 242.73 | 10B48 | 25 | 64 | 95 | 32 | 4.18 | 10A48 | 24 | 2.98 |
| 49 | 247.78 | 10B49 | 25 | 64 | 95 | 32 | 4.21 | 10A49 | 24 | 3.20 |
| 50 | 252.82 | 10B50 | 25 | 64 | 95 | 32 | 4.40 | 10A50 | 24 | 3.22 |
| 51 | 257.87 | 10B51 | 25 | 64 | 95 | 32 | 4.48 | 10A51 | 24 | 3.32 |
| 52 | 262.92 | 10B52 | 25 | 64 | 95 | 32 | 4.64 | 10A52 | 24 | 3.62 |
| 53 | 267.97 | 10B53 | 25 | 64 | 95 | 32 | 4.75 | 10A53 | 24 | 3.67 |
| 54 | 273.03 | 10B54 | 25 | 64 | 95 | 32 | 4.86 | 10A54 | 24 | 3.76 |
| 55 | 278.08 | 10B55 | 25 | 64 | 95 | 32 | 4.96 | 10A55 | 24 | 3.88 |
| 56 | 283.13 | 10B56 | 25 | 64 | 95 | 32 | 5.22 | 10A56 | 24 | 4.04 |
| 57 | 288.18 | 10B57 | 25 | 64 | 95 | 32 | 5.27 | 10A57 | 24 | 4.25 |
| 58 | 293.23 | 10B58 | 25 | 64 | 95 | 32 | 5.36 | 10A58 | 24 | 4.67 |
| 59 | 298.28 | 10B59 | 25 | 64 | 95 | 32 | 5.59 | 10A59 | 24 | 4.76 |
| 60 | 303.33 | 10B60 | 25 | 64 | 95 | 32 | 5.90 | 10A60 | 24 | 4.90 |
| 70 | 353.84 | 10B70 | 25 | 64 | 95 | 44 | 8.24 | 10A70 | 24 | 6.35 |
| 72 | 363.94 | 10B72 | 25 | 64 | 95 | 44 | 8.84 | 10A72 | 24 | 6.91 |
| 76 | 384.15 | 10B76 | 25 | 64 | 95 | 44 | 11.03 | 10A76 | 24 | 9.11 |
| 80 | 404.36 | 10B80 | 25 | 70 | 108 | 44 | 11.22 | 10A80 | 24 | 9.53 |
| 84 | 424.57 | 10B84 | 25 | 70 | 108 | 44 | 11.57 | 10A84 | 24 | 10.02 |
| 95 | 480.14 | 10B95 | 25 | 70 | 108 | 44 | 14.57 | 10A95 | 24 | 12.25 |
| 96 | 485.19 | 10B96 | 25 | 70 | 108 | 44 | 14.93 | 10A96 | 24 | 12.43 |
| 112 | 566.03 | 10B112 | 25 | 70 | 108 | 44 | 19.05 | 10A112 | 24 | 17.10 |
| 114 | 576.13 | 10B114 | 25 | 70 | 108 | 44 | 20.61 | 10A114 | 24 | 17.84 |

CHAIN DATA:

BS 228/11

ISO 10B-1

PITCH: 15.88mm (0.625 in.)

ROLLER DIAMETER: 10.16mm (0.400 in.)

ROLLER WIDTH: 9.65mm (0.380 in.)

TENSILE: 2270 kilos (4500 lbs.)

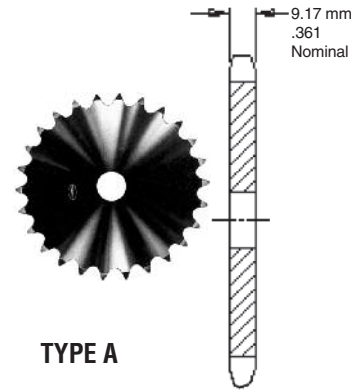

TYPE A

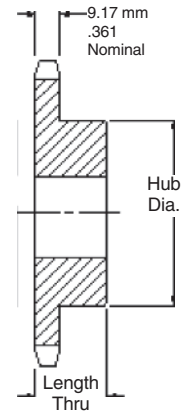

TYPE B

Maximum bores shown will accommodate standard keyseat and setscrew over keyseat. Slightly larger bores are possible with no keyseat, shallow keyseat, or setscrew at angle to keyseat.

0.625 INCH (15.88mm) PITCH SIMPLEX

ISO 10B-1
METRIC 50

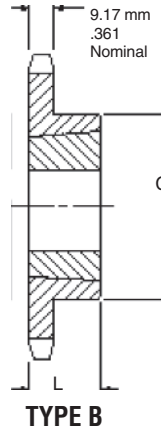

CHAIN DATA:
BS 228/11
ISO 10B-1
PITCH: 15.88mm (0.625 in.)
ROLLER DIAMETER: 10.16mm (0.400 in.)
ROLLER WIDTH: 9.65mm (0.380 in.)
TENSILE: 2270 kilos (5000 lbs.)

Simplex-Taper Bushed — Steel

| No. Teeth | Pitch Diameter | Catalog Number | Bushing Number | Bore Max. MM | Dimension | | Weight | |
|-----------|----------------|----------------|----------------|-----------------|-----------|---------|--------------|------------------|
| | MM | | | | L MM | C MM | Rim Kilos | Bushing Kilos |
| 12 | 61.34 | 10BTB12H | 1008 | 25.40 | 22.23 | 49.20* | 0.23 | 0.14 |
| 13 | 66.33 | 10BTB13H | 1008 | 25.40 | 22.23 | 46.02 | 0.23 | 0.14 |
| 14 | 71.34 | 10BTB14H | 1008 | 25.40 | 22.23 | 49.20 | 0.27 | 0.14 |
| 15 | 76.35 | 10BTB15H | 1210 | 31.75 | 25.40 | 62.69* | 0.32 | 0.27 |
| 16 | 81.37 | 10BTB16H | 1610 | 41.28 | 25.40 | 70.64* | 0.41 | 0.41 |
| 17 | 86.39 | 10BTB17H | 1610 | 41.28 | 25.40 | 70.64* | 0.41 | 0.41 |
| 18 | 91.42 | 10BTB18H | 1610 | 41.28 | 25.40 | 70.64 | 0.41 | 0.41 |
| 19 | 96.45 | 10BTB19H | 1610 | 41.28 | 25.40 | 76.20 | 0.64 | 0.41 |
| 20 | 101.48 | 10BTB20H | 1610 | 41.28 | 25.40 | 76.20 | 0.68 | 0.41 |
| 21 | 106.51 | 10BTB21H | 1610 | 41.28 | 25.40 | 76.20 | 0.73 | 0.41 |
| 22 | 111.55 | 10BTB22H | 1610 | 41.28 | 25.40 | 76.20 | 0.78 | 0.41 |
| 23 | 116.59 | 10BTB23H | 2012 | 50.80 | 31.75 | 90.47 | 0.82 | 0.77 |
| 24 | 121.62 | 10BTB24H | 2012 | 50.80 | 31.75 | 90.47 | 0.91 | 0.77 |
| 25 | 126.66 | 10BTB25H | 2012 | 50.80 | 31.75 | 90.47 | 1.09 | 0.77 |
| 26 | 131.70 | 10BTB26H | 2012 | 50.80 | 31.75 | 90.47 | 1.14 | 0.77 |
| 27 | 136.74 | 10BTB27H | 2012 | 50.80 | 31.75 | 90.47 | 1.18 | 0.77 |
| 28 | 141.79 | 10BTB28H | 2012 | 50.80 | 31.75 | 90.47 | 1.29 | 0.77 |
| 30 | 151.87 | 10BTB30H | 2012 | 50.80 | 31.75 | 90.47 | 1.41 | 0.77 |
| 32 | 161.96 | 10BTB32 | 2012 | 50.80 | 31.75 | 90.47 | 1.63 | 0.77 |
| 35 | 177.10 | 10BTB35 | 2012 | 50.80 | 31.75 | 90.47 | 1.91 | 0.77 |
| 36 | 182.15 | 10BTB36 | 2012 | 50.80 | 31.75 | 90.47 | 1.95 | 0.77 |
| 38 | 192.24 | 10BTB38 | 2012 | 50.80 | 31.75 | 90.47 | 2.22 | 0.77 |
| 40 | 202.33 | 10BTB40 | 2012 | 50.80 | 31.75 | 90.47 | 2.36 | 0.77 |
| 42 | 212.43 | 10BTB42 | 2012 | 50.80 | 31.75 | 90.47 | 2.68 | 0.77 |
| 45 | 227.58 | 10BTB45 | 2012 | 50.80 | 31.75 | 90.47 | 2.95 | 0.77 |
| 48 | 242.73 | 10BTB48 | 2012 | 50.80 | 31.75 | 90.47 | 3.31 | 0.77 |
| 54 | 273.03 | 10BTB54 | 2012 | 50.80 | 31.75 | 90.47 | 4.08 | 0.77 |
| 57 | 288.18 | 10BTB57 | 2012 | 50.80 | 31.75 | 90.47 | 4.59 | 0.77 |
| 60 | 303.33 | 10BTB60 | 2012 | 50.80 | 31.75 | 90.47 | 4.90 | 0.77 |
| 70 | 353.84 | 10BTB70 | 2517 | 63.50 | 44.45 | 107.95 | 6.35 | 1.59 |
| 72 | 363.94 | 10BTB72 | 2517 | 63.50 | 44.45 | 107.95 | 7.03 | 1.59 |
| 76 | 384.15 | 10BTB76 | 2517 | 63.50 | 44.45 | 107.95 | 8.31 | 1.59 |
| 80 | 404.36 | 10BTB80 | 2517 | 63.50 | 44.45 | 107.95 | 8.85 | 1.59 |
| 84 | 424.57 | 10BTB84 | 2517 | 63.50 | 44.45 | 107.95 | 10.21 | 1.59 |
| 95 | 480.14 | 10BTB95 | 2517 | 63.50 | 44.45 | 107.95 | 12.76 | 1.59 |
| 96 | 485.19 | 10BTB96 | 2517 | 63.50 | 44.45 | 107.95 | 13.15 | 1.59 |
| 114 | 576.13 | 10BTB114 | 2517 | 63.50 | 44.45 | 107.95 | 19.61 | 1.59 |

* Has recessed groove in hub for chain clearance.
Sprockets with "H" suffix have hardened teeth.

Metric Sprockets

Martin

ISO 10B-2
METRIC 50-2

0.625 INCH (15.88mm) PITCH DUPLEX

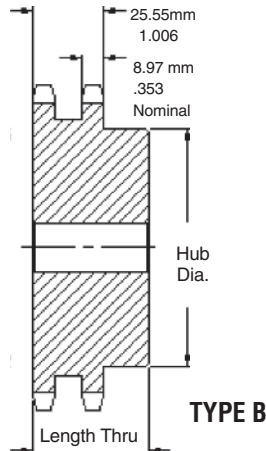

CHAIN DATA:

BS 228/11

ISO 10B-2

PITCH: 15.88mm (0.625 in.)

ROLLER DIAMETER: 10.16mm (0.400 in.)

ROLLER WIDTH: 9.65mm (0.380 in.)

TENSILE: 4540 kilos (10,000 lbs.)

SPROCKETS

Duplex-Type B — Steel

| No. Teeth | Pitch Diameter MM | Catalog Number | Bore | | Hub | | Weight (Approx.) Kilos |
|-----------|----------------------|----------------|-------|------|------|------|---------------------------|
| | | | Stock | Max. | Dia. | Thru | |
| | | | MM | MM | MM | MM | |
| 11 | 56.35 | D10B11 | 14 | 24 | 37 | 40 | 0.44 |
| 12 | 61.34 | D10B12 | 14 | 28 | 43 | 40 | 0.57 |
| 13 | 66.33 | D10B13 | 14 | 33 | 48 | 40 | 0.71 |
| 14 | 71.34 | D10B14 | 14 | 35 | 53 | 40 | 0.84 |
| 15 | 76.35 | D10B15 | 14 | 38 | 58 | 40 | 1.01 |
| 16 | 81.37 | D10B16 | 16 | 40 | 63 | 45 | 1.19 |
| 17 | 86.39 | D10B17 | 16 | 45 | 68 | 45 | 1.38 |
| 18 | 91.42 | D10B18 | 16 | 48 | 73 | 45 | 1.62 |
| 19 | 96.45 | D10B19 | 16 | 52 | 79 | 45 | 1.77 |
| 20 | 101.48 | D10B20 | 16 | 56 | 84 | 45 | 1.93 |
| 21 | 106.51 | D10B21 | 16 | 56 | 85 | 45 | 2.22 |
| 22 | 111.55 | D10B22 | 16 | 60 | 90 | 45 | 2.53 |
| 23 | 116.59 | D10B23 | 16 | 62 | 95 | 45 | 2.77 |
| 24 | 121.62 | D10B24 | 16 | 64 | 100 | 45 | 2.95 |
| 25 | 126.66 | D10B25 | 16 | 68 | 105 | 45 | 3.15 |
| 26 | 131.70 | D10B26 | 20 | 73 | 110 | 45 | 3.42 |
| 27 | 136.74 | D10B27 | 20 | 73 | 110 | 45 | 3.98 |
| 28 | 141.79 | D10B28 | 20 | 76 | 115 | 45 | 4.20 |
| 29 | 146.83 | D10B29 | 20 | 76 | 115 | 45 | 4.43 |
| 30 | 151.87 | D10B30 | 20 | 80 | 120 | 45 | 4.66 |
| 32 | 161.96 | D10B32 | 20 | 80 | 120 | 45 | 5.16 |
| 35 | 177.10 | D10B35 | 20 | 80 | 120 | 45 | 5.96 |
| 36 | 182.15 | D10B36 | 20 | 80 | 120 | 45 | 6.70 |
| 38 | 192.24 | D10B38 | 20 | 80 | 120 | 50 | 7.67 |
| 40 | 202.33 | D10B40 | 30 | 80 | 120 | 50 | 7.92 |
| 45 | 227.58 | D10B45 | 30 | 80 | 120 | 50 | 9.21 |
| 48 | 242.73 | D10B48 | 30 | 80 | 120 | 60 | 10.92 |
| 57 | 288.18 | D10B57 | 32 | 85 | 130 | 60 | 15.07 |
| 60 | 303.33 | D10B60 | 32 | 85 | 130 | 60 | 16.27 |
| 70 | 353.84 | D10B70 | 32 | 85 | 130 | 60 | 21.99 |
| 76 | 384.15 | D10B76 | 32 | 85 | 130 | 60 | 26.31 |
| 80 | 404.36 | D10B80 | 32 | 85 | 130 | 60 | 27.98 |
| 95 | 480.14 | D10B95 | 32 | 85 | 130 | 60 | 32.69 |
| 114 | 576.13 | D10B114 | 32 | 85 | 130 | 60 | 49.30 |

Maximum bores shown will accommodate standard keyseat and setscrew over keyseat. Slightly larger bores are possible with no keyseat, shallow keyseat, or setscrew at angle to keyseat.

0.625 INCH (15.88mm) PITCH **DUPLEX**

ISO **10B-2**
METRIC **50-2**

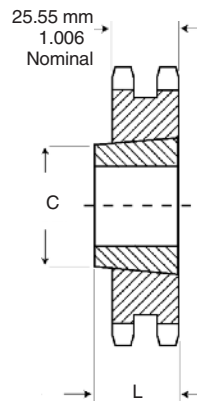

TYPE A

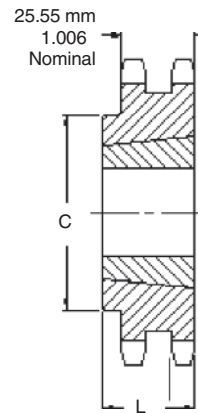

TYPE B

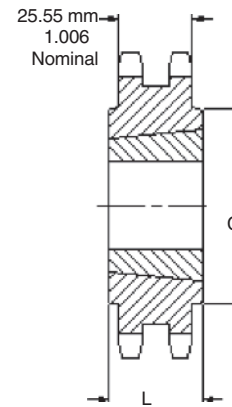

TYPE C

CHAIN DATA:

BS 228/11

ISO 10B-2

PITCH: 15.878mm (0.625 in.)

ROLLER DIAMETER: 10.16mm (0.400 in.)

ROLLER WIDTH: 9.65mm (0.380 in.)

TENSILE: 4540 kilos (10,000 lbs.)

Duplex-Taper Bushed — Steel

| No. Teeth | Pitch Diameter | Catalog Number | Bushing Number | Bore Max. | Dimension | | Weight | |
|-----------|----------------|----------------|----------------|-----------|-----------|--------|--------|---------|
| | MM | | | | L | C | Rim | Bushing |
| | | | | MM | MM | MM | Kilos | Kilos |
| 14 | 71.34 | D10ATB14 | 1008 | 25.40 | 22.23 | | 0.45 | 0.14 |
| 15 | 76.35 | D10ATB15 | 1210 | 31.75 | 25.40 | | 0.48 | 0.27 |
| 16 | 81.37 | D10ATB16 | 1210 | 31.75 | 25.40 | | 0.50 | 0.27 |
| 17 | 86.39 | D10ATB17 | 1610 | 41.28 | 25.40 | | 0.57 | 0.41 |
| 18 | 91.42 | D10ATB18 | 1610 | 41.28 | 25.40 | | 0.64 | 0.41 |
| 19 | 96.45 | D10ATB19 | 1610 | 41.28 | 25.40 | | 0.71 | 0.41 |
| 20 | 101.49 | D10BTB20 | 2012 | 50.80 | 25.40 | 84 | 0.82 | 0.77 |
| 21 | 106.52 | D10BTB21 | 2012 | 50.80 | 25.40 | 89 | 0.86 | 0.77 |
| 22 | 111.55 | D10BTB22 | 2012 | 50.80 | 31.75 | 99 | 1.45 | 0.77 |
| 23 | 116.59 | D10BTB23 | 2012 | 50.80 | 31.75 | 109 | 1.72 | 0.77 |
| 25 | 126.66 | D10BTB25 | 2012 | 50.80 | 31.75 | 134 | 3.40 | 0.77 |
| 30 | 151.87 | D10BTB30 | 2517 | 63.50 | 44.45 | 107.95 | 3.92 | 1.59 |
| 36 | 182.15 | D10CTB36 | 2517 | 63.50 | 44.45 | 107.95 | 4.54 | 1.59 |
| 38 | 192.24 | D10CTB38 | 2517 | 63.50 | 44.45 | 107.95 | 5.68 | 1.59 |
| 42 | 212.43 | D10CTB42 | 2517 | 63.50 | 44.45 | 107.95 | 7.95 | 1.59 |
| 48 | 242.73 | D10CTB48 | 2517 | 63.50 | 44.45 | 107.95 | 11.35 | 1.59 |
| 57 | 288.18 | D10CTB57 | 2517 | 63.50 | 44.45 | 107.95 | 19.69 | 1.59 |
| 60 | 303.33 | D10CTB60 | 2517 | 63.50 | 44.45 | 107.95 | 22.47 | 1.59 |
| 68 | 343.74 | D10CTB68 | 2517 | 63.50 | 44.45 | 107.95 | 25.47 | 1.59 |
| 76 | 384.15 | D10CTB76 | 2517 | 63.50 | 44.45 | 107.95 | 37.30 | 1.59 |
| 84 | 424.57 | D10CTB84 | 2517 | 63.50 | 44.45 | 107.95 | 44.72 | 1.59 |
| 95 | 480.14 | D10CTB95 | 2517 | 63.50 | 44.45 | 107.95 | 52.14 | 1.59 |
| 114 | 576.13 | D10CTB114 | 2517 | 63.50 | 44.45 | 107.95 | 62.57 | 1.59 |

Metric Sprockets

Martin

ISO **10B-3**
METRIC **50-3**

0.625 INCH (15.88mm) PITCH TRIPLEX

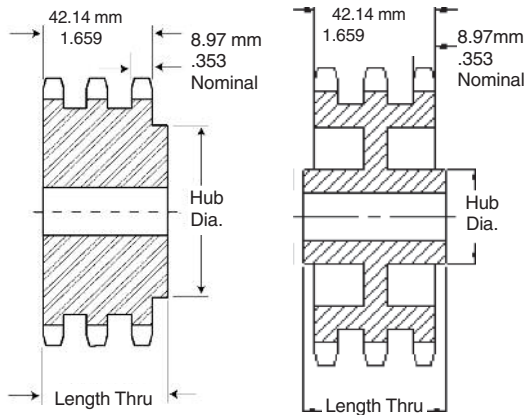

TYPE B

TYPE C

CHAIN DATA:

BS 228/11
ISO 10B-3
PITCH: 15.88mm (0.625 in.)
ROLLER DIAMETER: 10.16mm (0.400 in.)
ROLLER WIDTH: 9.65mm (0.380 in.)
TENSILE: 6810 kilos (10,000 lbs.)



Triplex-Type B/C — Steel

| No. Teeth | Pitch Diameter MM | Catalog Number | Bore | | Hub | | Weight (Approx.) Kilos |
|-----------|----------------------|----------------|-------------|------------|------------|------------|---------------------------|
| | | | Stock MM | Max. MM | Dia. MM | Thru MM | |
| 11 | 56.35 | E10B11 | 16 | 24 | 37 | 55 | 0.68 |
| 12 | 61.34 | E10B12 | 16 | 29 | 43 | 55 | 0.82 |
| 13 | 66.33 | E10B13 | 16 | 34 | 48 | 55 | 1.05 |
| 14 | 71.34 | E10B14 | 16 | 35 | 53 | 55 | 1.23 |
| 15 | 76.35 | E10B15 | 16 | 38 | 58 | 55 | 1.36 |
| 16 | 81.37 | E10B16 | 16 | 42 | 63 | 60 | 1.55 |
| 17 | 86.39 | E10B17 | 16 | 45 | 68 | 60 | 1.81 |
| 18 | 91.42 | E10B18 | 16 | 48 | 73 | 60 | 2.09 |
| 19 | 96.45 | E10B19 | 16 | 52 | 79 | 60 | 2.40 |
| 20 | 101.48 | E10B20 | 16 | 56 | 84 | 60 | 2.72 |
| 21 | 106.51 | E10B21 | 20 | 56 | 85 | 60 | 3.04 |
| 22 | 111.55 | E10B22 | 20 | 60 | 90 | 60 | 3.36 |
| 23 | 116.59 | E10B23 | 20 | 62 | 95 | 60 | 3.67 |
| 24 | 121.62 | E10B24 | 20 | 64 | 100 | 60 | 4.00 |
| 25 | 126.66 | E10B25 | 20 | 68 | 105 | 60 | 4.31 |
| 26 | 131.70 | E10B26 | 20 | 73 | 110 | 60 | 5.18 |
| 27 | 136.74 | E10B27 | 20 | 73 | 110 | 60 | 5.63 |
| 28 | 141.79 | E10B28 | 20 | 76 | 115 | 60 | 6.04 |
| 29 | 146.83 | E10B29 | 20 | 76 | 115 | 60 | 6.22 |
| 30 | 151.87 | E10B30 | 20 | 80 | 120 | 60 | 6.36 |
| 32 | 161.96 | E10B32 | 20 | 80 | 120 | 60 | 7.26 |
| 35 | 177.10 | E10B35 | 20 | 80 | 120 | 60 | 8.60 |
| 36 | 182.15 | E10B36 | 25 | 80 | 120 | 60 | 9.34 |
| 38 | 192.24 | E10B38 | 25 | 80 | 120 | 60 | 11.03 |
| 45 | 227.58 | E10B45 | 30 | 80 | 120 | 75 | 14.94 |
| 48 | 242.73 | E10B48 | 30 | 80 | 120 | 75 | 16.62 |
| 57 | 288.18 | E10B57 | 32 | 80 | 120 | 75 | 21.77 |
| 60 | 303.33 | E10B60 | 32 | 80 | 120 | 75 | 22.22 |
| 76 | 384.15 | E10C76 | 32 | 80 | 120 | 89 | 23.13 |
| 80 | 404.36 | E10C80 | 32 | 80 | 120 | 89 | 25.14 |
| 95 | 480.14 | E10C95 | 32 | 80 | 120 | 95 | 32.66 |
| 114 | 576.13 | E10C114 | 32 | 80 | 120 | 95 | 44.76 |

Maximum bores shown will accommodate standard keyseat and setscrew over keyseat. Slightly larger bores are possible with no keyseat, shallow keyseat, or setscrew at angle to keyseat.

0.750 INCH (19.05mm) PITCH **SIMPLEX**

ISO **12B-1**
METRIC **60**

CHAIN DATA:

BS 228/13

ISO 12B-1

PITCH: 19.05mm (0.750 in.)

ROLLER DIAMETER: 12.07mm (0.475 in.)

ROLLER WIDTH: 11.68mm (0.460 in.)

TENSILE: 2950 kilos (6500 lbs.)

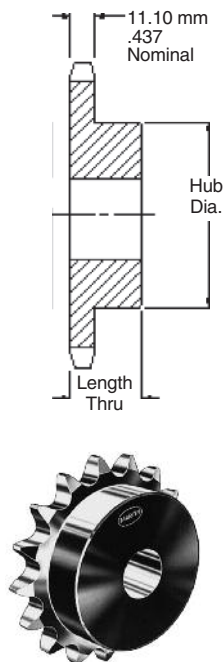
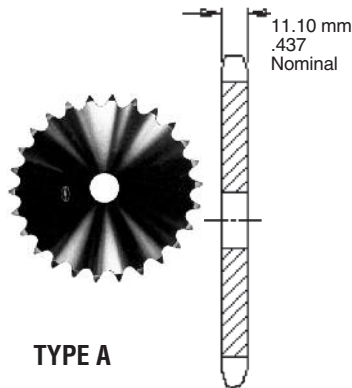

Simplex-Type B — Steel

| No. Teeth | Pitch Diameter MM | Catalog Number | Bore | | Hub | | Weight (Approx.) Kilos | Catalog Number | Bore Stock MM | Weight (Approx.) Kilos |
|-----------|----------------------|----------------|-------------|------------|------------|------------|------------------------------|----------------|---------------------|------------------------------|
| | | | Stock MM | Max. MM | Dia. MM | Thru MM | | | | |
| 11 | 67.62 | 12B11 | 12 | 32 | 47 | 35 | .53 | 12A11 | 14 | .36 |
| 12 | 73.60 | 12B12 | 12 | 35 | 53 | 35 | .67 | 12A12 | 14 | .42 |
| 13 | 79.60 | 12B13 | 12 | 38 | 59 | 35 | .75 | 12A13 | 14 | .48 |
| 14 | 85.61 | 12B14 | 12 | 42 | 64 | 35 | .91 | 12A14 | 14 | .54 |
| 15 | 91.63 | 12B15 | 12 | 45 | 70 | 35 | 1.14 | 12A15 | 14 | .60 |
| 16 | 97.65 | 12B16 | 16 | 50 | 75 | 35 | 1.27 | 12A16 | 14 | .68 |
| 17 | 103.67 | 12B17 | 16 | 52 | 80 | 35 | 1.46 | 12A17 | 14 | .77 |
| 18 | 109.71 | 12B18 | 16 | 52 | 80 | 35 | 1.69 | 12A18 | 14 | .85 |
| 19 | 115.74 | 12B19 | 16 | 60 | 90 | 35 | 1.78 | 12A19 | 14 | .95 |
| 20 | 121.78 | 12B20 | 16 | 64 | 90 | 35 | 2.10 | 12A20 | 14 | 1.08 |
| 21 | 127.82 | 12B21 | 20 | 64 | 100 | 40 | 2.27 | 12A21 | 16 | 1.15 |
| 22 | 133.86 | 12B22 | 20 | 64 | 100 | 40 | 2.38 | 12A22 | 16 | 1.24 |
| 23 | 139.90 | 12B23 | 20 | 67 | 100 | 40 | 2.49 | 12A23 | 16 | 1.33 |
| 24 | 145.95 | 12B24 | 20 | 67 | 100 | 40 | 2.62 | 12A24 | 19 | 1.47 |
| 25 | 151.99 | 12B25 | 20 | 67 | 100 | 40 | 2.78 | 12A25 | 19 | 1.63 |
| 26 | 158.04 | 12B26 | 20 | 67 | 100 | 40 | 2.89 | 12A26 | 19 | 1.72 |
| 27 | 164.09 | 12B27 | 20 | 67 | 100 | 40 | 3.05 | 12A27 | 19 | 1.91 |
| 28 | 170.14 | 12B28 | 20 | 67 | 100 | 40 | 3.12 | 12A28 | 19 | 1.99 |
| 29 | 176.19 | 12B29 | 20 | 67 | 100 | 40 | 3.30 | 12A29 | 19 | 2.44 |
| 30 | 182.25 | 12B30 | 20 | 67 | 100 | 40 | 3.44 | 12A30 | 19 | 2.28 |
| 31 | 188.30 | 12B31 | 20 | 67 | 100 | 40 | 3.50 | 12A31 | 19 | 2.49 |
| 32 | 194.35 | 12B32 | 20 | 67 | 100 | 40 | 3.75 | 12A32 | 19 | 2.62 |
| 33 | 200.41 | 12B33 | 20 | 67 | 100 | 40 | 3.82 | 12A33 | 19 | 2.77 |
| 34 | 206.46 | 12B34 | 20 | 67 | 100 | 40 | 3.99 | 12A34 | 19 | 2.91 |
| 35 | 212.52 | 12B35 | 20 | 67 | 100 | 40 | 4.10 | 12A35 | 19 | 3.19 |
| 36 | 218.57 | 12B36 | 20 | 67 | 100 | 40 | 4.35 | 12A36 | 19 | 3.21 |
| 37 | 224.63 | 12B37 | 20 | 67 | 100 | 40 | 4.64 | 12A37 | 19 | 3.52 |
| 38 | 230.69 | 12B38 | 25 | 70 | 107 | 40 | 4.92 | 12A38 | 24 | 3.67 |
| 39 | 236.74 | 12B39 | 25 | 70 | 107 | 40 | 5.15 | 12A39 | 24 | 3.87 |
| 40 | 242.80 | 12B40 | 25 | 70 | 107 | 40 | 5.22 | 12A40 | 24 | 4.00 |
| 41 | 248.86 | 12B41 | 25 | 70 | 107 | 40 | 5.51 | 12A41 | 24 | 4.24 |
| 42 | 254.92 | 12B42 | 25 | 70 | 107 | 40 | 5.78 | 12A42 | 24 | 4.53 |
| 43 | 260.98 | 12B43 | 25 | 70 | 107 | 40 | 5.90 | 12A43 | 24 | 4.58 |
| 44 | 267.03 | 12B44 | 25 | 70 | 107 | 40 | 6.30 | 12A44 | 25 | 4.99 |
| 45 | 273.09 | 12B45 | 25 | 70 | 107 | 40 | 6.34 | 12A45 | 25 | 5.14 |
| 46 | 279.15 | 12B46 | 25 | 70 | 107 | 40 | 6.62 | 12A46 | 25 | 5.33 |
| 47 | 285.21 | 12B47 | 25 | 70 | 107 | 40 | 6.80 | 12A47 | 25 | 5.70 |
| 48 | 291.27 | 12B48 | 25 | 70 | 107 | 40 | 7.18 | 12A48 | 25 | 5.75 |
| 50 | 303.39 | 12B50 | 25 | 70 | 107 | 40 | 8.01 | 12A50 | 25 | 6.45 |
| 54 | 327.63 | 12B54 | 32 | 70 | 110 | 45 | 9.80 | 12A54 | 32 | 7.33 |
| 57 | 345.81 | 12B57 | 32 | 70 | 110 | 45 | 10.10 | 12A57 | 32 | 8.11 |
| 60 | 363.99 | 12B60 | 32 | 70 | 110 | 45 | 11.44 | 12A60 | 32 | 9.19 |
| 65 | 394.30 | 12B65 | 32 | 70 | 110 | 45 | 13.12 | 12A65 | 32 | 10.65 |
| 70 | 424.61 | 12B70 | 32 | 70 | 110 | 45 | 14.51 | 12A70 | 32 | 12.45 |
| 72 | 436.73 | 12B72 | 32 | 80 | 120 | 50 | 15.50 | 12A72 | 32 | 13.22 |
| 76 | 460.98 | 12B76 | 32 | 80 | 120 | 50 | 17.26 | 12A76 | 32 | 14.78 |
| 80 | 485.23 | 12B80 | 32 | 80 | 120 | 50 | 19.00 | 12A80 | 32 | 20.75 |
| 84 | 509.48 | 12B84 | 32 | 80 | 120 | 50 | 21.07 | 12A84 | 32 | 21.78 |
| 95 | 576.17 | 12B95 | 32 | 92 | 140 | 55 | 23.83 | 12A95 | 32 | 23.46 |
| 96 | 582.23 | 12B96 | 32 | 92 | 140 | 55 | 26.61 | 12A96 | 32 | 23.71 |
| 114 | 691.36 | 12B114 | 32 | 92 | 140 | 55 | 33.98 | 12A114 | 32 | 28.16 |

Maximum bores shown will accommodate standard keyseat and setscrew over keyseat. Slightly larger bores are possible with no keyseat, shallow keyseat, or setscrew at angle to keyseat.

Metric Sprockets

Martin

ISO **12B-1**
METRIC **60**

0.750 INCH (19.05mm) PITCH SIMPLEX

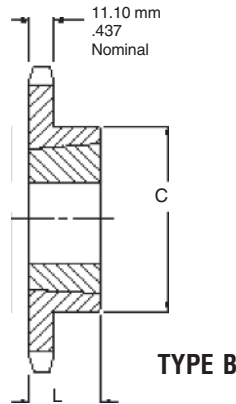

CHAIN DATA:

BS 228/13
ISO 12B-1
PITCH: 19.05mm (0.750 in.)
ROLLER DIAMETER: 12.07mm (0.475 in.)
ROLLER WIDTH: 11.68mm (0.460 in.)
TENSILE: 2950 kilos (6500 lbs.)

SPROCKETS

Simplex-Taper Bushed — Steel

| No. Teeth | Pitch Diameter | Catalog Number | Bushing Number | Bore Max. | Dimension | | Weight | |
|-----------|----------------|----------------|----------------|-----------|-----------|--------|--------|---------|
| | MM | | | | L | C | Rim | Bushing |
| | | | | MM | MM | MM | Kilos | Kilos |
| 11 | 67.62 | 12BTB11H | 1008 | 25.40 | 22.23 | 46.04 | 0.27 | 0.14 |
| 12 | 73.61 | 12BTB12H | 1008 | 25.40 | 22.23 | 49.21 | 0.36 | 0.14 |
| 13 | 79.60 | 12BTB13H | 1210 | 31.75 | 25.40 | 62.69 | 0.41 | 0.27 |
| 14 | 85.61 | 12BTB14H | 1210 | 31.75 | 25.40 | 62.69 | 0.45 | 0.27 |
| 15 | 91.63 | 12BTB15H | 1610 | 41.28 | 25.40 | 70.64 | 0.54 | 0.41 |
| 16 | 97.65 | 12BTB16H | 1610 | 41.28 | 25.40 | 76.20 | 0.73 | 0.41 |
| 17 | 103.67 | 12BTB17H | 1610 | 41.28 | 25.40 | 82.55 | 0.82 | 0.41 |
| 18 | 109.70 | 12BTB18H | 1610 | 41.28 | 25.40 | 82.55 | 0.91 | 0.41 |
| 19 | 115.74 | 12BTB19H | 1610 | 41.28 | 25.40 | 82.55 | 1.00 | 0.41 |
| 20 | 121.78 | 12BTB20H | 2012 | 50.80 | 31.75 | 90.47 | 1.00 | 0.77 |
| 21 | 127.82 | 12BTB21H | 2012 | 50.80 | 31.75 | 90.47 | 1.18 | 0.77 |
| 22 | 133.86 | 12BTB22H | 2012 | 50.80 | 31.75 | 90.47 | 1.27 | 0.77 |
| 23 | 139.90 | 12BTB23H | 2012 | 50.80 | 31.75 | 90.47 | 1.27 | 0.77 |
| 24 | 145.95 | 12BTB24H | 2012 | 50.80 | 31.75 | 90.47 | 1.50 | 0.77 |
| 25 | 151.99 | 12BTB25H | 2012 | 50.80 | 31.75 | 90.47 | 1.74 | 0.77 |
| 26 | 158.04 | 12BTB26H | 2012 | 50.80 | 31.75 | 90.47 | 1.74 | 0.77 |
| 27 | 164.09 | 12BTB27H | 2012 | 50.80 | 31.75 | 90.47 | 1.80 | 0.77 |
| 28 | 170.14 | 12BTB28H | 2012 | 50.80 | 31.75 | 90.47 | 2.04 | 0.77 |
| 30 | 182.25 | 12BTB30H | 2012 | 50.80 | 31.75 | 90.47 | 2.32 | 0.77 |
| 32 | 194.35 | 12BTB32 | 2012 | 50.80 | 31.75 | 90.47 | 2.48 | 0.77 |
| 35 | 212.52 | 12BTB35 | 2012 | 50.80 | 31.75 | 90.47 | 2.71 | 0.77 |
| 36 | 218.57 | 12BTB36 | 2012 | 50.80 | 31.75 | 90.47 | 2.78 | 0.77 |
| 38 | 230.69 | 12BTB38 | 2012 | 50.80 | 31.75 | 90.47 | 3.36 | 0.77 |
| 40 | 242.80 | 12BTB40 | 2012 | 50.80 | 31.75 | 90.47 | 3.53 | 0.77 |
| 42 | 254.92 | 12BTB42 | 2012 | 50.80 | 31.75 | 90.47 | 3.71 | 0.77 |
| 45 | 273.09 | 12BTB45 | 2012 | 50.80 | 31.75 | 90.47 | 3.98 | 0.77 |
| 48 | 291.27 | 12BTB48 | 2012 | 50.80 | 31.75 | 90.47 | 4.24 | 0.77 |
| 54 | 327.63 | 12BTB54 | 2517 | 63.50 | 44.45 | 107.95 | 8.30 | 1.59 |
| 57 | 345.81 | 12BTB57 | 2517 | 63.50 | 44.45 | 107.95 | 8.76 | 1.59 |
| 60 | 363.99 | 12BTB60 | 2517 | 63.50 | 44.45 | 107.95 | 9.22 | 1.59 |
| 68 | 412.49 | 12BTB68 | 2517 | 63.50 | 44.45 | 107.95 | 10.45 | 1.59 |
| 70 | 424.61 | 12BTB70 | 2517 | 63.50 | 44.45 | 107.95 | 10.76 | 1.59 |
| 72 | 436.73 | 12BTB72 | 2517 | 63.50 | 44.45 | 107.95 | 11.06 | 1.59 |
| 76 | 460.98 | 12BTB76 | 2517 | 63.50 | 44.45 | 107.95 | 11.68 | 1.59 |
| 84 | 509.48 | 12BTB84 | 2517 | 63.50 | 44.45 | 107.95 | 12.91 | 1.59 |
| 95 | 576.17 | 12BTB95 | 2517 | 63.50 | 44.45 | 107.95 | 14.60 | 1.59 |
| 96 | 582.23 | 12BTB96 | 2517 | 63.50 | 44.45 | 107.95 | 14.75 | 1.59 |
| 114 | 691.36 | 12BTB114 | 2517 | 63.50 | 44.45 | 107.95 | 17.52 | 1.59 |

Sprockets with "H" suffix have hardened teeth.

0.750 INCH (19.05mm) PITCH DUPLEX

ISO **12B-2**
METRIC **60-2**

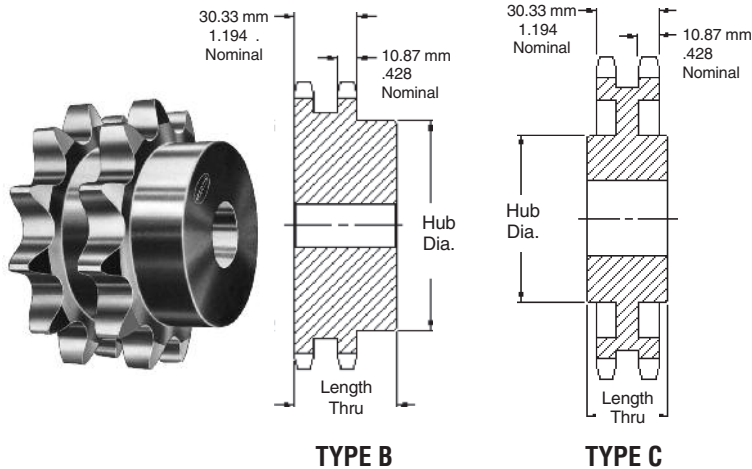

CHAIN DATA:

BS 228/13
ISO 12B-2
PITCH: 19.05mm (0.750 in.)
ROLLER DIAMETER: 12.07mm (0.475 in.)
ROLLER WIDTH: 11.68mm (0.460 in.)
TENSILE: 5900 kilos (13,000 lbs.)

Duplex-Type B/C — Steel

| No. Teeth | Pitch Diameter MM | Catalog Number | Bore | | Hub | | Weight (Approx.) Kilos |
|-----------|----------------------|----------------|-------------|------------|------------|------------|---------------------------|
| | | | Stock MM | Max. MM | Dia. MM | Thru MM | |
| 11 | 67.62 | D12B11 | 16 | 32 | 47 | 50 | 1.00 |
| 12 | 73.60 | D12B12 | 16 | 36 | 53 | 50 | 1.23 |
| 13 | 79.60 | D12B13 | 16 | 38 | 59 | 50 | 1.41 |
| 14 | 85.61 | D12B14 | 16 | 42 | 65 | 50 | 1.68 |
| 15 | 91.63 | D12B15 | 16 | 45 | 71 | 50 | 1.95 |
| 16 | 97.65 | D12B16 | 20 | 51 | 77 | 50 | 2.27 |
| 17 | 103.67 | D12B17 | 20 | 54 | 83 | 50 | 2.63 |
| 18 | 109.70 | D12B18 | 20 | 60 | 89 | 50 | 3.18 |
| 19 | 115.74 | D12B19 | 20 | 62 | 95 | 50 | 3.50 |
| 20 | 121.78 | D12B20 | 20 | 64 | 100 | 50 | 3.72 |
| 21 | 127.82 | D12B21 | 20 | 64 | 100 | 50 | 4.31 |
| 22 | 133.86 | D12B22 | 20 | 64 | 100 | 50 | 4.77 |
| 23 | 139.90 | D12B23 | 20 | 73 | 110 | 50 | 4.99 |
| 24 | 145.95 | D12B24 | 20 | 73 | 110 | 50 | 5.45 |
| 25 | 151.99 | D12B25 | 20 | 80 | 120 | 50 | 5.67 |
| 26 | 158.04 | D12B26 | 20 | 80 | 120 | 50 | 6.13 |
| 27 | 164.09 | D12B27 | 20 | 80 | 120 | 50 | 6.49 |
| 28 | 170.14 | D12B28 | 20 | 80 | 120 | 50 | 6.81 |
| 29 | 176.19 | D12B29 | 20 | 80 | 120 | 50 | 7.13 |
| 30 | 182.25 | D12B30 | 20 | 80 | 120 | 50 | 7.49 |
| 32 | 194.35 | D12B32 | 20 | 85 | 130 | 50 | 9.31 |
| 35 | 212.52 | D12B35 | 20 | 85 | 130 | 50 | 10.18 |
| 36 | 218.57 | D12B36 | 25 | 85 | 130 | 50 | 12.31 |
| 38 | 230.69 | D12B38 | 25 | 85 | 130 | 50 | 12.99 |
| 40 | 242.80 | D12B40 | 25 | 85 | 130 | 50 | 13.67 |
| 45 | 273.09 | D12B45 | 25 | 85 | 130 | 50 | 15.38 |
| 48 | 291.27 | D12B48 | 25 | 85 | 130 | 50 | 16.41 |
| 57 | 345.81 | D12B57 | 32 | 85 | 130 | 65 | 25.34 |
| 60 | 363.99 | D12B60 | 32 | 85 | 130 | 65 | 26.67 |
| 68 | 412.49 | D12C68 | 32 | 85 | 130 | 75 | 30.48 |
| 76 | 460.98 | D12C76 | 40 | 85 | 130 | 75 | 25.63 |
| 80 | 485.23 | D12C80 | 40 | 85 | 130 | 75 | 26.98 |
| 95 | 576.17 | D12C95 | 40 | 93 | 140 | 85 | 39.24 |
| 96 | 582.23 | D12C96 | 40 | 93 | 140 | 85 | 39.65 |
| 114 | 691.36 | D12C114 | 40 | 93 | 140 | 85 | 41.86 |

Maximum bores shown will accommodate standard keyseat and setscrew over keyseat. Slightly larger bores are possible with no keyseat, shallow keyseat, or setscrew at angle to keyseat.

Metric Sprockets

Martin

ISO **12B-2**
METRIC **60-2**

0.750 INCH (19.05mm) PITCH DUPLEX

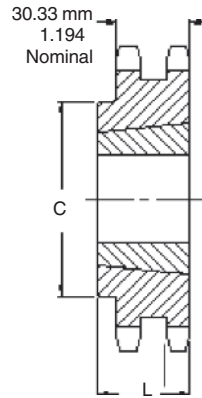
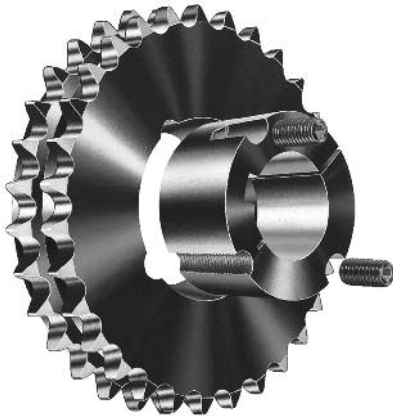

TYPE B

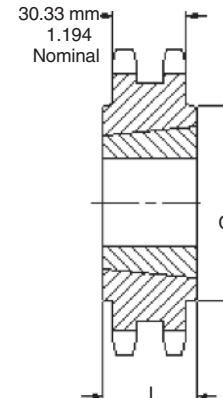

TYPE C

CHAIN DATA:

BS 228/13

ISO 12B-2

PITCH: 19.05mm (0.750 in.)

ROLLER DIAMETER: 12.07mm (0.475 in.)

ROLLER WIDTH: 11.68mm (0.460 in.)

TENSILE: 5900 kilos (13000 lbs.)

Duplex-Taper Bushed — Steel

| No. Teeth | Pitch Diameter | Catalog Number | Bushing Number | Bore Max. MM | Dimension | | Weight | |
|-----------|----------------|----------------|----------------|--------------|-----------|--------|-----------|---------------|
| | MM | | | | L MM | C MM | Rim Kilos | Bushing Kilos |
| 12 | 73.60 | D12BTB12 | 1215 | 31.75 | 38.10 | 53.54 | .61 | 0.73 |
| 13 | 79.60 | D12BTB13 | 1215 | 31.75 | 38.10 | 59.74 | .66 | 0.77 |
| 14 | 85.61 | D12BTB14 | 1215 | 31.75 | 38.10 | 65.91 | .84 | 0.82 |
| 15 | 91.63 | D12BTB15 | 1615 | 41.28 | 38.10 | 72.09 | .70 | 0.77 |
| 16 | 97.65 | D12BTB16 | 1615 | 41.28 | 38.10 | 76.20 | 1.11 | 0.77 |
| 17 | 103.67 | D12BTB17 | 1615 | 41.28 | 38.10 | 82.93 | 1.25 | 0.77 |
| 18 | 109.70 | D12BTB18 | 2012 | 50.80 | 31.75 | 90.50 | 1.56 | 0.77 |
| 19 | 115.74 | D12BTB19 | 2012 | 50.80 | 31.75 | 96.6 | 1.81 | 0.77 |
| 20 | 121.78 | D12BTB20 | 2517 | 63.50 | 44.45 | 102.00 | 2.04 | 1.59 |
| 21 | 127.82 | D12BTB21 | 2517 | 63.50 | 44.45 | 107.95 | 2.50 | 1.59 |
| 22 | 133.86 | D12BTB22 | 2517 | 63.50 | 44.45 | 107.95 | 2.78 | 1.59 |
| 23 | 139.90 | D12BTB23 | 2517 | 63.50 | 44.45 | 107.95 | 3.07 | 1.59 |
| 24 | 145.95 | D12BTB24 | 2517 | 63.50 | 44.45 | 107.95 | 3.35 | 1.59 |
| 25 | 151.99 | D12BTB25 | 2517 | 63.50 | 44.45 | 107.95 | 3.63 | 1.59 |
| 26 | 158.04 | D12BTB26 | 2517 | 63.50 | 44.45 | 107.95 | 3.91 | 1.59 |
| 27 | 164.09 | D12BTB27 | 2517 | 63.50 | 44.45 | 107.95 | 4.20 | 1.59 |
| 28 | 170.14 | D12BTB28 | 2517 | 63.50 | 44.45 | 107.95 | 4.48 | 1.59 |
| 30 | 182.25 | D12BTB30 | 2517 | 63.50 | 44.45 | 107.95 | 5.04 | 1.59 |
| 32 | 194.35 | D12BTB32 | 2517 | 63.50 | 44.45 | 107.95 | 5.61 | 1.59 |
| 35 | 212.52 | D12BTB35 | 2517 | 63.50 | 44.45 | 107.95 | 6.46 | 1.59 |
| 38 | 230.69 | D12CTB38 | 2517 | 63.50 | 44.45 | 107.95 | 8.40 | 1.59 |
| 40 | 242.80 | D12CTB40 | 2517 | 63.50 | 44.45 | 107.95 | 9.56 | 1.59 |
| 42 | 254.92 | D12CTB42 | 2517 | 63.50 | 44.45 | 107.95 | 10.73 | 1.59 |
| 45 | 273.09 | D12CTB45 | 2517 | 63.50 | 44.45 | 107.95 | 12.48 | 1.59 |
| 48 | 291.27 | D12CTB48 | 2517 | 63.50 | 44.45 | 107.95 | 14.23 | 1.59 |
| 54 | 327.63 | D12CTB54 | 2517 | 63.50 | 44.45 | 107.95 | 17.73 | 1.59 |
| 57 | 345.81 | D12CTB57 | 2517 | 63.50 | 44.45 | 107.95 | 19.48 | 1.59 |
| 60 | 363.99 | D12CTB60 | 2517 | 63.50 | 44.45 | 107.95 | 21.23 | 1.59 |
| 65 | 394.30 | D12CTB65 | 2517 | 63.50 | 44.45 | 107.95 | 24.15 | 1.59 |
| 70 | 424.61 | D12CTB70 | 2517 | 63.50 | 44.45 | 107.95 | 27.06 | 1.59 |
| 75 | 454.92 | D12CTB75 | 3020 | 76.20 | 50.80 | 133.35 | 19.27 | 2.95 |
| 76 | 460.98 | D12CTB76 | 3020 | 76.20 | 50.80 | 133.35 | 19.52 | 2.95 |
| 84 | 509.48 | D12CTB84 | 3020 | 76.20 | 50.80 | 133.35 | 21.58 | 2.95 |
| 95 | 576.17 | D12CTB95 | 3020 | 76.20 | 50.80 | 133.35 | 24.40 | 2.95 |
| 96 | 582.23 | D12CTB96 | 3020 | 76.20 | 50.80 | 133.35 | 24.66 | 2.95 |
| 114 | 691.36 | D12CTB114 | 3020 | 76.20 | 50.80 | 133.35 | 29.28 | 2.95 |

0.750 INCH (19.05mm) PITCH TRIPLEX

ISO **12B-3**
METRIC **60-3**

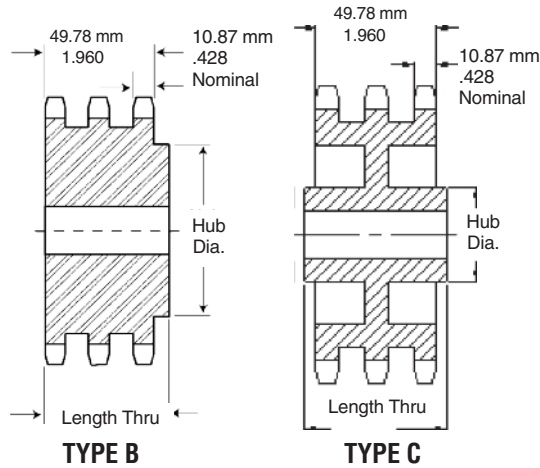

CHAIN DATA:

BS 228/13

ISO 12B-3

PITCH: 19.05mm (0.750 in.)

ROLLER DIAMETER: 12.07mm (0.475 in.)

ROLLER WIDTH: 11.68mm (0.460 in.)

TENSILE: 8850 kilos (19,500 lbs.)

Triplex-Type B/C — Steel

| No. Teeth | Pitch Diameter MM | Catalog Number | Bore | | Hub | | Weight (Approx.) Kilos |
|--------------|-------------------------|-------------------|-------------|------------|------------|------------|------------------------------|
| | | | Stock MM | Max. MM | Dia. MM | Thru MM | |
| 11 | 67.62 | E12B11 | 20 | 32 | 47 | 70 | 1.13 |
| 12 | 73.60 | E12B12 | 20 | 36 | 53 | 70 | 1.50 |
| 13 | 79.60 | E12B13 | 20 | 38 | 59 | 70 | 1.77 |
| 14 | 85.61 | E12B14 | 20 | 42 | 65 | 70 | 2.04 |
| 15 | 91.63 | E12B15 | 20 | 45 | 71 | 70 | 2.45 |
| 16 | 97.65 | E12B16 | 20 | 51 | 77 | 70 | 2.95 |
| 17 | 103.67 | E12B17 | 20 | 54 | 83 | 70 | 3.49 |
| 18 | 109.70 | E12B18 | 20 | 60 | 89 | 70 | 3.86 |
| 19 | 115.74 | E12B19 | 20 | 62 | 95 | 70 | 4.54 |
| 20 | 121.78 | E12B20 | 20 | 64 | 100 | 70 | 5.08 |
| 21 | 127.82 | E12B21 | 20 | 64 | 100 | 70 | 5.67 |
| 22 | 133.86 | E12B22 | 20 | 64 | 100 | 70 | 5.99 |
| 23 | 139.90 | E12B23 | 20 | 73 | 110 | 70 | 6.62 |
| 24 | 145.95 | E12B24 | 20 | 73 | 110 | 70 | 7.17 |
| 25 | 151.99 | E12B25 | 20 | 80 | 120 | 70 | 7.71 |
| 26 | 158.04 | E12B26 | 20 | 80 | 120 | 70 | 8.44 |
| 27 | 164.09 | E12B27 | 20 | 80 | 120 | 70 | 8.99 |
| 28 | 170.14 | E12B28 | 20 | 80 | 120 | 70 | 9.49 |
| 29 | 176.19 | E12B29 | 20 | 80 | 120 | 70 | 9.99 |
| 30 | 182.25 | E12B30 | 20 | 80 | 120 | 70 | 10.53 |
| 35 | 212.52 | E12B35 | 25 | 85 | 130 | 70 | 18.95 |
| 36 | 218.57 | E12B36 | 25 | 85 | 130 | 70 | 19.49 |
| 38 | 230.69 | E12B38 | 25 | 85 | 130 | 70 | 20.57 |
| 45 | 273.10 | E12B45 | 25 | 85 | 130 | 70 | 24.36 |
| 48 | 291.27 | E12B48 | 25 | 85 | 130 | 70 | 25.98 |
| 57 | 345.81 | E12C57 | 32 | 82 | 130 | 85 | 33.73 |
| 60 | 363.99 | E12C60 | 32 | 82 | 130 | 85 | 35.51 |
| 68 | 412.49 | E12C68 | 32 | 82 | 130 | 85 | 40.24 |
| 76 | 460.98 | E12C76 | 40 | 95 | 140 | 85 | 37.19 |
| 80 | 485.23 | E12C80 | 40 | 95 | 140 | 85 | 39.15 |
| 95 | 576.17 | E12C95 | 40 | 95 | 140 | 100 | 47.63 |

Maximum bores shown will accommodate standard keyseat and setscrew over keyseat. Slightly larger bores are possible with no keyseat, shallow keyseat, or setscrew at angle to keyseat.

Metric Sprockets

Martin

ISO **16B-1**
METRIC **80**

1.00 INCH (25.40mm) PITCH **SIMPLEX**

CHAIN DATA:

BS 228/15

ISO 16B-1

PITCH: 25.40mm (1.00 in.)

ROLLER DIAMETER: 15.88mm (0.625 in.)

ROLLER WIDTH: 17.02mm (0.670 in.)

TENSILE: 4310 kilos (9,500 lbs.)

Simplex-Type B/C — Steel

Simplex-Type A — Steel

| No. Teeth | Pitch Diameter MM | Catalog Number | Bore | | Hub | | Weight (Approx.) Kilos | Catalog Number | Bore Stock MM | Weight (Approx.) Kilos |
|-----------|----------------------|----------------|-------------|------------|------------|------------|------------------------------|----------------|---------------------|------------------------------|
| | | | Stock MM | Max. MM | Dia. MM | Thru MM | | | | |
| 11 | 90.16 | 16B11 | 16 | 41 | 63 | 40 | 1.45 | 16A11 | 14 | 0.82 |
| 12 | 98.14 | 16B12 | 16 | 47 | 72 | 40 | 1.82 | 16A12 | 14 | 0.91 |
| 13 | 106.14 | 16B13 | 16 | 52 | 79 | 40 | 1.82 | 16A13 | 14 | 1.04 |
| 14 | 114.15 | 16B14 | 16 | 60 | 88 | 40 | 2.09 | 16A14 | 14 | 1.22 |
| 15 | 122.17 | 16B15 | 16 | 62 | 96 | 40 | 2.59 | 16A15 | 14 | 1.36 |
| 16 | 130.20 | 16B16 | 20 | 67 | 100 | 45 | 3.00 | 16A16 | 14 | 1.54 |
| 17 | 138.23 | 16B17 | 25 | 67 | 102 | 45 | 3.18 | 16A17 | 14 | 1.81 |
| 18 | 146.27 | 16B18 | 25 | 70 | 108 | 45 | 3.77 | 16A18 | 24 | 2.00 |
| 19 | 154.32 | 16B19 | 25 | 70 | 108 | 45 | 3.86 | 16A19 | 24 | 2.13 |
| 20 | 162.37 | 16B20 | 25 | 70 | 108 | 45 | 4.09 | 16A20 | 24 | 2.49 |
| 21 | 170.42 | 16B21 | 25 | 70 | 108 | 50 | 4.54 | 16A21 | 24 | 2.63 |
| 22 | 178.48 | 16B22 | 25 | 70 | 108 | 50 | 4.99 | 16A22 | 24 | 2.82 |
| 23 | 186.56 | 16B23 | 25 | 70 | 108 | 50 | 5.08 | 16A23 | 24 | 3.04 |
| 24 | 194.60 | 16B24 | 25 | 70 | 108 | 50 | 5.54 | 16A24 | 24 | 3.45 |
| 25 | 202.66 | 16B25 | 25 | 70 | 108 | 50 | 5.76 | 16A25 | 24 | 3.63 |
| 26 | 210.72 | 16B26 | 32 | 80 | 120 | 50 | 7.03 | 16A26 | 30 | 3.90 |
| 27 | 218.79 | 16B27 | 32 | 80 | 120 | 50 | 7.53 | 16A27 | 30 | 4.31 |
| 28 | 226.86 | 16B28 | 32 | 80 | 120 | 50 | 7.58 | 16A28 | 30 | 4.58 |
| 29 | 234.93 | 16B29 | 32 | 80 | 120 | 50 | 7.94 | 16A29 | 30 | 4.81 |
| 30 | 243.00 | 16B30 | 32 | 80 | 120 | 50 | 8.26 | 16A30 | 32 | 5.22 |
| 31 | 251.07 | 16B31 | 32 | 80 | 120 | 50 | 8.62 | 16A31 | 32 | 5.56 |
| 32 | 259.14 | 16B32 | 32 | 80 | 120 | 50 | 8.98 | 16A32 | 32 | 5.90 |
| 33 | 267.21 | 16B33 | 32 | 80 | 120 | 50 | 9.33 | 16A33 | 32 | 6.24 |
| 34 | 275.28 | 16B34 | 32 | 80 | 120 | 50 | 9.69 | 16A34 | 32 | 6.58 |
| 35 | 283.36 | 16B35 | 32 | 80 | 120 | 50 | 10.05 | 16A35 | 32 | 6.92 |
| 36 | 291.43 | 16B36 | 32 | 80 | 120 | 50 | 10.41 | 16A36 | 32 | 7.26 |
| 37 | 299.51 | 16B37 | 32 | 80 | 120 | 50 | 10.76 | 16A37 | 32 | 7.60 |
| 38 | 307.58 | 16B38 | 32 | 80 | 120 | 50 | 11.12 | 16A38 | 32 | 7.94 |
| 39 | 315.66 | 16B39 | 32 | 80 | 120 | 50 | 11.48 | 16A39 | 32 | 8.48 |
| 40 | 323.74 | 16B40 | 32 | 80 | 120 | 50 | 11.83 | 16A40 | 32 | 9.01 |
| 41 | 331.81 | 16B41 | 32 | 80 | 120 | 50 | 12.19 | 16A41 | 32 | 9.55 |
| 42 | 339.89 | 16B42 | 32 | 80 | 120 | 50 | 12.55 | 16A42 | 32 | 10.09 |
| 43 | 347.97 | 16B43 | 32 | 80 | 120 | 50 | 12.91 | 16A43 | 32 | 10.62 |
| 44 | 356.05 | 16B44 | 32 | 80 | 120 | 50 | 13.27 | 16A44 | 32 | 11.16 |
| 45 | 364.12 | 16B45 | 32 | 80 | 120 | 50 | 13.62 | 16A45 | 32 | 11.70 |
| 46 | 372.20 | 16B46 | 32 | 80 | 120 | 50 | 13.98 | 16A46 | 32 | 12.23 |
| 47 | 380.28 | 16B47 | 32 | 80 | 120 | 50 | 14.34 | 16A47 | 32 | 12.77 |
| 48 | 388.36 | 16B48 | 32 | 80 | 120 | 50 | 14.70 | 16A48 | 32 | 12.31 |
| 49 | 396.44 | 16B49 | 32 | 80 | 120 | 50 | 15.05 | 16A49 | 32 | 13.85 |
| 50 | 404.52 | 16B50 | 32 | 80 | 120 | 50 | 15.41 | 16A50 | 32 | 14.38 |
| 54 | 436.84 | 16B54 | 32 | 85 | 130 | 50 | 20.99 | 16A54 | 32 | 16.53 |
| 57 | 461.08 | 16B57 | 32 | 85 | 130 | 50 | 22.16 | 16A57 | 32 | 18.14 |
| 60 | 485.33 | 16B60 | 32 | 85 | 130 | 50 | 23.33 | 16A60 | 32 | 19.75 |
| 65 | 525.73 | 16B65 | 32 | 85 | 130 | 50 | 25.27 | 16A65 | 32 | 22.43 |
| 70 | 566.15 | 16C70 | 40 | 108 | 159 | 90 | 33.59 | 16A70 | 40 | 25.47 |
| 72 | 582.31 | 16C72 | 40 | 108 | 159 | 90 | 35.48 | 16A72 | 40 | 27.94 |
| 76 | 614.64 | 16C76 | 40 | 108 | 159 | 90 | 39.24 | 16A76 | 40 | 32.89 |
| 80 | 646.97 | 16C80 | 40 | 108 | 159 | 90 | 43.00 | 16A80 | 40 | 37.84 |
| 84 | 679.30 | 16C84 | 40 | 108 | 159 | 90 | 46.77 | 16A84 | 40 | 42.78 |
| 90 | 727.80 | 16C90 | 40 | 108 | 159 | 90 | 52.41 | 16A90 | 40 | 50.21 |
| 95 | 768.22 | 16C95 | 40 | 108 | 159 | 90 | 57.12 | 16A95 | 40 | 56.39 |
| 96 | 766.31 | 16C96 | 40 | 108 | 159 | 90 | 58.06 | 16A96 | 40 | 57.63 |
| 114 | 921.81 | 16C114 | 40 | 108 | 159 | 90 | 75.00 | 16A114 | 40 | 76.36 |

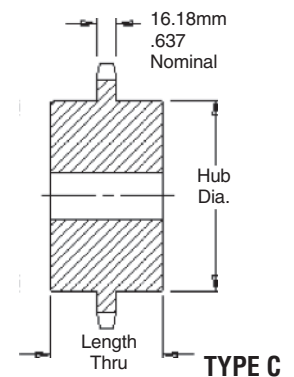
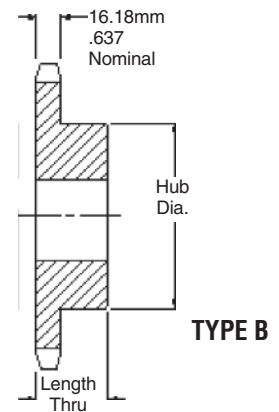
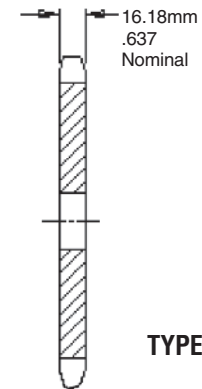

Maximum bores shown will accommodate standard keyseat and setscrew over keyseat. Slightly larger bores are possible with no keyseat, shallow keyseat, or setscrew at angle to keyseat.

1.00 INCH (25.40mm) PITCH SIMPLEX

ISO 16B-1
METRIC 80



TYPE B

CHAIN DATA:

BS 228/15

ISO 16B-1

PITCH: 25.40mm (1.00 in.)

ROLLER DIAMETER: 15.88mm (0.625 in.)

ROLLER WIDTH: 17.02mm (0.670 in.)

TENSILE: 4310 KILOS (9,500 lbs.)

Simplex-Taper Bushed — Steel

| No. Teeth | Pitch Diameter | Catalog Number | Bushing Number | Bore Max. | Dimension | | Weight | |
|-----------|----------------|----------------|----------------|-----------|-----------|--------|--------|---------|
| | MM | | | MM | L | C | Rim | Bushing |
| | | | | | MM | MM | Kilos | Kilos |
| 10 | 82.20 | 16BTB10H | 1215 | 31.75 | 38.10 | 62.69 | 0.73 | 0.36 |
| 11 | 90.16 | 16BTB11H | 1215 | 31.75 | 38.10 | 62.69 | 0.91 | 0.36 |
| 12 | 98.14 | 16BTB12H | 1615 | 41.28 | 38.10 | 76.20 | 1.04 | 0.54 |
| 13 | 106.14 | 16BTB13H | 1615 | 41.28 | 38.10 | 76.20 | 1.27 | 0.54 |
| 14 | 114.15 | 16BTB14H | 1615 | 41.28 | 38.10 | 82.55 | 1.36 | 0.54 |
| 15 | 122.17 | 16BTB15H | 1615 | 41.28 | 38.10 | 82.55 | 1.45 | 0.54 |
| 16 | 130.20 | 16BTB16H | 2012 | 50.80 | 31.75 | 90.47 | 1.55 | 0.77 |
| 17 | 138.23 | 16BTB17H | 2012 | 50.80 | 31.75 | 90.47 | 1.69 | 0.77 |
| 18 | 146.27 | 16BTB18H | 2012 | 50.80 | 31.75 | 90.47 | 1.46 | 0.77 |
| 19 | 154.32 | 16BTB19H | 2012 | 50.80 | 31.75 | 90.47 | 2.14 | 0.77 |
| 20 | 162.37 | 16BTB20H | 2517 | 63.50 | 44.45 | 107.95 | 2.72 | 1.59 |
| 21 | 170.42 | 16BTB21H | 2517 | 63.50 | 44.45 | 107.95 | 2.95 | 1.59 |
| 22 | 178.48 | 16BTB22H | 2517 | 63.50 | 44.45 | 107.95 | 3.18 | 1.59 |
| 23 | 186.54 | 16BTB23H | 2517 | 63.50 | 44.45 | 107.95 | 3.40 | 1.59 |
| 24 | 194.60 | 16BTB24H | 2517 | 63.50 | 44.45 | 107.95 | 3.63 | 1.59 |
| 25 | 202.66 | 16BTB25H | 2517 | 63.50 | 44.45 | 107.95 | 3.90 | 1.59 |
| 26 | 210.72 | 16BTB26H | 2517 | 63.50 | 44.45 | 107.95 | 4.22 | 1.59 |
| 27 | 218.79 | 16BTB27H | 2517 | 63.50 | 44.45 | 107.95 | 4.31 | 1.59 |
| 28 | 226.86 | 16BTB28H | 2517 | 63.50 | 44.45 | 107.95 | 4.54 | 1.59 |
| 30 | 243.00 | 16BTB30H | 2517 | 63.50 | 44.45 | 107.95 | 5.44 | 1.59 |
| 32 | 259.14 | 16BTB32 | 2517 | 63.50 | 44.45 | 107.95 | 5.67 | 1.59 |
| 35 | 283.36 | 16BTB35 | 2517 | 63.50 | 44.45 | 107.95 | 7.12 | 1.59 |
| 36 | 291.43 | 16BTB36 | 2517 | 63.50 | 44.45 | 107.95 | 7.94 | 1.59 |
| 38 | 307.58 | 16BTB38 | 2517 | 63.50 | 44.45 | 107.95 | 8.85 | 1.59 |
| 40 | 323.74 | 16BTB40 | 2517 | 63.50 | 44.45 | 107.95 | 9.75 | 1.59 |
| 45 | 364.12 | 16BTB45 | 2517 | 63.50 | 44.45 | 107.95 | 12.25 | 1.59 |
| 48 | 388.36 | 16BTB48 | 2517 | 63.50 | 44.45 | 107.95 | 13.61 | 1.59 |
| 54 | 436.84 | 16BTB54 | 2517 | 63.50 | 44.45 | 107.95 | 17.69 | 1.59 |
| 57 | 461.07 | 16BTB57 | 2517 | 63.50 | 44.45 | 107.95 | 19.16 | 1.59 |
| 60 | 485.33 | 16BTB60 | 2517 | 63.50 | 44.45 | 107.95 | 20.64 | 1.59 |
| 64 | 517.65 | 16BTB64 | 3020 | 76.20 | 50.80 | 133.35 | 19.35 | 2.95 |
| 70 | 566.15 | 16BTB70 | 3020 | 76.20 | 50.80 | 133.35 | 23.95 | 2.95 |
| 76 | 614.64 | 16BTB76 | 3020 | 76.20 | 50.80 | 133.35 | 28.55 | 2.95 |
| 80 | 646.97 | 16BTB80 | 3020 | 76.20 | 50.80 | 133.35 | 31.62 | 2.95 |
| 84 | 679.30 | 16BTB84 | 3020 | 76.20 | 50.80 | 133.35 | 34.68 | 2.95 |
| 95 | 768.22 | 16BTB95 | 3020 | 76.20 | 50.80 | 133.35 | 41.58 | 2.95 |
| 114 | 921.81 | 16BTB114 | 3020 | 76.20 | 50.80 | 133.35 | 56.15 | 2.95 |

Sprockets with "H" suffix have hardened teeth.

Metric Sprockets

Martin

1.00 INCH (25.40mm) PITCH DUPLEX

ISO 16B-2
METRIC 80-2

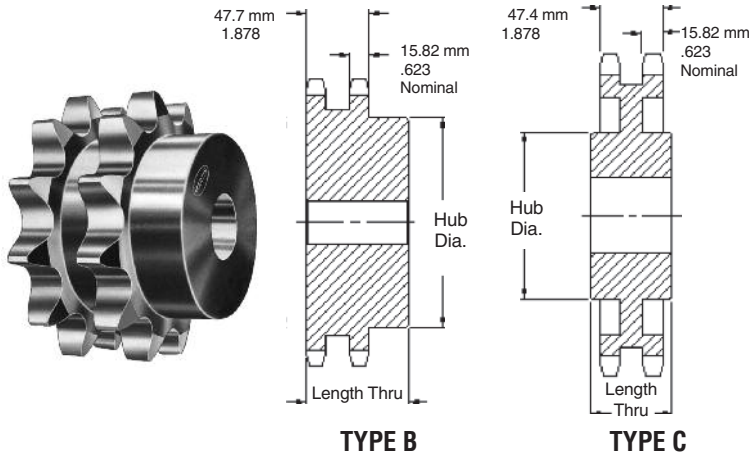

CHAIN DATA:

BS 228/15
ISO 16B-2
PITCH: 25.40mm (1.00 in.)
ROLLER DIAMETER: 15.88mm (0.625 in.)
ROLLER WIDTH: 17.02mm (0.670 in.)
TENSILE: 8620 kilos (19,000 lbs.)

SPROCKETS

Duplex-Type B/C — Steel

| No. Teeth | Pitch Diameter MM | Catalog Number | Bore | | Hub | | Weight (Approx.) Kilos |
|-----------|----------------------|----------------|-------|------|------|------|---------------------------|
| | | | Stock | Max. | Dia. | Thru | |
| | | | MM | MM | MM | MM | |
| 11 | 90.16 | D16B11 | 20 | 42 | 63 | 70 | 1.82 |
| 12 | 98.14 | D16B12 | 20 | 45 | 72 | 70 | 2.36 |
| 13 | 106.14 | D16B13 | 20 | 52 | 80 | 70 | 2.95 |
| 14 | 114.15 | D16B14 | 20 | 53 | 88 | 70 | 3.50 |
| 15 | 122.17 | D16B15 | 20 | 62 | 96 | 70 | 4.18 |
| 16 | 130.20 | D16B16 | 20 | 66 | 104 | 70 | 5.22 |
| 17 | 138.23 | D16B17 | 20 | 74 | 112 | 70 | 5.99 |
| 18 | 146.27 | D16B18 | 20 | 80 | 120 | 70 | 6.81 |
| 19 | 154.32 | D16B19 | 20 | 84 | 128 | 70 | 7.71 |
| 20 | 162.37 | D16B20 | 20 | 85 | 130 | 70 | 8.26 |
| 21 | 170.42 | D16B21 | 25 | 85 | 130 | 70 | 8.85 |
| 22 | 178.28 | D16B22 | 25 | 85 | 130 | 70 | 9.53 |
| 23 | 186.54 | D16B23 | 25 | 85 | 130 | 70 | 10.43 |
| 24 | 194.60 | D16B24 | 25 | 85 | 130 | 70 | 11.44 |
| 25 | 202.66 | D16B25 | 25 | 85 | 130 | 70 | 12.47 |
| 26 | 210.72 | D16B26 | 25 | 85 | 130 | 70 | 13.62 |
| 27 | 218.79 | D16B27 | 25 | 85 | 130 | 70 | 14.75 |
| 28 | 226.86 | D16B28 | 25 | 85 | 130 | 70 | 15.89 |
| 29 | 234.93 | D16B29 | 25 | 85 | 130 | 70 | 17.02 |
| 30 | 243.00 | D16B30 | 25 | 95 | 145 | 75 | 18.16 |
| 32 | 259.14 | D16B32 | 32 | 95 | 145 | 75 | 19.86 |
| 35 | 283.36 | D16B35 | 32 | 95 | 145 | 75 | 22.27 |
| 36 | 291.43 | D16B36 | 32 | 95 | 145 | 80 | 28.04 |
| 38 | 307.58 | D16B38 | 32 | 95 | 145 | 80 | 29.60 |
| 42 | 339.89 | D16B42 | 40 | 95 | 145 | 80 | 32.20 |
| 45 | 364.12 | D16C45 | 40 | 95 | 145 | 95 | 34.35 |
| 57 | 461.07 | D16C57 | 40 | 95 | 145 | 95 | 38.18 |
| 60 | 485.33 | D16C60 | 40 | 95 | 145 | 95 | 42.77 |
| 68 | 549.98 | D16C68 | 40 | 96 | 153 | 102 | 43.86 |
| 76 | 614.64 | D16C76 | 40 | 96 | 152 | 102 | 68.11 |
| 80 | 646.97 | D16C80 | 40 | 102 | 152 | 108 | 54.88 |
| 95 | 768.22 | D16C95 | 40 | 102 | 152 | 108 | 72.57 |
| 114 | 921.81 | D16C114 | 40 | 102 | 152 | 108 | 78.22 |

Maximum bores shown will accommodate standard keyseat and setscrew over keyseat. Slightly larger bores are possible with no keyseat, shallow keyseat, or setscrew at angle to keyseat.

1.00 INCH (25.40mm) PITCH DUPLEX

ISO 16B-2
METRIC 80-2

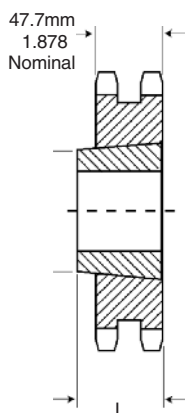

TYPE A

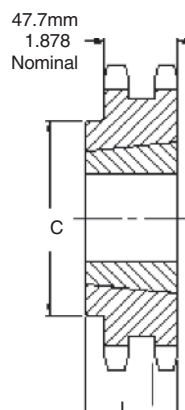

TYPE B

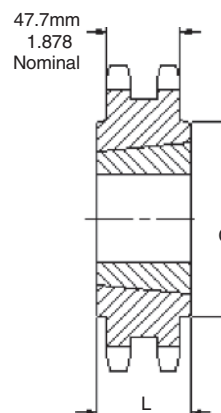

TYPE C

CHAIN DATA:

BS 228/15
ISO 16B-2
PITCH: 25.40mm (1.00 in.)
ROLLER DIAMETER: 15.88mm (0.625 in.)
ROLLER WIDTH: 17.02mm (0.670 in.)
TENSILE: 8620 kilos (19,000 lbs.)

Duplex-Taper Bushed — Steel

| No. Teeth | Pitch Diameter | Catalog Number | Bushing Number | Bore Max. | Dimension | | Weight | |
|-----------|----------------|----------------|----------------|-----------|-----------|--------|--------|---------|
| | MM | | | | L | C | Rim | Bushing |
| | | | | MM | MM | MM | Kilos | Kilos |
| 13 | 106.14 | D16ATB13 | 1615 | 41.28 | 38.10 | | 1.54 | 0.77 |
| 14 | 114.15 | D16ATB14 | 2012 | 50.80 | 31.75 | | 1.68 | 0.77 |
| 15 | 122.17 | D16ATB15 | 2012 | 50.80 | 31.75 | | 2.04 | 0.77 |
| 16 | 130.20 | D16ATB16 | 2012 | 50.80 | 31.75 | | 2.27 | 0.77 |
| 17 | 138.23 | D16ATB17 | 2517 | 63.50 | 44.45 | | 2.50 | 1.59 |
| 18 | 146.27 | D16ATB18 | 2517 | 63.50 | 44.45 | | 2.64 | 1.59 |
| 19 | 154.32 | D16BTB19 | 3020 | 76.20 | 50.80 | 127.00 | 3.18 | 2.95 |
| 20 | 162.37 | D16BTB20 | 3020 | 76.20 | 50.80 | 133.35 | 3.45 | 2.95 |
| 21 | 170.42 | D16BTB21 | 3020 | 76.20 | 50.80 | 141.28 | 4.09 | 2.95 |
| 22 | 178.48 | D16BTB22 | 3020 | 76.20 | 50.80 | 149.23 | 4.73 | 2.95 |
| 23 | 186.54 | D16BTB23 | 3020 | 76.20 | 50.80 | 158.34 | 5.48 | 2.95 |
| 24 | 194.60 | D16BTB24 | 3020 | 76.20 | 50.80 | 166.68 | 6.34 | 2.95 |
| 25 | 202.66 | D16BTB25 | 3020 | 76.20 | 50.80 | 174.63 | 7.72 | 2.95 |
| 26 | 210.72 | D16BTB26 | 3020 | 76.20 | 50.80 | 182.56 | 8.36 | 2.95 |
| 27 | 218.79 | D16BTB27 | 3020 | 76.20 | 50.80 | 133.35 | 10.22 | 2.95 |
| 28 | 226.86 | D16BTB28 | 3020 | 76.20 | 50.80 | 133.35 | 10.59 | 2.95 |
| 30 | 243.00 | D16CTB30 | 3020 | 76.20 | 50.80 | 133.35 | 11.35 | 2.95 |
| 35 | 283.36 | D16CTB35 | 3020 | 76.20 | 50.80 | 133.35 | 17.88 | 2.95 |
| 38 | 307.58 | D16CTB38 | 3020 | 76.20 | 50.80 | 133.35 | 21.79 | 2.95 |
| 42 | 339.89 | D16CTB42 | 3020 | 76.20 | 50.80 | 133.35 | 22.94 | 2.95 |
| 45 | 364.12 | D16CTB45 | 3020 | 76.20 | 50.80 | 133.35 | 23.80 | 2.95 |
| 57 | 461.08 | D16CTB57 | 3020 | 76.20 | 50.80 | 133.35 | 27.24 | 2.95 |
| 76 | 614.64 | D16CTB76 | 3020 | 76.20 | 50.80 | 133.35 | 37.68 | 2.95 |
| 95 | 768.22 | D16CTB95 | 3020 | 76.20 | 50.80 | 133.35 | 43.13 | 2.95 |
| 114 | 921.81 | D16CTB114 | 3020 | 76.20 | 50.80 | 133.35 | 48.58 | 2.95 |

Maximum bores shown will accommodate standard keyseat and setscrew over keyseat. Slightly larger bores are possible with no keyseat, shallow keyseat, or setscrew at angle to keyseat.

Metric Sprockets

Martin

ISO **16B-3**
METRIC **80-3**

1.00 INCH (25.40mm) PITCH TRIPLEX

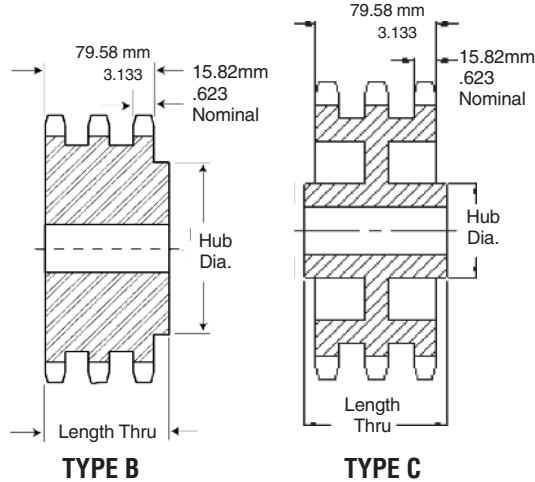

CHAIN DATA:

BS 228/15

ISO 16B-3

PITCH: 25.40mm (1.00 in.)

ROLLER DIAMETER: 15.88mm (0.625 in.)

ROLLER WIDTH: 17.02mm (0.670 in.)

TENSILE: 12,930 kilos (28,500 lbs.)

SPROCKETS

Triplex-Type B/C — Steel

| No. Teeth | Pitch Diameter MM | Catalog Number | Bore | | Hub | | Weight (Approx.) Kilos |
|-----------|----------------------|----------------|-------------|------------|------------|------------|---------------------------|
| | | | Stock MM | Max. MM | Dia. MM | Thru MM | |
| 11 | 90.16 | E16B11 | 25 | 42 | 63 | 100 | 2.72 |
| 12 | 98.14 | E16B12 | 25 | 45 | 72 | 100 | 3.59 |
| 13 | 106.14 | E16B13 | 25 | 52 | 80 | 100 | 4.13 |
| 14 | 114.15 | E16B14 | 25 | 58 | 88 | 100 | 4.68 |
| 15 | 122.17 | E16B15 | 25 | 62 | 96 | 100 | 5.54 |
| 16 | 130.20 | E16B16 | 30 | 66 | 104 | 100 | 6.81 |
| 17 | 138.23 | E16B17 | 30 | 74 | 112 | 100 | 8.07 |
| 18 | 146.27 | E16B18 | 30 | 80 | 120 | 100 | 9.99 |
| 19 | 154.32 | E16B19 | 30 | 84 | 128 | 100 | 10.89 |
| 20 | 162.37 | E16B20 | 30 | 85 | 130 | 100 | 11.80 |
| 21 | 170.42 | E16B21 | 30 | 85 | 130 | 100 | 13.61 |
| 22 | 178.48 | E16B22 | 30 | 85 | 130 | 100 | 14.07 |
| 23 | 186.54 | E16B23 | 30 | 85 | 130 | 100 | 14.97 |
| 24 | 194.60 | E16B24 | 30 | 85 | 130 | 100 | 16.34 |
| 25 | 202.66 | E16B25 | 30 | 85 | 130 | 100 | 17.70 |
| 26 | 210.72 | E16B26 | 30 | 85 | 130 | 100 | 19.98 |
| 27 | 218.79 | E16B27 | 30 | 85 | 130 | 100 | 21.57 |
| 28 | 226.86 | E16B28 | 30 | 85 | 130 | 100 | 23.15 |
| 29 | 234.93 | E16B29 | 30 | 85 | 130 | 100 | 24.74 |
| 30 | 243.00 | E16B30 | 32 | 95 | 140 | 105 | 26.33 |
| 35 | 283.36 | E16B35 | 32 | 95 | 140 | 105 | 36.06 |
| 36 | 291.43 | E16B36 | 32 | 95 | 140 | 105 | 38.06 |
| 38 | 307.58 | E16C38 | 32 | 97 | 152 | 114 | 41.45 |
| 42 | 339.89 | E16C42 | 40 | 97 | 152 | 114 | 38.51 |
| 45 | 364.12 | E16C45 | 40 | 97 | 152 | 114 | 41.91 |
| 57 | 461.08 | E16C57 | 40 | 107 | 159 | 120 | 51.35 |
| 60 | 485.33 | E16C60 | 40 | 107 | 159 | 120 | 58.06 |
| 68 | 549.98 | E16C68 | 40 | 107 | 159 | 120 | 63.50 |
| 76 | 614.64 | E16C76 | 40 | 107 | 159 | 120 | 77.11 |
| 95 | 768.22 | E16C95 | 40 | 114 | 171 | 127 | 100.70 |
| 114 | 921.81 | E16C114 | 40 | 114 | 171 | 127 | 120.84 |

Maximum bores shown will accommodate standard keyseat and setscrew over keyseat. Slightly larger bores are possible with no keyseat, shallow keyseat, or setscrew at angle to keyseat.

1.25 INCH (31.75mm) PITCH **SIMPLEX**

ISO **20B-1**
METRIC **100**

CHAIN DATA:

BS 228/17

ISO 20B-1

PITCH: 31.75mm (1.250 in.)

ROLLER DIAMETER: 19.05mm (0.750 in.)

ROLLER WIDTH: 19.56mm (0.770 in.)

TENSILE: 6580 kilos (14,500 lbs.)

Simplex-Type A — Steel

Simplex-Type B/C — Steel

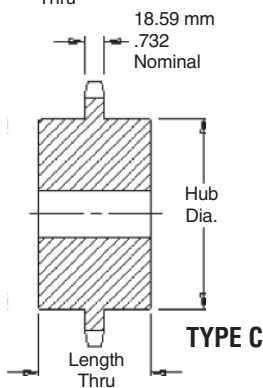
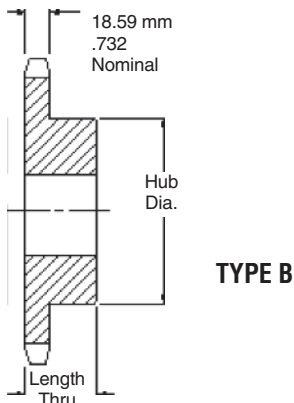
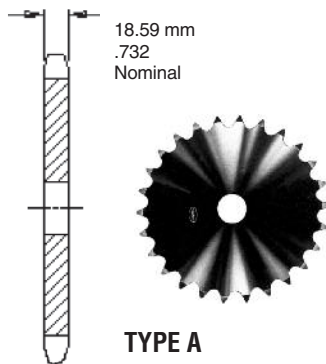

| No. Teeth | Pitch Diameter MM | Catalog Number | Bore | | Hub | | Weight (Approx.) Kilos | Catalog Number | Bore Stock MM | Weight (Approx.) Kilos |
|--------------|-------------------------|-------------------|-------------|------------|------------|------------|------------------------------|-------------------|---------------------|------------------------------|
| | | | Stock MM | Max. MM | Dia. MM | Thru MM | | | | |
| 8 | 82.97 | 20B8 | 25 | 57 | 48 | 48 | 1.04 | 20A8 | 25 | 0.63 |
| 9 | 92.83 | 20B9 | 25 | 57 | 58 | 48 | 1.45 | 20A9 | 25 | 0.95 |
| 10 | 102.75 | 20B10 | 25 | 60 | 69 | 48 | 1.86 | 20A10 | 25 | 1.27 |
| 11 | 112.70 | 20B11 | 25 | 70 | 79 | 48 | 2.40 | 20A11 | 25 | 1.59 |
| 12 | 122.67 | 20B12 | 25 | 76 | 90 | 48 | 2.95 | 20A12 | 25 | 1.91 |
| 13 | 132.67 | 20B13 | 25 | 76 | 98 | 41 | 3.00 | 20A13 | 25 | 2.18 |
| 14 | 142.68 | 20B14 | 25 | 76 | 106 | 41 | 3.40 | 20A14 | 25 | 2.49 |
| 15 | 152.71 | 20B15 | 25 | 76 | 114 | 44 | 4.31 | 20A15 | 25 | 2.68 |
| 16 | 162.75 | 20B16 | 25 | 76 | 114 | 44 | 4.63 | 20A16 | 24 | 3.08 |
| 17 | 172.79 | 20B17 | 32 | 76 | 114 | 44 | 4.99 | 20A17 | 24 | 3.54 |
| 18 | 182.84 | 20B18 | 32 | 76 | 114 | 44 | 5.44 | 20A18 | 30 | 3.81 |
| 19 | 192.90 | 20B19 | 32 | 76 | 114 | 51 | 5.90 | 20A19 | 30 | 4.31 |
| 20 | 202.96 | 20B20 | 32 | 76 | 114 | 51 | 6.35 | 20A20 | 30 | 4.58 |
| 21 | 213.03 | 20B21 | 32 | 76 | 114 | 51 | 7.03 | 20A21 | 32 | 5.17 |
| 22 | 223.10 | 20B22 | 32 | 76 | 114 | 51 | 7.71 | 20A22 | 32 | 5.72 |
| 23 | 233.17 | 20B23 | 32 | 84 | 114 | 51 | 8.16 | 20A23 | 32 | 5.99 |
| 24 | 243.25 | 20B24 | 32 | 84 | 114 | 51 | 8.62 | 20A24 | 32 | 6.62 |
| 25 | 253.32 | 20B25 | 32 | 84 | 114 | 51 | 9.07 | 20A25 | 32 | 6.94 |
| 26 | 263.41 | 20B26 | 32 | 84 | 127 | 51 | 9.53 | 20A26 | 32 | 7.62 |
| 27 | 273.49 | 20B27 | 32 | 84 | 127 | 51 | 10.43 | 20A27 | 32 | 8.35 |
| 28 | 283.57 | 20B28 | 32 | 84 | 127 | 51 | 11.34 | 20A28 | 32 | 8.85 |
| 29 | 293.66 | 20B29 | 32 | 84 | 127 | 51 | 11.76 | 20A29 | 32 | 9.43 |
| 30 | 303.75 | 20B30 | 32 | 84 | 127 | 51 | 12.02 | 20A30 | 32 | 9.98 |
| 31 | 313.83 | 20B31 | 32 | 84 | 127 | 51 | 12.77 | 20A31 | 32 | 10.73 |
| 32 | 323.92 | 20B32 | 32 | 84 | 127 | 51 | 13.52 | 20A32 | 32 | 11.49 |
| 33 | 334.01 | 20B33 | 32 | 84 | 127 | 51 | 14.59 | 20A33 | 32 | 12.24 |
| 34 | 344.10 | 20B34 | 32 | 84 | 127 | 51 | 15.66 | 20A34 | 32 | 13.00 |
| 35 | 354.20 | 20B35 | 32 | 84 | 127 | 64 | 16.74 | 20A35 | 32 | 13.75 |
| 36 | 364.29 | 20B36 | 32 | 84 | 127 | 64 | 17.51 | 20A36 | 32 | 14.50 |
| 37 | 374.38 | 20B37 | 32 | 84 | 127 | 64 | 18.17 | 20A37 | 32 | 15.25 |
| 38 | 384.48 | 20B38 | 32 | 84 | 127 | 64 | 18.82 | 20A38 | 32 | 16.01 |
| 39 | 394.57 | 20B39 | 32 | 84 | 127 | 64 | 19.78 | 20A39 | 32 | 16.76 |
| 40 | 404.67 | 20B40 | 32 | 84 | 127 | 64 | 21.27 | 20A40 | 32 | 17.52 |
| 41 | 414.77 | 20B41 | 32 | 84 | 127 | 64 | 22.07 | 20A41 | 32 | 18.27 |
| 42 | 424.88 | 20B42 | 32 | 84 | 127 | 64 | 22.86 | 20A42 | 32 | 19.03 |
| 43 | 434.96 | 20B43 | 32 | 84 | 127 | 64 | 23.40 | 20A43 | 32 | 19.78 |
| 44 | 445.06 | 20B44 | 32 | 84 | 127 | 64 | 23.95 | 20A44 | 32 | 20.53 |
| 45 | 455.15 | 20B45 | 32 | 84 | 127 | 64 | 24.49 | 20A45 | 32 | 21.29 |
| 46 | 465.25 | 20B46 | 32 | 84 | 127 | 64 | 26.31 | 20A46 | 32 | 22.04 |
| 47 | 475.35 | 20B47 | 32 | 84 | 127 | 64 | 28.12 | 20A47 | 32 | 22.79 |
| 48 | 485.45 | 20B48 | 40 | 102 | 152 | 64 | 29.94 | 20A48 | 32 | 23.55 |
| 49 | 495.55 | 20B49 | 40 | 102 | 152 | 64 | 31.76 | 20A49 | 32 | 24.30 |
| 50 | 505.65 | 20B50 | 40 | 102 | 152 | 64 | 33.57 | 20A50 | 32 | 25.06 |
| 51 | 515.75 | 20B51 | 40 | 102 | 152 | 64 | 35.39 | 20A51 | 40 | 24.43 |
| 52 | 525.85 | 20B52 | 40 | 102 | 152 | 64 | 37.21 | 20A52 | 40 | 25.85 |
| 53 | 535.95 | 20B53 | 40 | 102 | 152 | 64 | 39.02 | 20A53 | 40 | 27.27 |
| 54 | 546.05 | 20C54 | 40 | 102 | 152 | 82 | 32.90 | 20A54 | 40 | 25.70 |
| 55 | 556.15 | 20C55 | 40 | 102 | 152 | 82 | 34.77 | 20A55 | 40 | 30.12 |
| 56 | 566.25 | 20C56 | 40 | 102 | 152 | 82 | 36.63 | 20A56 | 40 | 31.34 |
| 57 | 576.35 | 20C57 | 40 | 102 | 152 | 82 | 38.50 | 20A57 | 40 | 32.96 |
| 58 | 586.45 | 20C58 | 40 | 102 | 152 | 82 | 40.37 | 20A58 | 40 | 35.80 |
| 59 | 596.56 | 20C59 | 40 | 102 | 152 | 82 | 42.24 | 20A59 | 40 | 37.22 |
| 60 | 606.66 | 20C60 | 40 | 102 | 152 | 82 | 44.10 | 20A60 | 40 | 38.64 |
| 70 | 707.68 | 20C70 | 40 | 133 | 178 | 95 | 65.36 | 20A70 | 40 | 52.85 |
| 72 | 727.89 | 20C72 | 40 | 133 | 178 | 95 | 67.23 | 20A72 | 40 | 55.70 |
| 76 | 768.30 | 20C76 | 40 | 133 | 178 | 95 | 70.98 | 20A76 | 40 | 61.38 |
| 80 | 808.71 | 20C80 | 40 | 133 | 178 | 95 | 74.70 | 20A80 | 40 | 67.06 |
| 84 | 849.13 | 20C84 | 40 | 133 | 178 | 95 | 78.43 | 20A84 | 40 | 72.75 |
| 90 | 909.76 | 20C90 | 40 | 133 | 178 | 95 | 84.03 | 20A90 | 40 | 81.27 |
| 95 | 960.28 | 20C95 | 40 | 133 | 178 | 114 | 117.18 | 20A95 | 40 | 102.42 |
| 96 | 970.38 | 20C96 | 40 | 133 | 178 | 114 | 117.56 | 20A96 | 40 | 103.84 |
| 114 | 1152.27 | 20C114 | 40 | 133 | 178 | 114 | 124.40 | 20A114 | 40 | 130.84 |

Maximum bores shown will accommodate standard keyseat and setscrew over keyseat. Slightly larger bores are possible with no keyseat, shallow keyseat, or setscrew at angle to keyseat.

Metric Sprockets

Martin

ISO 20B-1
METRIC 100

1.25 INCH (31.75mm) PITCH SIMPLEX

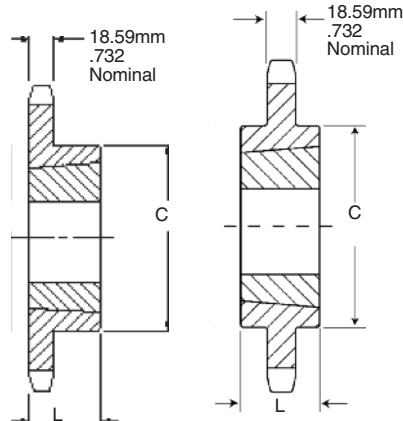

TYPE B

TYPE C

CHAIN DATA:

BS 228/17
ISO 20B1
PITCH: 31.75mm (1.250 in.)
ROLLER DIAMETER: 19.05mm (0.750 in.)
ROLLER WIDTH: 19.56mm (0.770 in.)
TENSILE: 6580 kilos (14,500 lbs.)

SPROCKETS

Simplex-Taper Bushed — Steel

| No. Teeth | Pitch Diameter | Catalog Number | Bushing Number | Bore Max. | Dimension | | Weight | |
|-----------|----------------|----------------|----------------|-----------|-----------|--------|--------|---------|
| | MM | | | | L | C | Rim | Bushing |
| | | | | MM | MM | MM | Kilos | Kilos |
| 11 | 112.70 | 20BTB11H | 1615 | 41.28 | 38.10 | 62.69 | 1.22 | 0.54 |
| 12 | 122.67 | 20BTB12H | 1615 | 41.28 | 38.10 | 70.64 | 1.41 | 0.54 |
| 13 | 132.67 | 20BTB13H | 2012 | 50.80 | 31.75 | 90.47 | 1.45 | 0.77 |
| 14 | 142.68 | 20BTB14H | 2012 | 50.80 | 31.75 | 90.47 | 1.63 | 0.77 |
| 15 | 152.71 | 20BTB15H | 2517 | 63.50 | 44.45 | 107.95 | 2.31 | 1.59 |
| 16 | 162.75 | 20BTB16H | 2517 | 63.50 | 44.45 | 107.95 | 2.72 | 1.59 |
| 17 | 172.79 | 20BTB17H | 2517 | 63.50 | 44.45 | 107.95 | 3.27 | 1.59 |
| 18 | 182.84 | 20BTB18H | 2517 | 63.50 | 44.45 | 107.95 | 3.63 | 1.59 |
| 19 | 192.90 | 20BTB19H | 2517 | 63.50 | 44.45 | 107.95 | 4.09 | 1.59 |
| 20 | 202.96 | 20BTB20H | 2517 | 63.50 | 44.45 | 107.95 | 4.40 | 1.59 |
| 21 | 213.03 | 20BTB21H | 2517 | 63.50 | 44.45 | 107.95 | 4.54 | 1.59 |
| 22 | 223.10 | 20BTB22H | 2517 | 63.50 | 44.45 | 107.95 | 4.77 | 1.59 |
| 23 | 233.17 | 20BTB23H | 2517 | 63.50 | 44.45 | 107.95 | 5.58 | 1.59 |
| 24 | 243.25 | 20BTB24H | 2517 | 63.50 | 44.45 | 107.95 | 6.13 | 1.59 |
| 25 | 253.32 | 20BTB25H | 2517 | 63.50 | 44.45 | 107.95 | 6.95 | 1.59 |
| 26 | 263.41 | 20BTB26H | 2517 | 63.50 | 44.45 | 107.95 | 7.35 | 1.59 |
| 28 | 283.57 | 20BTB28H | 3020 | 76.20 | 50.80 | 133.35 | 7.90 | 2.95 |
| 30 | 303.75 | 20BTB30H | 3020 | 76.20 | 50.80 | 133.35 | 9.62 | 2.95 |
| 32 | 323.92 | 20BTB32 | 3020 | 76.20 | 50.80 | 133.35 | 11.03 | 2.95 |
| 35 | 354.20 | 20BTB35 | 3020 | 76.20 | 50.80 | 133.35 | 13.15 | 2.95 |
| 36 | 364.29 | 20BTB36 | 3020 | 76.20 | 50.80 | 133.35 | 13.86 | 2.95 |
| 38 | 384.48 | 20BTB38 | 3020 | 76.20 | 50.80 | 133.35 | 15.98 | 2.95 |
| 40 | 404.67 | 20BTB40 | 3020 | 76.20 | 50.80 | 133.35 | 19.43 | 2.95 |
| 45 | 455.15 | 20BTB45 | 3020 | 76.20 | 50.80 | 133.35 | 25.18 | 2.95 |
| 48 | 485.45 | 20BTB48 | 3020 | 76.20 | 50.80 | 133.35 | 28.62 | 2.95 |
| 54 | 546.05 | 20BTB54 | 3020 | 76.20 | 50.80 | 133.35 | 35.52 | 2.95 |
| 57 | 576.35 | 20BTB57 | 3020 | 76.20 | 50.80 | 133.35 | 37.82 | 2.95 |
| 60 | 606.66 | 20BTB60 | 3020 | 76.20 | 50.80 | 133.35 | 41.27 | 2.95 |
| 70 | 707.68 | 20CTB70 | 3535 | 88.90 | 88.90 | 171.45 | 51.56 | 6.35 |
| 72 | 727.89 | 20CTB72 | 3535 | 88.90 | 88.90 | 171.45 | 53.97 | 6.35 |
| 76 | 768.30 | 20CTB76 | 3535 | 88.90 | 88.90 | 171.45 | 60.33 | 6.35 |
| 80 | 808.71 | 20CTB80 | 3535 | 88.90 | 88.90 | 171.45 | 66.23 | 6.35 |
| 84 | 849.13 | 20CTB84 | 3535 | 88.90 | 88.90 | 171.45 | 73.48 | 6.35 |
| 90 | 909.76 | 20CTB90 | 3535 | 88.90 | 88.90 | 171.45 | 94.33 | 6.35 |
| 95 | 960.28 | 20CTB95 | 3535 | 88.90 | 88.90 | 171.45 | 96.16 | 6.35 |

Sprockets with "H" suffix have hardened teeth.

1.25 INCH (31.75mm) PITCH DUPLEX

ISO **20B-2**
METRIC **100-2**

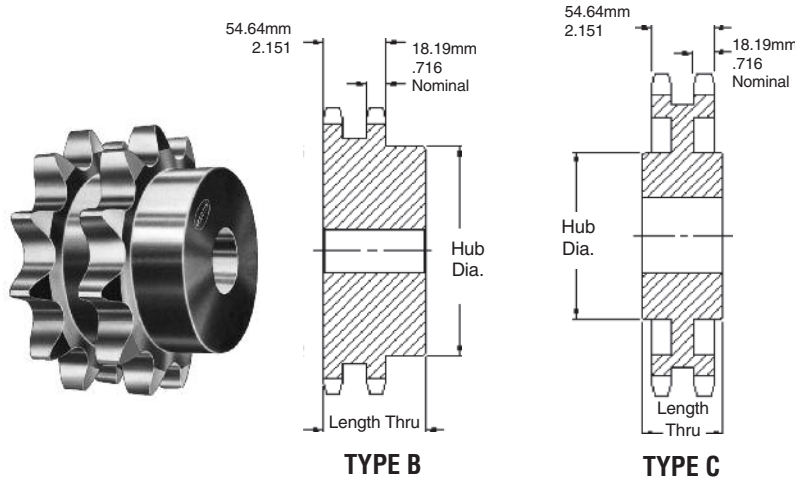

CHAIN DATA:

BS 228/17
ISO 20B-2
PITCH: 31.75mm (1.250 in.)
ROLLER DIAMETER: 19.05mm (0.750 in.)
ROLLER WIDTH: 19.56mm (0.770 in.)
TENSILE: 13,160 kilos (29,000 lbs.)

Duplex-Type B/C — Steel

| No. Teeth | Pitch Diameter MM | Catalog Number | Bore | | Hub | | Weight (Approx.) Kilos |
|-----------|----------------------|----------------|-------------|------------|------------|------------|---------------------------|
| | | | Stock MM | Max. MM | Dia. MM | Thru MM | |
| 10 | 102.75 | D20B10 | 20 | 45 | 69 | 75 | 2.90 |
| 11 | 112.70 | D20B11 | 20 | 52 | 79 | 80 | 3.67 |
| 12 | 122.67 | D20B12 | 20 | 60 | 90 | 80 | 4.31 |
| 13 | 132.67 | D20B13 | 20 | 64 | 100 | 80 | 5.53 |
| 14 | 142.68 | D20B14 | 20 | 73 | 110 | 80 | 6.62 |
| 15 | 152.71 | D20B15 | 20 | 80 | 120 | 80 | 7.76 |
| 16 | 162.75 | D20B16 | 25 | 80 | 120 | 80 | 9.12 |
| 17 | 172.79 | D20B17 | 25 | 80 | 120 | 80 | 10.44 |
| 18 | 182.84 | D20B18 | 25 | 80 | 120 | 80 | 11.71 |
| 19 | 192.90 | D20B19 | 25 | 80 | 120 | 80 | 12.92 |
| 20 | 202.96 | D20B20 | 25 | 80 | 120 | 80 | 15.43 |
| 21 | 213.03 | D20B21 | 25 | 92 | 140 | 80 | 16.55 |
| 22 | 223.10 | D20B22 | 25 | 92 | 140 | 80 | 17.70 |
| 23 | 233.17 | D20B23 | 25 | 92 | 140 | 80 | 19.05 |
| 24 | 243.25 | D20B24 | 32 | 96 | 145 | 80 | 20.43 |
| 25 | 253.32 | D20B25 | 32 | 96 | 145 | 80 | 21.77 |
| 26 | 263.41 | D20B26 | 32 | 96 | 145 | 80 | 23.15 |
| 27 | 273.49 | D20B27 | 32 | 96 | 145 | 80 | 24.97 |
| 28 | 283.57 | D20B28 | 32 | 96 | 145 | 80 | 26.78 |
| 30 | 303.75 | D20B30 | 32 | 96 | 145 | 80 | 30.41 |
| 32 | 323.92 | D20B32 | 32 | 96 | 145 | 80 | 32.22 |
| 35 | 354.20 | D20C35 | 32 | 100 | 152 | 108 | 34.02 |
| 36 | 364.29 | D20C36 | 32 | 100 | 152 | 108 | 34.70 |
| 38 | 384.48 | D20C38 | 32 | 100 | 152 | 114 | 43.72 |
| 42 | 424.86 | D20C42 | 40 | 100 | 152 | 114 | 43.55 |
| 45 | 455.15 | D20C45 | 40 | 100 | 152 | 114 | 46.72 |
| 57 | 576.35 | D20C57 | 40 | 100 | 191 | 127 | 64.10 |
| 60 | 606.66 | D20C60 | 40 | 125 | 191 | 127 | 79.38 |
| 68 | 687.48 | D20C68 | 40 | 125 | 191 | 127 | 87.74 |
| 76 | 768.30 | D20C76 | 40 | 125 | 191 | 127 | 96.11 |
| 80 | 808.71 | D20C80 | 40 | 125 | 191 | 127 | 100.30 |
| 95 | 960.28 | D20C95 | 40 | 125 | 191 | 127 | 115.98 |
| 114 | 1152.26 | D20C114 | 40 | 125 | 191 | 127 | 135.85 |

Maximum bores shown will accommodate standard keyseat and setscrew over keyseat. Slightly larger bores are possible with no keyseat, shallow keyseat, or setscrew at angle to keyseat.

Metric Sprockets

Martin

ISO **20B-3**
METRIC **100-3**

1.25 INCH (31.75mm) PITCH TRIPLEX

CHAIN DATA:

BS 228/17
ISO 20B-3
PITCH: 31.75mm (1.250 in.)
ROLLER DIAMETER: 19.05mm (0.750 in.)
ROLLER WIDTH: 19.56mm (0.770 in.)
TENSILE: 19,740 kilos (43,500 lbs.)

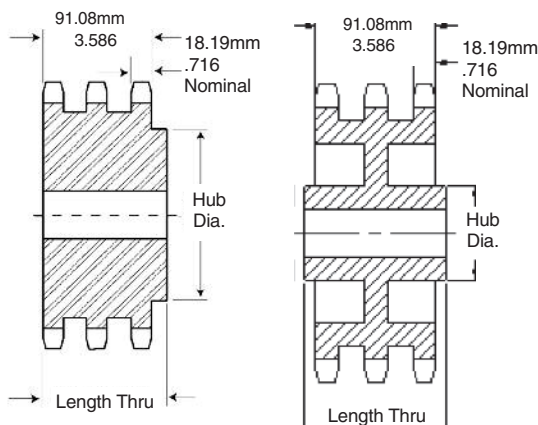

TYPE B

TYPE C

Triplex-Type B/C — Steel

| No. Teeth | Pitch Diameter | Catalog Number | Bore | | Hub | | Weight (Approx.) |
|-----------|----------------|----------------|-------|------|------|------|------------------|
| | MM | | Stock | Max. | Dia. | Thru | Kilos |
| | | | MM | MM | MM | MM | |
| 10 | 102.75 | E20B10 | 25 | 47 | 69 | 110 | 3.95 |
| 11 | 112.70 | E20B11 | 25 | 52 | 79 | 115 | 5.26 |
| 12 | 122.67 | E20B12 | 25 | 60 | 90 | 115 | 6.21 |
| 13 | 132.67 | E20B13 | 25 | 64 | 100 | 115 | 9.26 |
| 14 | 142.68 | E20B14 | 25 | 73 | 110 | 115 | 9.76 |
| 15 | 152.71 | E20B15 | 25 | 80 | 120 | 115 | 10.81 |
| 16 | 162.75 | E20B16 | 25 | 80 | 120 | 115 | 12.76 |
| 17 | 172.79 | E20B17 | 25 | 80 | 120 | 115 | 14.76 |
| 18 | 182.84 | E20B18 | 25 | 80 | 120 | 115 | 16.71 |
| 19 | 192.90 | E20B19 | 25 | 80 | 120 | 115 | 19.13 |
| 20 | 202.96 | E20B20 | 25 | 80 | 120 | 115 | 21.57 |
| 21 | 213.03 | E20B21 | 25 | 92 | 140 | 115 | 23.36 |
| 22 | 223.10 | E20B22 | 25 | 92 | 140 | 115 | 25.65 |
| 23 | 233.17 | E20B23 | 25 | 92 | 140 | 115 | 27.90 |
| 24 | 243.25 | E20B24 | 32 | 95 | 145 | 120 | 27.19 |
| 25 | 253.32 | E20B25 | 32 | 95 | 145 | 120 | 27.90 |
| 26 | 263.41 | E20B26 | 32 | 95 | 145 | 120 | 31.90 |
| 27 | 273.49 | E20B27 | 32 | 95 | 145 | 120 | 35.90 |
| 28 | 283.57 | E20B28 | 32 | 95 | 145 | 120 | 39.90 |
| 30 | 303.75 | E20B30 | 32 | 95 | 145 | 120 | 47.90 |
| 32 | 323.92 | E20B32 | 32 | 95 | 145 | 127 | 51.57 |
| 35 | 354.20 | E20C35 | 32 | 97 | 152 | 127 | 57.29 |
| 36 | 364.29 | E20C36 | 32 | 97 | 152 | 127 | 59.35 |
| 38 | 384.48 | E20C38 | 40 | 97 | 152 | 127 | 62.56 |
| 42 | 424.86 | E20C42 | 40 | 97 | 152 | 127 | 70.12 |
| 45 | 455.15 | E20C45 | 40 | 97 | 152 | 127 | 75.84 |
| 57 | 576.35 | E20C57 | 40 | 102 | 191 | 127 | 100.11 |
| 60 | 606.66 | E20C60 | 40 | 102 | 191 | 127 | 104.86 |
| 68 | 687.48 | E20C68 | 40 | 102 | 191 | 127 | 117.54 |
| 76 | 768.30 | E20C76 | 40 | 102 | 191 | 127 | 130.21 |
| 80 | 808.71 | E20C80 | 40 | 102 | 191 | 127 | 136.55 |
| 95 | 960.28 | E20C95 | 40 | 102 | 191 | 127 | 160.31 |
| 114 | 1152.27 | E20C114 | 40 | 102 | 191 | 127 | 190.41 |

Maximum bores shown will accommodate standard keyseat and setscrew over keyseat. Slightly larger bores are possible with no keyseat, shallow keyseat, or setscrew at angle to keyseat.

1.50 INCH (38.10mm) PITCH **SIMPLEX**

ISO **24B-1**
METRIC **120**

CHAIN DATA:

BS 228/18

ISO 24B-1

PITCH: 38.10mm (1.50 in.)

ROLLER DIAMETER: 25.40mm (1.00 in.)

ROLLER WIDTH: 25.40mm (1.00 in.)

TENSILE: 9980 kilos (22,000 lbs.)

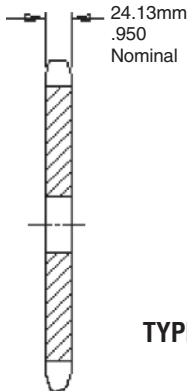

TYPE A

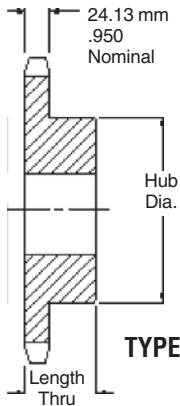

TYPE B

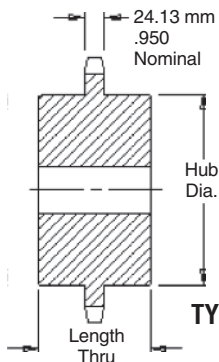

TYPE C

Simplex-Type B/C — Steel

| No. Teeth | Pitch Diameter MM | Catalog Number | Bore | | Hub | | Weight (Approx.) Kilos | Catalog Number | Bore Stock MM | Weight (Approx.) Kilos |
|-----------|----------------------|----------------|-------------|------------|------------|------------|------------------------------|----------------|---------------------|------------------------------|
| | | | Stock MM | Max. MM | Dia. MM | Thru MM | | | | |
| 9 | 111.40 | 24B9 | 20 | 45 | 69 | 45 | 2.02 | 24A9 | 20 | 1.69 |
| 10 | 123.29 | 24B10 | 20 | 52 | 80 | 45 | 2.61 | 24A10 | 20 | 1.88 |
| 11 | 135.23 | 24B11 | 25 | 60 | 90 | 50 | 3.77 | 24A11 | 20 | 2.06 |
| 12 | 147.21 | 24B12 | 25 | 67 | 102 | 50 | 4.77 | 24A12 | 20 | 2.68 |
| 13 | 159.20 | 24B13 | 25 | 76 | 114 | 50 | 5.91 | 24A13 | 20 | 3.06 |
| 14 | 171.22 | 24B14 | 32 | 86 | 127 | 60 | 6.68 | 24A14 | 32 | 3.72 |
| 15 | 183.25 | 24B15 | 32 | 92 | 140 | 60 | 7.49 | 24A15 | 32 | 4.31 |
| 16 | 195.29 | 24B16 | 32 | 92 | 140 | 60 | 9.08 | 24A16 | 32 | 4.86 |
| 17 | 207.35 | 24B17 | 32 | 92 | 140 | 60 | 9.76 | 24A17 | 32 | 5.44 |
| 18 | 219.41 | 24B18 | 32 | 92 | 140 | 60 | 10.49 | 24A18 | 32 | 6.13 |
| 19 | 231.48 | 24B19 | 32 | 92 | 140 | 60 | 11.21 | 24A19 | 32 | 7.03 |
| 20 | 243.55 | 24B20 | 32 | 92 | 140 | 60 | 12.26 | 24A20 | 32 | 7.94 |
| 21 | 255.63 | 24B21 | 32 | 92 | 140 | 60 | 13.38 | 24A21 | 32 | 8.62 |
| 22 | 267.72 | 24B22 | 32 | 92 | 140 | 60 | 13.67 | 24A22 | 32 | 9.76 |
| 23 | 179.80 | 24B23 | 32 | 92 | 140 | 60 | 14.74 | 24A23 | 32 | 10.43 |
| 24 | 291.90 | 24B24 | 32 | 92 | 140 | 60 | 15.48 | 24A24 | 32 | 11.35 |
| 25 | 303.99 | 24B25 | 32 | 92 | 140 | 60 | 16.38 | 24A25 | 32 | 12.47 |
| 26 | 316.09 | 24B26 | 40 | 102 | 150 | 65 | 19.43 | 24A26 | 40 | 13.39 |
| 27 | 328.19 | 24B27 | 40 | 102 | 150 | 65 | 20.39 | 24A27 | 40 | 14.53 |
| 28 | 340.29 | 24B28 | 40 | 102 | 150 | 65 | 21.34 | 24A28 | 40 | 15.89 |
| 29 | 352.39 | 24B29 | 40 | 102 | 150 | 65 | 22.79 | 24A29 | 40 | 17.02 |
| 30 | 364.49 | 24B30 | 40 | 102 | 150 | 65 | 24.25 | 24A30 | 40 | 18.39 |
| 31 | 376.60 | 24B31 | 40 | 102 | 150 | 65 | 26.19 | 24A31 | 40 | 20.02 |
| 32 | 388.71 | 24B32 | 40 | 102 | 150 | 65 | 28.12 | 24A32 | 40 | 21.66 |
| 33 | 400.82 | 24B33 | 40 | 102 | 150 | 65 | 30.05 | 24A33 | 40 | 23.29 |
| 34 | 412.93 | 24B34 | 40 | 102 | 150 | 65 | 31.99 | 24A34 | 40 | 24.93 |
| 35 | 425.04 | 24B35 | 40 | 102 | 150 | 65 | 33.93 | 24A35 | 40 | 26.56 |
| 36 | 437.15 | 24B36 | 40 | 102 | 152 | 65 | 35.86 | 24A36 | 40 | 28.19 |
| 38 | 461.37 | 24B38 | 40 | 102 | 152 | 65 | 39.73 | 24A38 | 40 | 31.46 |
| 42 | 509.83 | 24C42 | 40 | 102 | 152 | 95 | 45.31 | 24A42 | 40 | 40.99 |
| 45 | 546.19 | 24C45 | 40 | 102 | 152 | 95 | 50.71 | 24A45 | 40 | 48.14 |
| 48 | 482.54 | 24C48 | 40 | 102 | 152 | 102 | 57.43 | 24A48 | 40 | 55.29 |
| 57 | 691.62 | 24C57 | 40 | 133 | 178 | 102 | 76.05 | 24A57 | 40 | 76.73 |
| 60 | 727.99 | 24C60 | 40 | 133 | 178 | 102 | 80.05 | 24A60 | 40 | 85.19 |
| 76 | 922.00 | 24C76 | 40 | 133 | 191 | 114 | 129.00 | 24A76 | 40 | 116.00 |

Maximum bores shown will accommodate standard keyseat and setscrew over keyseat. Slightly larger bores are possible with no keyseat, shallow keyseat, or setscrew at angle to keyseat.

Metric Sprockets

Martin

ISO **24B-1**
METRIC **120**

1.50 INCH (38.10mm) PITCH **SIMPLEX**

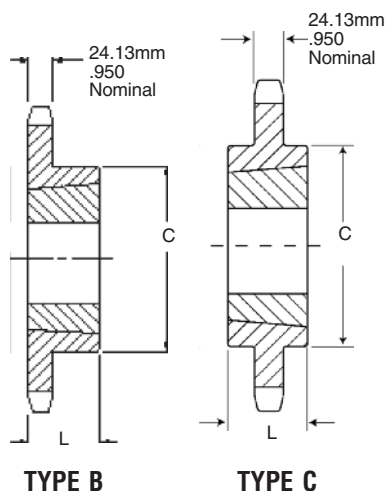

CHAIN DATA:

BS 228/18

ISO 24B-1

PITCH: 38.10mm (1.50 in.)

ROLLER DIAMETER: 25.40mm (1.00 in.)

ROLLER WIDTH: 25.40mm (1.00 in.)

TENSILE: 9980 kilos (22,000 lbs.)

SPROCKETS

Simplex-Taper Bushed — Steel

| No. Teeth | Pitch Diameter | Catalog Number | Bushing Number | Bore Max. | Dimension | | Weight | |
|-----------|----------------|----------------|----------------|-----------|-----------|--------|--------|---------|
| | MM | | | | L | C | Rim | Bushing |
| | | | | MM | MM | MM | Kilos | Kilos |
| 11 | 135.23 | 24BTB11H | 2012 | 50.80 | 31.75 | 90.49 | 2.28 | 0.77 |
| 12 | 147.21 | 24BTB12H | 2012 | 50.80 | 31.75 | 90.49 | 2.49 | 0.77 |
| 13 | 159.20 | 24BTB13H | 2517 | 63.50 | 44.45 | 107.95 | 2.77 | 1.59 |
| 14 | 171.22 | 24BTB14H | 2517 | 63.50 | 44.45 | 107.95 | 3.54 | 1.59 |
| 15 | 183.25 | 24BTB15H | 2517 | 63.50 | 44.45 | 107.95 | 4.31 | 1.59 |
| 16 | 195.29 | 24BTB16H | 3020 | 76.20 | 50.80 | 133.35 | 4.77 | 2.95 |
| 17 | 207.35 | 24BTB17H | 3020 | 76.20 | 50.80 | 133.35 | 5.45 | 2.95 |
| 18 | 219.41 | 24BTB18H | 3020 | 76.20 | 50.80 | 133.35 | 6.13 | 2.95 |
| 19 | 231.48 | 24BTB19H | 3020 | 76.20 | 50.80 | 133.35 | 6.81 | 2.95 |
| 20 | 243.55 | 24BTB20H | 3020 | 76.20 | 50.80 | 133.35 | 7.49 | 2.95 |
| 21 | 255.63 | 24BTB21H | 3020 | 76.20 | 50.80 | 133.35 | 7.94 | 2.95 |
| 22 | 267.72 | 24BTB22H | 3020 | 76.20 | 50.80 | 133.35 | 8.75 | 2.95 |
| 23 | 279.80 | 24BTB23H | 3020 | 76.20 | 50.80 | 133.35 | 9.53 | 2.95 |
| 24 | 291.90 | 24BTB24H | 3020 | 76.20 | 50.80 | 133.35 | 10.67 | 2.95 |
| 25 | 303.99 | 24BTB25H | 3020 | 76.20 | 50.80 | 133.35 | 11.80 | 2.95 |
| 26 | 316.09 | 24BTB26H | 3020 | 76.20 | 50.80 | 133.35 | 12.93 | 2.95 |
| 27 | 328.19 | 24BTB27H | 3020 | 76.20 | 50.80 | 133.35 | 13.50 | 2.95 |
| 28 | 340.29 | 24BTB28H | 3020 | 76.20 | 50.80 | 133.35 | 14.70 | 2.95 |
| 29 | 352.29 | 24BTB29H | 3020 | 76.20 | 50.80 | 133.35 | 14.75 | 2.95 |
| 30 | 364.49 | 24BTB30H | 3020 | 76.20 | 50.80 | 133.35 | 15.20 | 2.95 |
| 32 | 388.71 | 24BTB32 | 3020 | 76.20 | 50.80 | 133.35 | 15.76 | 2.95 |
| 38 | 461.37 | 24CTB38 | 3030 | 76.20 | 76.20 | 139.70 | 24.97 | 4.18 |
| 40 | 485.60 | 24CTB40 | 3030 | 76.20 | 76.20 | 139.70 | 28.46 | 4.18 |
| 42 | 509.83 | 24CTB42 | 3030 | 76.20 | 76.20 | 139.70 | 31.95 | 4.18 |
| 45 | 546.19 | 24CTB45 | 3030 | 76.20 | 76.20 | 139.70 | 37.19 | 4.18 |
| 48 | 582.54 | 24CTB48 | 3030 | 76.20 | 76.20 | 139.70 | 42.43 | 4.18 |
| 50 | 606.78 | 24CTB50 | 3030 | 76.20 | 76.20 | 139.70 | 45.92 | 4.18 |
| 54 | 655.26 | 24CTB54 | 3535 | 88.90 | 88.90 | 165.10 | 63.32 | 6.36 |
| 57 | 691.62 | 24CTB57 | 3535 | 88.90 | 88.90 | 165.10 | 71.46 | 6.36 |
| 60 | 727.99 | 24CTB60 | 3535 | 88.90 | 88.90 | 165.10 | 79.60 | 6.36 |
| 68 | 824.97 | 24CTB68 | 3535 | 88.90 | 88.90 | 165.10 | 101.31 | 6.36 |
| 72 | 873.46 | 24CTB72 | 3535 | 88.90 | 88.90 | 165.10 | 112.17 | 6.36 |
| 76 | 921.96 | 24CTB76 | 3535 | 88.90 | 88.90 | 165.10 | 123.02 | 6.36 |
| 95 | 1152.33 | 24CTB95 | 4040 | 101.60 | 101.60 | 196.85 | 196.67 | 9.98 |
| 96 | 1164.46 | 24CTB96 | 4040 | 101.60 | 101.60 | 196.85 | 201.03 | 9.98 |
| 114 | 1382.72 | 24CTB114 | 4040 | 101.60 | 101.60 | 196.85 | 279.50 | 9.98 |

Sprockets with "H" suffix have hardened teeth.

1.50 INCH (38.10mm) PITCH DUPLEX

ISO **24B-2**
METRIC **120-2**

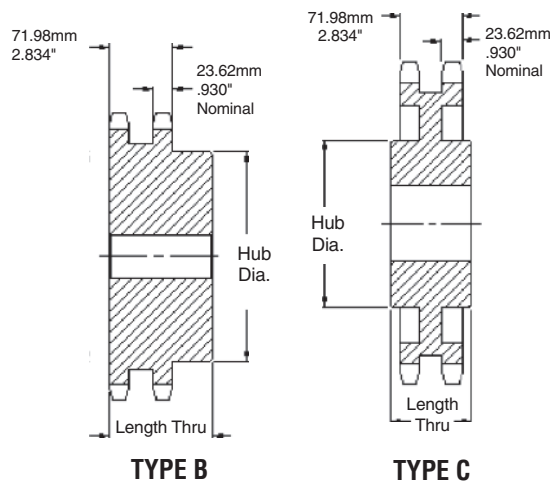

CHAIN DATA:

BS 228/18
ISO 24B-2
PITCH: 38.10mm (1.50 in.)
ROLLER DIAMETER: 25.40mm (1.00 in.)
ROLLER WIDTH: 25.40mm (1.00 in.)
TENSILE: 19,960 kilos (44,000 lbs.)

Duplex-Type B/C — Steel

| No. Teeth | Pitch Diameter | Catalog Number | Bore | | Hub | | Weight (Approx.) Kilos |
|-----------|----------------|----------------|----------|---------|---------|---------|------------------------|
| | MM | | Stock MM | Max. MM | Dia. MM | Thru MM | |
| 11 | 135.23 | D24B11 | 32 | 60 | 90 | 100 | 6.50 |
| 12 | 147.21 | D24B12 | 32 | 67 | 102 | 100 | 8.13 |
| 13 | 159.20 | D24B13 | 32 | 76 | 114 | 100 | 9.92 |
| 14 | 171.22 | D24B14 | 32 | 84 | 128 | 100 | 11.98 |
| 15 | 183.25 | D24B15 | 32 | 93 | 140 | 100 | 14.13 |
| 16 | 195.29 | D24B16 | 32 | 100 | 150 | 100 | 16.35 |
| 17 | 207.35 | D24B17 | 40 | 100 | 150 | 100 | 17.85 |
| 18 | 219.41 | D24B18 | 40 | 108 | 160 | 100 | 20.35 |
| 19 | 231.48 | D24B19 | 40 | 108 | 160 | 100 | 22.56 |
| 20 | 243.55 | D24B20 | 40 | 108 | 160 | 100 | 24.78 |
| 21 | 255.63 | D24B21 | 40 | 108 | 160 | 100 | 26.99 |
| 22 | 267.72 | D24B22 | 40 | 108 | 160 | 102 | 29.74 |
| 23 | 279.80 | D24B23 | 40 | 108 | 160 | 102 | 32.87 |
| 24 | 291.90 | D24B24 | 40 | 108 | 160 | 102 | 36.00 |
| 25 | 303.99 | D24B25 | 40 | 108 | 160 | 102 | 39.13 |
| 26 | 316.09 | D24B26 | 40 | 108 | 160 | 102 | 42.26 |
| 27 | 328.19 | D24B27 | 40 | 108 | 160 | 102 | 45.40 |
| 28 | 340.29 | D24B28 | 40 | 108 | 160 | 102 | 48.53 |
| 29 | 352.39 | D24B29 | 40 | 108 | 160 | 102 | 51.66 |
| 30 | 364.49 | D24B30 | 40 | 108 | 160 | 102 | 54.79 |
| 32 | 388.71 | D24B32 | 40 | 108 | 160 | 102 | 61.05 |
| 38 | 461.37 | D24C38 | 40 | 137 | 190 | 152 | 72.01 |
| 40 | 485.60 | D24C40 | 40 | 137 | 190 | 152 | 75.80 |
| 42 | 509.83 | D24C42 | 40 | 137 | 190 | 152 | 79.59 |
| 45 | 546.19 | D24C45 | 40 | 137 | 190 | 152 | 85.28 |
| 48 | 582.54 | D24C48 | 40 | 137 | 190 | 152 | 90.97 |
| 50 | 606.78 | D24C50 | 40 | 137 | 190 | 152 | 94.76 |
| 54 | 655.26 | D24C54 | 40 | 161 | 238 | 159 | 127.46 |
| 57 | 691.62 | D24C57 | 40 | 161 | 238 | 159 | 140.74 |
| 60 | 727.99 | D24C60 | 40 | 161 | 238 | 159 | 154.02 |
| 68 | 824.97 | D24C68 | 40 | 161 | 238 | 159 | 189.45 |
| 72 | 873.46 | D24C72 | 40 | 161 | 238 | 159 | 207.16 |
| 76 | 921.96 | D24C76 | 40 | 161 | 238 | 159 | 224.87 |
| 95 | 1152.33 | D24C95 | 40 | 161 | 238 | 159 | 309.00 |
| 96 | 1164.46 | D24C96 | 40 | 161 | 238 | 159 | 313.43 |
| 114 | 1382.72 | D24C114 | 40 | 161 | 238 | 159 | 393.13 |

Maximum bores shown will accommodate standard keyseat and setscrew over keyseat. Slightly larger bores are possible with no keyseat, shallow keyseat, or setscrew at angle to keyseat.

Metric Sprockets

Martin

ISO **28B-1**
METRIC **140**

1.75 INCH (44.45mm) PITCH **SIMPLEX**

CHAIN DATA:

BS 228/20

ISO 28B-1

PITCH: 44.45mm (1.75 in.)

ROLLER DIAMETER: 27.94mm (1.10 in.)

ROLLER WIDTH: 30.99mm (1.22 in.)

TENSILE: 13,160 kilos (29,000 lbs.)

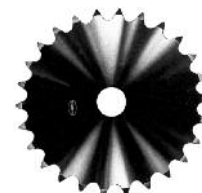

29.44mm
1.159"
Nominal



TYPE A



29.44mm
1.159"
Nominal

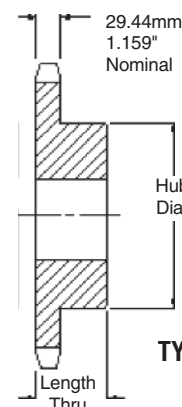

TYPE B

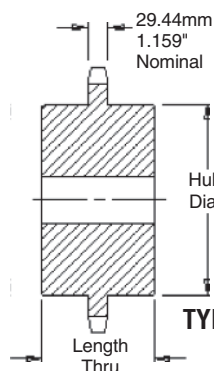

TYPE C

Simplex-Type B/C — Steel

| No. Teeth | Pitch Diameter MM | Catalog Number | Bore | | Hub | | Weight (Approx.) Kilos | Catalog Number | Bore Stock MM | Weight (Approx.) Kilos |
|-----------|----------------------|----------------|-------------|------------|------------|------------|------------------------------|----------------|---------------------|------------------------------|
| | | | Stock MM | Max. MM | Dia. MM | Thru MM | | | | |
| 11 | 157.77 | 28B11 | 40 | 73 | 112 | 70 | 5.27 | 28A11 | 32 | 3.18 |
| 12 | 171.74 | 28B12 | 40 | 84 | 125 | 70 | 6.40 | 28A12 | 32 | 3.95 |
| 13 | 185.74 | 28B13 | 40 | 93 | 140 | 70 | 8.22 | 28A13 | 32 | 4.31 |
| 14 | 199.76 | 28B14 | 40 | 93 | 140 | 60 | 9.13 | 28A14 | 32 | 4.77 |
| 15 | 213.79 | 28B15 | 40 | 108 | 160 | 60 | 11.40 | 28A15 | 40 | 5.45 |
| 16 | 227.84 | 28B16 | 40 | 108 | 160 | 64 | 12.76 | 28A16 | 40 | 6.81 |
| 17 | 241.91 | 28B17 | 40 | 108 | 160 | 64 | 13.65 | 28A17 | 40 | 7.71 |
| 18 | 255.98 | 28B18 | 40 | 108 | 160 | 64 | 13.65 | 28A18 | 40 | 8.63 |
| 19 | 270.06 | 28B19 | 40 | 108 | 160 | 64 | 15.01 | 28A19 | 40 | 9.53 |
| 20 | 284.14 | 28B20 | 40 | 108 | 160 | 64 | 16.84 | 28A20 | 40 | 10.44 |
| 21 | 298.24 | 28B21 | 40 | 108 | 160 | 64 | 18.19 | 28A21 | 40 | 11.79 |
| 22 | 312.34 | 28B22 | 40 | 108 | 160 | 64 | 19.11 | 28A22 | 40 | 13.17 |
| 23 | 326.44 | 28B23 | 40 | 108 | 160 | 64 | 20.46 | 28A23 | 40 | 14.06 |
| 24 | 340.54 | 28B24 | 40 | 108 | 160 | 64 | 21.84 | 28A24 | 40 | 15.44 |
| 25 | 354.65 | 28B25 | 40 | 108 | 160 | 64 | 22.73 | 28A25 | 40 | 16.78 |
| 26 | 368.77 | 28B26 | 40 | 108 | 160 | 64 | 26.83 | 28A26 | 40 | 18.61 |
| 27 | 382.88 | 28B27 | 40 | 108 | 160 | 64 | 27.74 | 28A27 | 40 | 20.43 |
| 28 | 397.00 | 28B28 | 40 | 108 | 160 | 64 | 30.29 | 28A28 | 40 | 20.88 |
| 29 | 411.12 | 28B29 | 40 | 108 | 160 | 64 | 31.74 | 28A29 | 40 | 23.06 |
| 30 | 425.24 | 28B30 | 40 | 108 | 160 | 64 | 32.73 | 28A30 | 40 | 25.17 |
| 32 | 453.49 | 28B32 | 40 | 134 | 180 | 76 | 34.84 | 28A32 | 40 | 31.02 |
| 38 | 538.27 | 28C38 | 40 | 134 | 178 | 102 | 51.25 | 28A38 | 40 | 48.58 |
| 40 | 566.54 | 28C40 | 40 | 134 | 178 | 102 | 52.84 | 28A40 | 40 | 52.80 |
| 42 | 594.81 | 28C42 | 40 | 134 | 178 | 102 | 54.43 | 28A42 | 40 | 57.02 |
| 45 | 637.22 | 28C45 | 40 | 134 | 178 | 102 | 60.55 | 28A45 | 40 | 63.35 |
| 48 | 679.63 | 28C48 | 40 | 134 | 178 | 102 | 62.72 | 28A48 | 40 | 69.68 |
| 54 | 764.47 | 28C54 | 40 | 134 | 178 | 127 | 74.60 | 28A54 | 40 | 82.34 |
| 57 | 806.89 | 28C57 | 40 | 134 | 178 | 127 | 81.77 | 28A57 | 40 | 88.67 |
| 60 | 849.32 | 28C60 | 40 | 134 | 178 | 127 | 88.94 | 28A60 | 40 | 97.97 |
| 68 | 962.47 | 28C68 | 40 | 137 | 191 | 127 | 108.05 | 28A68 | 40 | 122.79 |
| 72 | 1019.04 | 28C72 | 40 | 137 | 191 | 127 | 117.61 | 28A72 | 40 | 135.19 |
| 76 | 1075.62 | 28C76 | 40 | 137 | 191 | 127 | 127.17 | 28A76 | 40 | 147.60 |
| 95 | 1344.39 | 28C95 | 40 | 137 | 191 | 127 | 172.57 | 28A95 | 40 | 206.53 |
| 96 | 1358.53 | 28C96 | 40 | 137 | 191 | 127 | 174.96 | 28A96 | 40 | 209.63 |
| 114 | 1613.18 | 28C114 | 40 | 137 | 191 | 127 | 217.97 | 28A114 | 40 | 265.46 |

Maximum bores shown will accommodate standard keyseat and setscrew over keyseat. Slightly larger bores are possible with no keyseat, shallow keyseat, or setscrew at angle to keyseat.

1.75 INCH (44.45mm) PITCH **SIMPLEX**

ISO **28B-1**
METRIC **140**

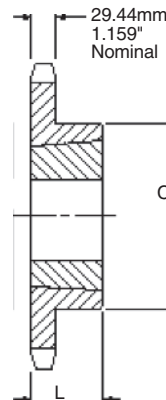

TYPE B

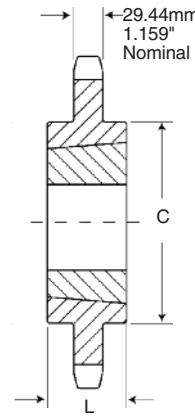

TYPE C

CHAIN DATA:

BS 228/20

ISO 28B-1

PITCH: 44.45mm (1.75 in.)

ROLLER DIAMETER: 27.94mm (1.10 in.)

ROLLER WIDTH: 30.99mm (1.22 in.)

TENSILE: 13,160 kilos (29,000 lbs.)

Simplex-Taper Bushed — Steel

| No. Teeth | Pitch Diameter | Catalog Number | Bushing Number | Bore Max. | Dimension | | Weight | |
|--------------|-------------------|-------------------|-------------------|--------------|-----------|--------|--------|---------|
| | MM | | | | L | C | Rim | Bushing |
| | | | | | MM | MM | Kilos | Kilos |
| 11 | 157.80 | 28BTB11H | 2517 | 63.50 | 44.45 | 107.95 | 3.53 | 1.59 |
| 12 | 170.80 | 28BTB12H | 2517 | 63.50 | 44.45 | 107.95 | 3.86 | 1.59 |
| 13 | 185.80 | 28BTB13H | 3020 | 76.20 | 50.80 | 133.35 | 5.90 | 2.95 |
| 14 | 199.80 | 28BTB14H | 3020 | 76.20 | 50.80 | 133.35 | 7.04 | 2.95 |
| 15 | 213.80 | 28BTB15H | 3020 | 76.20 | 50.80 | 133.35 | 8.17 | 2.95 |
| 16 | 227.90 | 28BTB16H | 3020 | 76.20 | 50.80 | 133.35 | 9.76 | 2.95 |
| 17 | 241.90 | 28BTB17H | 3020 | 76.20 | 50.80 | 133.35 | 11.35 | 2.95 |
| 18 | 256.00 | 28BTB18H | 3020 | 76.20 | 50.80 | 133.35 | 12.49 | 2.95 |
| 19 | 270.10 | 28BTB19H | 3020 | 76.20 | 50.80 | 133.35 | 13.62 | 2.95 |
| 20 | 284.10 | 28BTB20H | 3020 | 76.20 | 50.80 | 133.35 | 14.3 | 2.95 |
| 21 | 298.30 | 28BTB21H | 3020 | 76.20 | 50.80 | 133.35 | 14.98 | 2.95 |
| 22 | 312.30 | 28BTB22H | 3020 | 76.20 | 50.80 | 133.35 | 16.91 | 2.95 |
| 23 | 326.40 | 28BTB23H | 3020 | 76.20 | 50.80 | 133.35 | 18.84 | 2.95 |
| 24 | 340.50 | 28BTB24H | 3020 | 76.20 | 50.80 | 133.35 | 20.77 | 2.95 |
| 25 | 354.70 | 28BTB25H | 3020 | 76.20 | 50.80 | 133.35 | 22.70 | 2.95 |
| 26 | 368.80 | 28BTB26H | 3020 | 76.20 | 50.80 | 133.35 | 24.63 | 2.95 |
| 27 | 382.90 | 28BTB27 | 3020 | 76.20 | 50.80 | 133.35 | 26.56 | 2.95 |
| 28 | 397.00 | 28BTB28 | 3020 | 76.20 | 50.80 | 133.35 | 28.49 | 2.95 |
| 30 | 425.20 | 28BTB30 | 3020 | 76.20 | 50.80 | 133.35 | 32.35 | 2.95 |
| 32 | 453.49 | 28BTB32 | 3020 | 76.20 | 50.80 | 133.35 | 36.21 | 2.95 |
| 38 | 538.30 | 28CTB38 | 3535 | 88.90 | 88.90 | 165.10 | 45.40 | 6.36 |
| 40 | 566.55 | 28CTB40 | 3535 | 88.90 | 88.90 | 165.10 | 47.79 | 6.36 |
| 42 | 594.82 | 28CTB42 | 3535 | 88.90 | 88.90 | 165.10 | 50.18 | 6.36 |
| 45 | 637.21 | 28CTB45 | 4040 | 101.60 | 101.60 | 219.08 | 57.35 | 9.99 |
| 48 | 679.63 | 28CTB48 | 4040 | 101.60 | 101.60 | 219.08 | 61.17 | 9.99 |
| 54 | 764.46 | 28CTB54 | 4040 | 101.60 | 101.60 | 219.08 | 68.82 | 9.99 |
| 57 | 806.90 | 28CTB57 | 4040 | 101.60 | 101.60 | 219.08 | 72.64 | 9.99 |
| 60 | 849.33 | 28CTB60 | 4040 | 101.60 | 101.60 | 219.08 | 76.44 | 9.99 |
| 68 | 962.46 | 28CTB68 | 4040 | 101.60 | 101.60 | 219.08 | 86.63 | 9.99 |
| 72 | 1019.05 | 28CTB72 | 4040 | 101.60 | 101.60 | 219.08 | 91.73 | 9.99 |
| 76 | 1075.60 | 28CTB76 | 4040 | 101.60 | 101.60 | 219.08 | 96.83 | 9.99 |
| 95 | 1344.37 | 28CTB95 | 4040 | 101.60 | 101.60 | 219.08 | 121.03 | 9.99 |
| 96 | 1358.52 | 28CTB96 | 4040 | 101.60 | 101.60 | 219.08 | 122.31 | 9.99 |
| 114 | 1613.18 | 28CTB114 | 4040 | 101.60 | 101.60 | 219.08 | 145.24 | 9.99 |

Metric Sprockets

Martin

ISO **28B-2**
METRIC **140-2**

1.75 INCH (44.45mm) PITCH DUPLEX

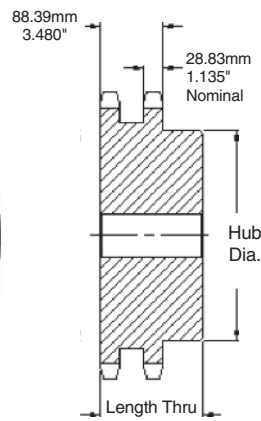

TYPE B

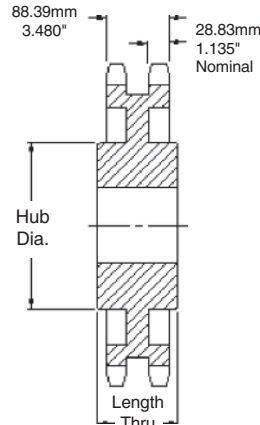

TYPE C

CHAIN DATA:

BS 228/20
ISO 28B-2
PITCH: 44.45mm (1.75 in.)
ROLLER DIAMETER: 27.94mm (1.10 in.)
ROLLER WIDTH: 30.99mm (1.22 in.)
TENSILE: 26,320 kilos (58,000 lbs.)

Duplex-Type B/C — Steel

| No. Teeth | Pitch Diameter | Catalog Number | Bore | | Hub | | Weight (Approx.) |
|-----------|----------------|----------------|-------|------|------|------|------------------|
| | MM | | Stock | Max. | Dia. | Thru | |
| | | | MM | MM | MM | MM | MM |
| 11 | 157.77 | D28B11 | 40 | 73 | 112 | 120 | 10.21 |
| 12 | 171.74 | D28B12 | 40 | 84 | 125 | 120 | 13.02 |
| 13 | 185.74 | D28B13 | 40 | 84 | 130 | 120 | 16.00 |
| 14 | 199.76 | D28B14 | 40 | 87 | 135 | 120 | 19.28 |
| 15 | 213.79 | D28B15 | 40 | 96 | 145 | 120 | 22.91 |
| 16 | 227.84 | D28B16 | 40 | 108 | 160 | 120 | 26.92 |
| 17 | 241.91 | D28B17 | 40 | 114 | 178 | 120 | 30.83 |
| 18 | 255.98 | D28B18 | 40 | 114 | 178 | 120 | 34.74 |
| 19 | 270.06 | D28B19 | 40 | 133 | 178 | 120 | 38.93 |
| 20 | 284.14 | D28B20 | 40 | 133 | 178 | 120 | 44.27 |
| 21 | 298.24 | D28B21 | 40 | 133 | 178 | 120 | 45.08 |
| 22 | 312.34 | D28B22 | 40 | 133 | 178 | 120 | 48.15 |
| 23 | 326.44 | D28B23 | 40 | 133 | 178 | 120 | 51.59 |
| 24 | 340.54 | D28B24 | 40 | 133 | 178 | 120 | 55.03 |
| 25 | 354.65 | D28B25 | 40 | 133 | 178 | 120 | 58.47 |
| 26 | 368.77 | D28B26 | 40 | 133 | 178 | 120 | 64.06 |
| 28 | 397.00 | D28B28 | 40 | 133 | 178 | 120 | 76.05 |
| 30 | 425.24 | D28B30 | 40 | 133 | 178 | 120 | 89.16 |
| 32 | 453.49 | D28B32 | 40 | 133 | 178 | 120 | 103.38 |
| 38 | 537.27 | D28C38 | 40 | 133 | 191 | 159 | 97.53 |
| 40 | 566.54 | D28C40 | 40 | 137 | 191 | 159 | 109.47 |
| 45 | 637.22 | D28C45 | 40 | 137 | 191 | 159 | 137.32 |
| 48 | 679.63 | D28C48 | 40 | 137 | 191 | 159 | 153.61 |
| 54 | 764.47 | D28C54 | 40 | 162 | 241 | 181 | 204.44 |
| 57 | 806.89 | D28C57 | 40 | 162 | 241 | 181 | 210.02 |
| 60 | 849.32 | D28C60 | 40 | 162 | 241 | 181 | 230.82 |
| 68 | 962.47 | D28C68 | 40 | 162 | 241 | 181 | 273.98 |
| 72 | 1019.04 | D28C72 | 40 | 162 | 241 | 181 | 305.70 |
| 76 | 1075.62 | D28C76 | 40 | 162 | 241 | 181 | 323.56 |

Maximum bores shown will accommodate standard keyseat and setscrew over keyseat. Slightly larger bores are possible with no keyseat, shallow keyseat, or setscrew at angle to keyseat.

2.00 INCH (50.80mm) PITCH **SIMPLEX**

ISO **32B-1**
METRIC **160**

CHAIN DATA:

BS 228/22

ISO 32B-1

PITCH: 50.80mm(2.00 in.)

ROLLER DIAMETER: 29.21mm (1.15 in.)

ROLLER WIDTH: 30.99mm (1.22 in.)

TENSILE: 17,240 kilos (38,000 lbs.)

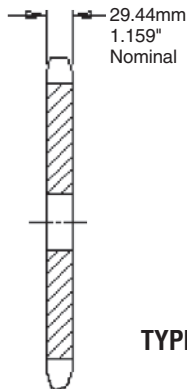

TYPE A

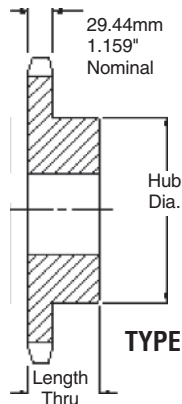

TYPE B

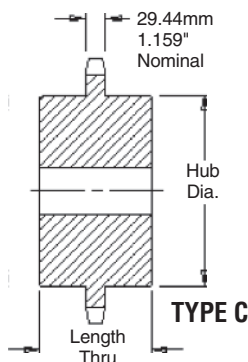

TYPE C

Simplex-Type B/C — Steel

| No. Teeth | Pitch Diameter MM | Catalog Number | Bore | | Hub | | Weight (Approx.) Kilos | Catalog Number | Bore Stock MM | Weight (Approx.) Kilos |
|-----------|----------------------|----------------|-------------|------------|------------|------------|------------------------------|----------------|------------------|------------------------------|
| | | | Stock MM | Max. MM | Dia. MM | Thru MM | | | | |
| 11 | 180.31 | 32B11 | 40 | 83 | 120 | 80 | 9.04 | 32A11 | 32 | 5.00 |
| 12 | 196.28 | 32B12 | 40 | 89 | 133 | 80 | 11.11 | 32A12 | 32 | 6.02 |
| 13 | 212.27 | 32B13 | 40 | 102 | 152 | 70 | 12.61 | 32A13 | 32 | 7.12 |
| 14 | 228.29 | 32B14 | 40 | 102 | 152 | 70 | 14.97 | 32A14 | 32 | 8.32 |
| 15 | 244.33 | 32B15 | 40 | 102 | 178 | 70 | 17.32 | 32A15 | 40 | 9.50 |
| 16 | 260.39 | 32B16 | 40 | 103 | 178 | 70 | 18.78 | 32A16 | 40 | 11.64 |
| 17 | 276.46 | 32B17 | 40 | 103 | 178 | 70 | 20.23 | 32A17 | 40 | 12.35 |
| 18 | 292.55 | 32B18 | 40 | 103 | 178 | 70 | 21.88 | 32A18 | 40 | 13.96 |
| 19 | 308.64 | 32B19 | 40 | 103 | 178 | 70 | 23.53 | 32A19 | 40 | 15.57 |
| 20 | 324.74 | 32B20 | 40 | 133 | 178 | 70 | 25.37 | 32A20 | 40 | 17.36 |
| 21 | 340.84 | 32B21 | 40 | 133 | 178 | 70 | 27.20 | 32A21 | 40 | 19.15 |
| 22 | 356.96 | 32B22 | 40 | 133 | 178 | 70 | 29.23 | 32A22 | 40 | 21.13 |
| 23 | 373.07 | 32B23 | 40 | 133 | 178 | 70 | 31.25 | 32A23 | 40 | 23.10 |
| 24 | 389.19 | 32B24 | 40 | 133 | 178 | 76 | 35.33 | 32A24 | 40 | 25.26 |
| 25 | 405.32 | 32B25 | 40 | 133 | 178 | 76 | 36.80 | 32A25 | 40 | 27.41 |
| 26 | 421.45 | 32B26 | 40 | 133 | 181 | 76 | 39.41 | 32A26 | 40 | 30.25 |
| 27 | 437.58 | 32B27 | 40 | 133 | 181 | 76 | 42.02 | 32A27 | 40 | 33.10 |
| 28 | 453.72 | 32B28 | 40 | 133 | 181 | 76 | 44.62 | 32A28 | 40 | 35.94 |
| 29 | 469.85 | 32B29 | 40 | 133 | 181 | 76 | 47.23 | 32A29 | 40 | 38.78 |
| 30 | 485.99 | 32B30 | 40 | 133 | 181 | 76 | 49.84 | 32A30 | 40 | 41.63 |
| 32 | 518.28 | 32B32 | 40 | 139 | 203 | 76 | 58.02 | 32A32 | 40 | 47.31 |
| 38 | 615.17 | 32C38 | 40 | 139 | 203 | 114 | 86.78 | 32A38 | 40 | 64.37 |
| 40 | 647.47 | 32C40 | 40 | 139 | 203 | 114 | 91.35 | 32A40 | 40 | 72.98 |
| 42 | 679.78 | 32C42 | 40 | 139 | 203 | 114 | 95.91 | 32A42 | 40 | 81.60 |
| 45 | 728.25 | 32C45 | 40 | 139 | 203 | 127 | 116.97 | 32A45 | 40 | 94.52 |
| 48 | 776.72 | 32C48 | 40 | 139 | 203 | 127 | 130.43 | 32A48 | 40 | 107.44 |
| 54 | 873.68 | 32C54 | 40 | 139 | 203 | 127 | 157.34 | 32A54 | 40 | 133.29 |
| 57 | 922.16 | 32C57 | 40 | 139 | 203 | 127 | 170.79 | 32A57 | 40 | 146.21 |
| 60 | 970.65 | 32C60 | 40 | 139 | 203 | 127 | 184.25 | 32A60 | 40 | 164.35 |
| 68 | 1099.96 | 32C68 | 40 | 139 | 203 | 127 | 220.13 | 32A68 | 40 | 212.73 |
| 72 | 1164.62 | 32C72 | 40 | 139 | 203 | 152 | 282.31 | 32A72 | 40 | 236.91 |
| 76 | 1229.28 | 32C76 | 40 | 139 | 203 | 152 | 297.99 | 32A76 | 40 | 261.10 |

Maximum bores shown will accommodate standard keyseat and setscrew over keyseat. Slightly larger bores are possible with no keyseat, shallow keyseat, or setscrew at angle to keyseat.

Metric Sprockets

Martin

ISO **32B-1**
METRIC **160**

2.00 INCH (50.80mm) PITCH SIMPLEX

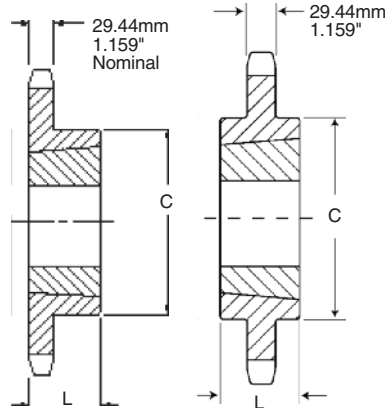

TYPE B

TYPE C

CHAIN DATA:

BS 228/22

ISO 32B-1

PITCH: 50.80mm (2.00 in.)

ROLLER DIAMETER: 29.21mm (1.15 in.)

ROLLER WIDTH: 30.99mm (1.22 in.)

TENSILE: 17,240 kilos (38,000 lbs.)

SPROCKETS

Simplex-Taper Bushed — Steel

| No. Teeth | Pitch Diameter | Catalog Number | Bushing Number | Bore Max. | Dimension | | Weight | |
|-----------|----------------|----------------|----------------|-----------|-----------|--------|--------|---------|
| | MM | | | | L | C | Rim | Bushing |
| | | | | MM | MM | MM | Kilos | Kilos |
| 11 | 180.31 | 32BTB11H | 2517 | 63.50 | 44.45 | 107.95 | 4.51 | 1.59 |
| 12 | 196.28 | 32BTB12H | 3020 | 76.20 | 50.80 | 133.35 | 5.27 | 2.95 |
| 13 | 212.27 | 32BTB13H | 3020 | 76.20 | 50.80 | 133.35 | 6.38 | 2.95 |
| 14 | 228.29 | 32BTB14H | 3020 | 76.20 | 50.80 | 133.35 | 6.87 | 2.95 |
| 15 | 244.33 | 32BTB15H | 3535 | 88.90 | 88.90 | 165.10 | 11.80 | 6.36 |
| 16 | 260.39 | 32BTB16H | 3535 | 88.90 | 88.90 | 165.10 | 13.38 | 6.36 |
| 17 | 276.46 | 32BTB17H | 3535 | 88.90 | 88.90 | 165.10 | 14.98 | 6.36 |
| 18 | 292.55 | 32BTB18H | 3535 | 88.90 | 88.90 | 165.10 | 16.12 | 6.36 |
| 19 | 308.64 | 32BTB19H | 3535 | 88.90 | 88.90 | 165.10 | 17.25 | 6.36 |
| 20 | 324.74 | 32BTB20H | 3535 | 88.90 | 88.90 | 165.10 | 21.10 | 6.36 |
| 21 | 340.84 | 32BTB21H | 3535 | 88.90 | 88.90 | 165.10 | 24.94 | 6.36 |
| 22 | 356.96 | 32BTB22H | 3535 | 88.90 | 88.90 | 165.10 | 27.79 | 6.36 |
| 23 | 373.07 | 32BTB23H | 3535 | 88.90 | 88.90 | 165.10 | 30.64 | 6.36 |
| 24 | 389.19 | 32BTB24H | 3535 | 88.90 | 88.90 | 165.10 | 33.48 | 6.36 |
| 25 | 405.32 | 32BTB25H | 3535 | 88.90 | 88.90 | 165.10 | 36.32 | 6.36 |
| 26 | 421.45 | 32BTB26H | 3535 | 88.90 | 88.90 | 165.10 | 39.16 | 6.36 |
| 27 | 437.58 | 32BTB27 | 3535 | 88.90 | 88.90 | 165.10 | 42.00 | 6.36 |
| 28 | 453.72 | 32BTB28 | 3535 | 88.90 | 88.90 | 165.10 | 44.84 | 6.36 |
| 30 | 486.99 | 32BTB30 | 3535 | 88.90 | 88.90 | 165.10 | 50.52 | 6.36 |
| 32 | 518.28 | 32BTB32 | 3535 | 88.90 | 88.90 | 165.10 | 56.20 | 6.36 |
| 38 | 615.17 | 32CTB38 | 4040 | 101.60 | 101.60 | 219.08 | 68.10 | 10.00 |
| 40 | 647.47 | 32CTB40 | 4040 | 101.60 | 101.60 | 219.08 | 77.08 | 10.00 |
| 45 | 728.25 | 32CTB45 | 4040 | 101.60 | 101.60 | 219.08 | 99.53 | 10.00 |
| 48 | 776.72 | 32CTB48 | 4040 | 101.60 | 101.60 | 219.08 | 113.01 | 10.00 |
| 54 | 873.68 | 32CTB54 | 4040 | 101.60 | 114.30 | 219.08 | 139.95 | 10.00 |
| 57 | 922.16 | 32CTB57 | 4545 | 114.30 | 114.30 | 247.65 | 136.20 | 13.62 |
| 60 | 970.65 | 32CTB60 | 4545 | 114.30 | 114.30 | 247.65 | 158.84 | 13.62 |
| 64 | 1035.30 | 32CTB64 | 4545 | 114.30 | 114.30 | 247.65 | 189.03 | 13.62 |
| 70 | 1132.29 | 32CTB70 | 4545 | 114.30 | 114.30 | 247.65 | 234.32 | 13.62 |

2.00 INCH (50.80mm) PITCH DUPLEX

ISO **32B-2**
METRIC **160-2**

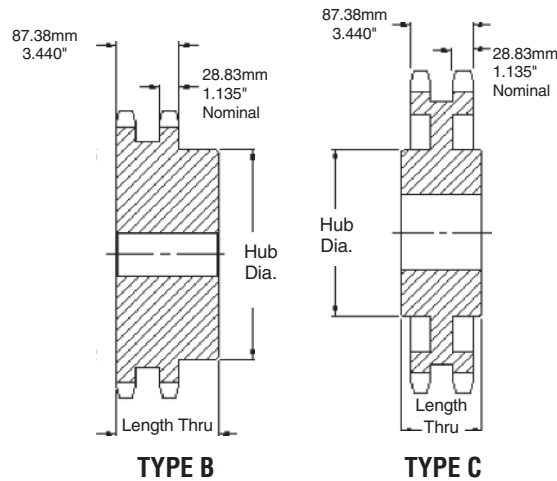

CHAIN DATA:

BS 228/22
ISO 32B-2
PITCH: 50.80mm (2.00 in.)
ROLLER DIAMETER: 29.21mm (1.15 in.)
ROLLER WIDTH: 30.99mm (1.22 in.)
TENSILE: 34,480 kilos (76,000 lbs.)

Duplex-Type B/C — Steel

| No. Teeth | Pitch Diameter MM | Catalog Number | Bore | | Hub | | Weight (Approx.) Kilos |
|-----------|----------------------|----------------|-------------|------------|------------|------------|---------------------------|
| | | | Stock MM | Max. MM | Dia. MM | Thru MM | |
| 11 | 180.31 | D32B11 | 40 | 80 | 125 | 120 | 10.42 |
| 12 | 196.28 | D32B12 | 40 | 89 | 133 | 120 | 16.32 |
| 13 | 212.27 | D32B13 | 40 | 96 | 145 | 120 | 21.77 |
| 14 | 228.29 | D32B14 | 40 | 103 | 155 | 120 | 26.31 |
| 15 | 244.33 | D32B15 | 40 | 106 | 160 | 120 | 30.84 |
| 16 | 260.39 | D32B16 | 40 | 120 | 178 | 120 | 34.02 |
| 17 | 276.46 | D32B17 | 40 | 120 | 178 | 120 | 41.28 |
| 18 | 292.55 | D32B18 | 40 | 120 | 178 | 120 | 43.55 |
| 19 | 308.64 | D32B19 | 40 | 120 | 178 | 120 | 48.53 |
| 20 | 324.74 | D32B20 | 40 | 130 | 191 | 120 | 53.98 |
| 21 | 340.84 | D32B21 | 40 | 130 | 191 | 120 | 58.97 |
| 22 | 356.96 | D32B22 | 40 | 130 | 191 | 120 | 63.96 |
| 23 | 373.07 | D32B23 | 40 | 130 | 191 | 120 | 71.21 |
| 24 | 389.19 | D32B24 | 40 | 130 | 191 | 120 | 77.57 |
| 25 | 405.32 | D32B25 | 40 | 130 | 191 | 120 | 84.82 |
| 26 | 421.45 | D32B26 | 40 | 130 | 191 | 120 | 91.17 |
| 27 | 437.58 | D32B27 | 40 | 130 | 191 | 120 | 97.52 |
| 28 | 453.72 | D32B28 | 40 | 130 | 191 | 120 | 101.13 |
| 30 | 485.99 | D32B30 | 40 | 130 | 191 | 120 | 116.57 |
| 38 | 615.17 | D32B38 | 40 | 178 | 254 | 181 | 170.25 |
| 40 | 647.47 | D32C40 | 40 | 178 | 254 | 181 | 177.46 |
| 45 | 728.25 | D32C45 | 40 | 178 | 254 | 181 | 195.50 |
| 48 | 776.72 | D32C48 | 40 | 178 | 254 | 181 | 204.51 |
| 54 | 873.68 | D32C54 | 40 | 178 | 254 | 181 | 222.53 |
| 57 | 922.16 | D32C57 | 40 | 178 | 254 | 181 | 231.54 |
| 60 | 970.65 | D32C60 | 40 | 178 | 254 | 181 | 255.83 |
| 76 | 1229.28 | D32C76 | 40 | 178 | 254 | 181 | 292.83 |

Maximum bores shown will accommodate standard keyseat and setscrew over keyseat. Slightly larger bores are possible with no keyseat, shallow keyseat, or setscrew at angle to keyseat.